

Street: BLUERIDGE DRIVE X-Street: PEACHTREE PLACE  
OFFICIAL USE ONLY

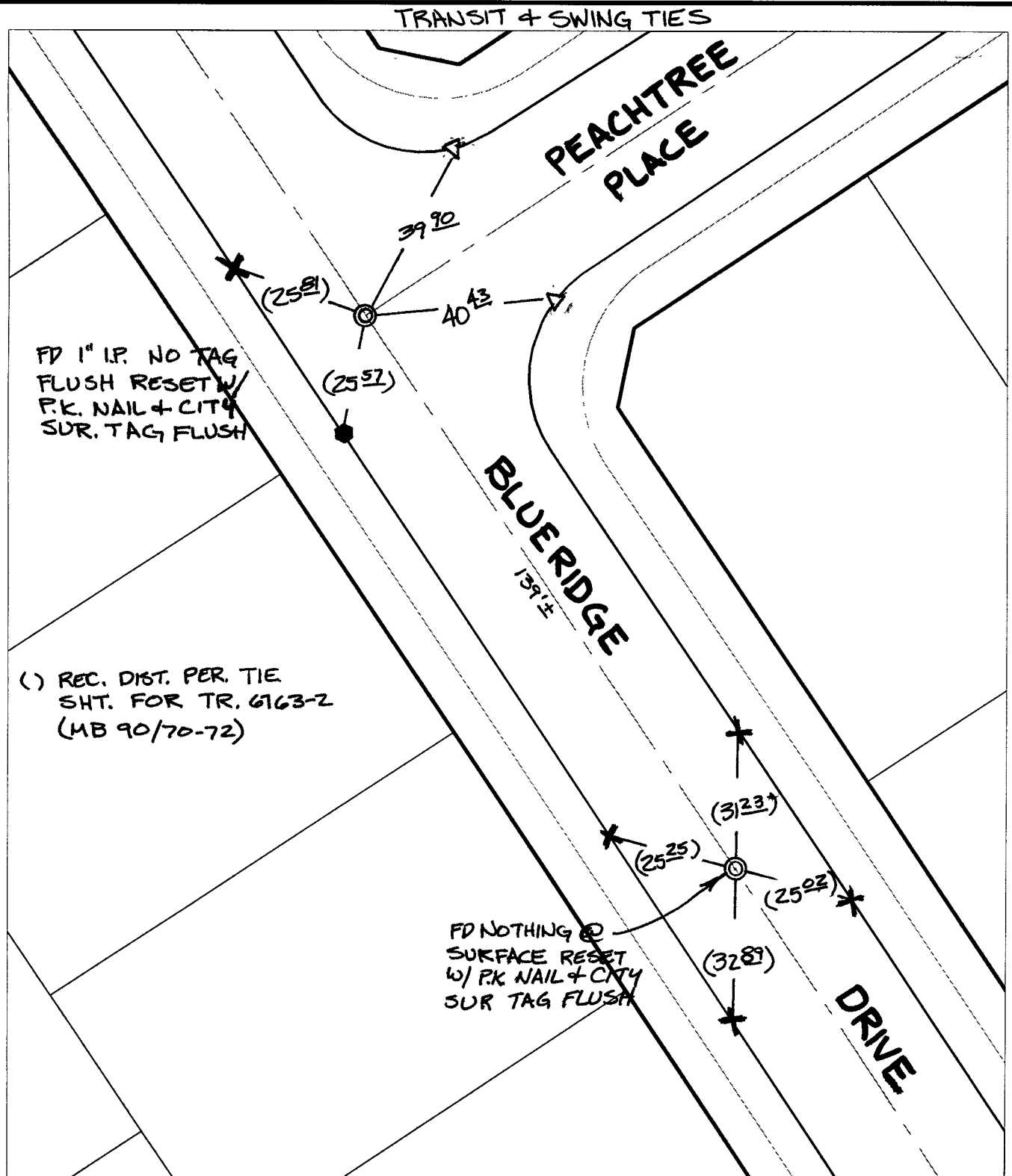

FD 1" I.P. NO TAG  
FLUSH RESET W/  
P.K. NAIL + CITY  
SUR. TAG FLUSH

( ) REC. DIST. PER. TIE  
SHT. FOR TR. 6163-2  
(MB 90/70-72)

FD NOTHING @  
SURFACE RESET  
W/ P.K. NAIL + CITY  
SUR TAG FLUSH

- ✕ FD. Ramset Nail on T/C      ● FD. LD. & TK. on T/C      P.K. and City Engineer tag to be set @ surface after street construction is complete. (If possible)
- FD. "C" Nail on T/C      ○ Set LD. & TK. on T/C

Scale: 1" = 30'

Date: 11/20/04

Drawn by: SURVEY

F.B.:

TR-Sec: T3SR6W-14

**OFFICIAL TIE PLAT**  
CITY OF RIVERSIDE

*These ties are for the purpose of perpetuating the found monumentation. No claim is made as to the relationship of the points or lines shown hereon to true boundary locations.*



Sheet 1 of 1  
Cadme MB: 79-1