

Street:

HINES AVENUE

X-Street:
OFFICIAL USE ONLY

JONES AVENUE

TRANSIT & SWING TIES

HINES AVENUE

JONES AVENUE

AVENUE

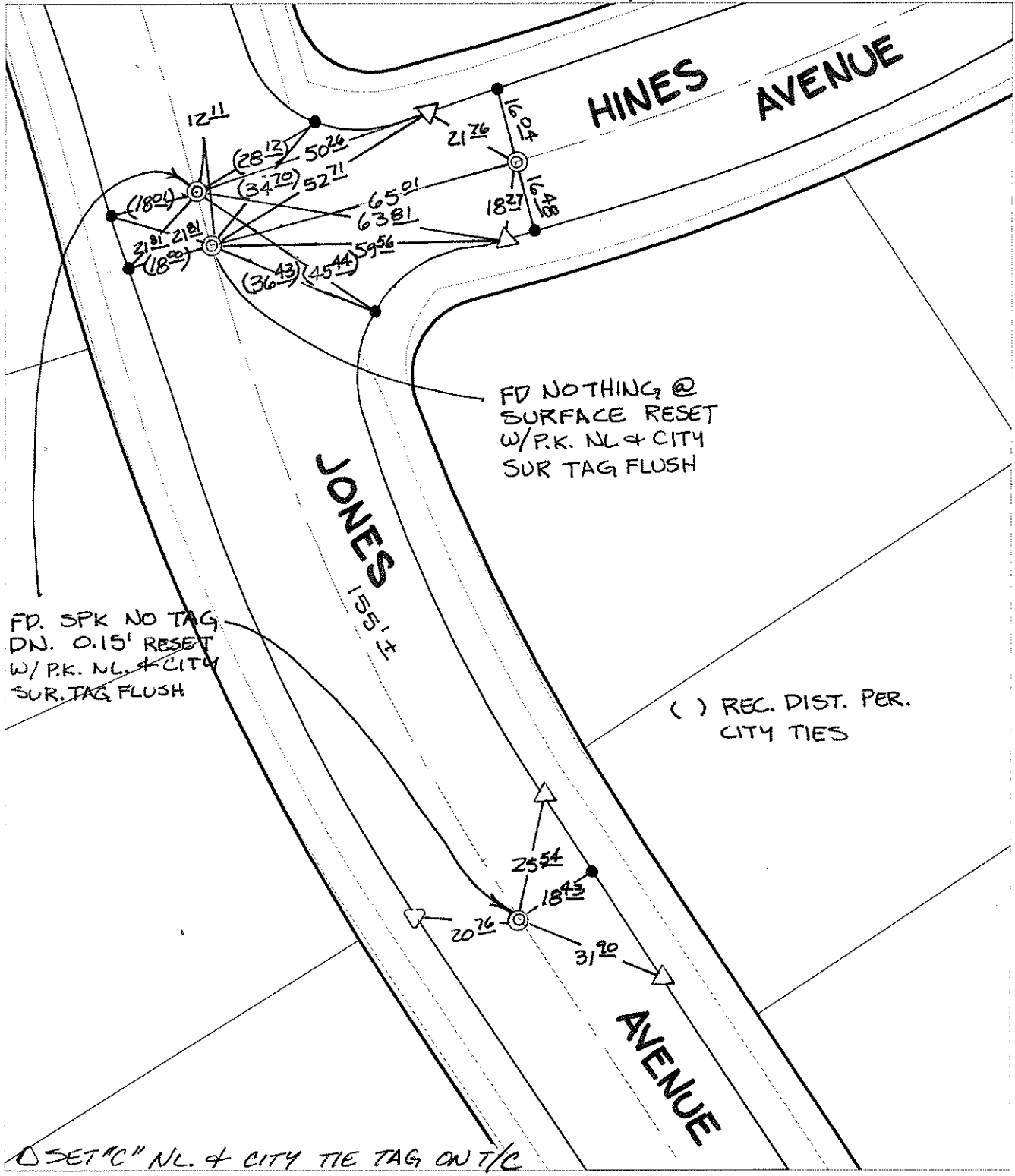

FD. SPK NO TAG
DN. 0.15' RESET
W/P.K. NL & CITY
SUR. TAG FLUSH

FD NOTHING @
SURFACE RESET
W/P.K. NL & CITY
SUR TAG FLUSH

() REC. DIST. PER.
CITY TIES

SET "C" NL. & CITY TIE TAG ON T/C

- ✕ FD. Ramset Nail on T/C
- FD. LD. & TK. on T/C
- FD. "C" Nail on T/C
- Set LD. & TK. on T/C

P.K. and City Engineer tag to be set @
surface after street construction is
complete. (If possible)

Scale: 1" = 30'
 Date: 08/09/05
 Drawn by: SURVEY
 F.B.:
 TR-Sec: T3SR6W-14

OFFICIAL TIE PLAT

CITY OF RIVERSIDE

*These ties are for the purpose of perpetuating the found
 monumentation. No claim is made as to the relationship of
 the points or lines shown hereon to true boundary locations.*



Sheet 1 of 1
 Cadme MB: 64-8