

Street:

PENNY DR.

OFFICIAL USE ONLY

X-Street: E.C.W. OF RUTLAND AVE.

SWING TIES

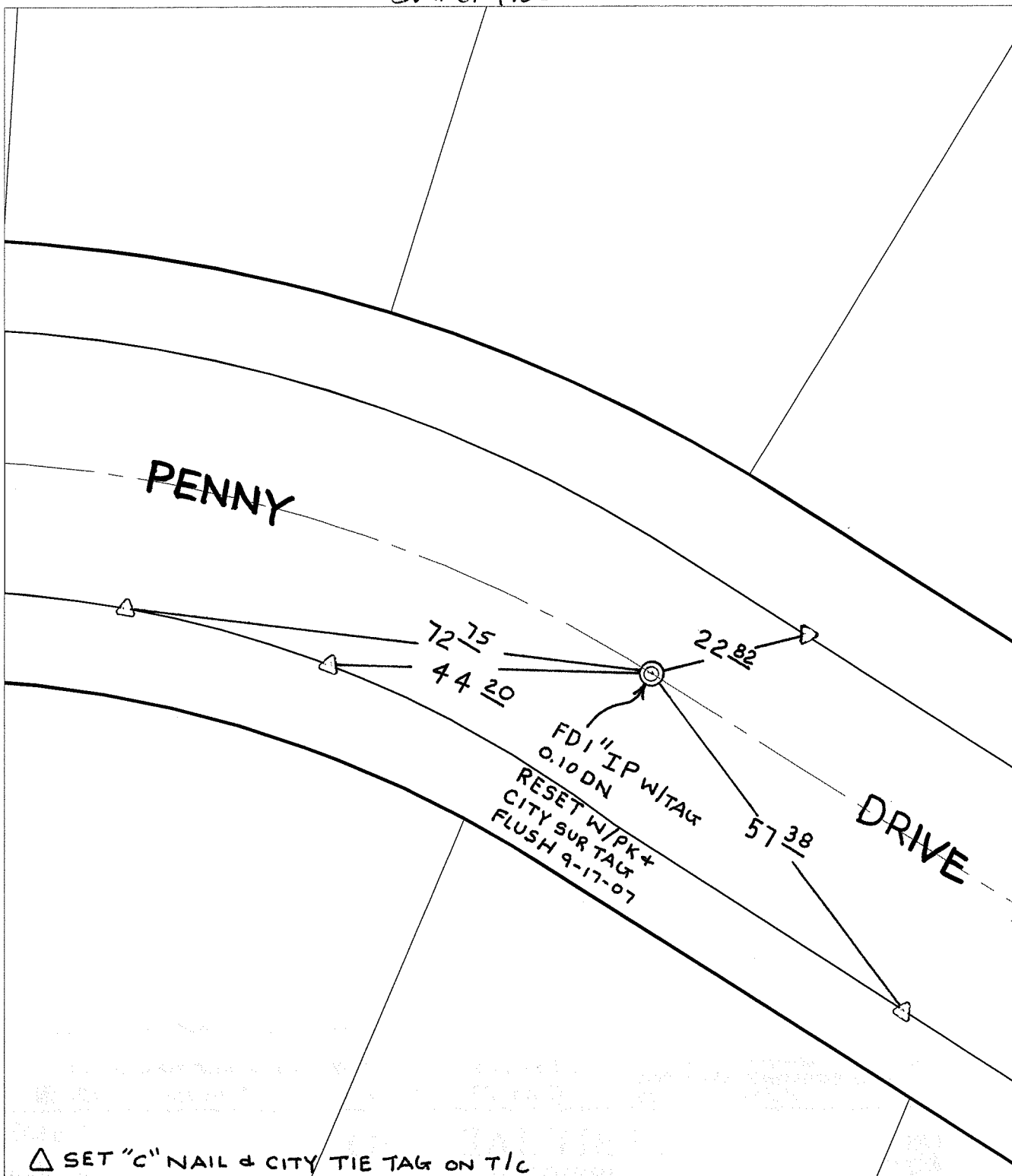

△ SET "C" NAIL & CITY TIE TAG ON T/C

- × FD. Ramset Nail on T/C      ● FD. LD. & TK. on T/C
- FD. "C" Nail on T/C      ○ Set LD. & TK. on T/C

P.K. and City Engineer tag to be set @ surface after street construction is complete. (If possible).

Scale: 1" = 20'

Date: 12/12/06

Drawn by: D. BUENO

F.B.:

TR-Sec: T2SR6W-36

## OFFICIAL TIE PLAT

### CITY OF RIVERSIDE

*These ties are for the purpose of perpetuating the found monumentation. No claim is made as to the relationship of the points or lines shown hereon to true boundary locations.*



Sheet 1 of 1

Cadme MB: 49-4