

Recording Requested By
 and when Recorded Mail to:

City of Riverside
 3900 Main Street
 Riverside, Ca 92522
 Attn: City Surveyor



S	R	U	PAGE	SIZE	DA	MISC	LONG	RFD	COPY
			3						6
M	A	L	465	426	PCOR	NCOR	SMF	NCHG	EXAM 500
							T:	CTY	UNI

CERTIFICATE OF CORRECTION

21

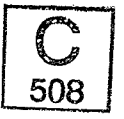

I, Clifford A. Simental, certify that I am a Professional Land Surveyor of the State of California, that Tract Map No. 21709-5 was prepared by Cauty Engineering Group, Inc, and is filed in Book 305, Page(s) 10 through 13, records of Riverside County, State of California, and that the following corrections to said map are made in accordance with Chapter 3, Article 7, Section 66469 through 66472 of the Subdivision Map Act.

I am the substitute Professional Land Surveyor replacing the preparer of the map and assuming responsibility for the placement of final monuments in accordance with Chapter 3, Article 7, Section 66498 of the Subdivision Map Act. I hereby certify that a survey was performed by me under my direction on May 10, 2010, retracing or verifying the information contained on said Map, and that said survey was true, complete and sufficient to enable my placing of monuments of the character and occupying the positions indicated with the following changes.

Incorrect Data:

-Δ- Indicates Set 1/2" Spike and R.C.E. 17550 Tag, Flush unless otherwise noted

Correct Data:

See attached Exhibit 'A', made a part hereof, for the location of the following.

○ Indicates Set 1/2" Spike and washer flush Stamped "LS 5022"



There are no fee owners affected by the correction:

Dated MAY 19, 2010,

Clifford A. Simental
 Clifford A. Simental, PLS 5022

EXHIBIT 'A'

TR 21709-5

MB 305/10-13

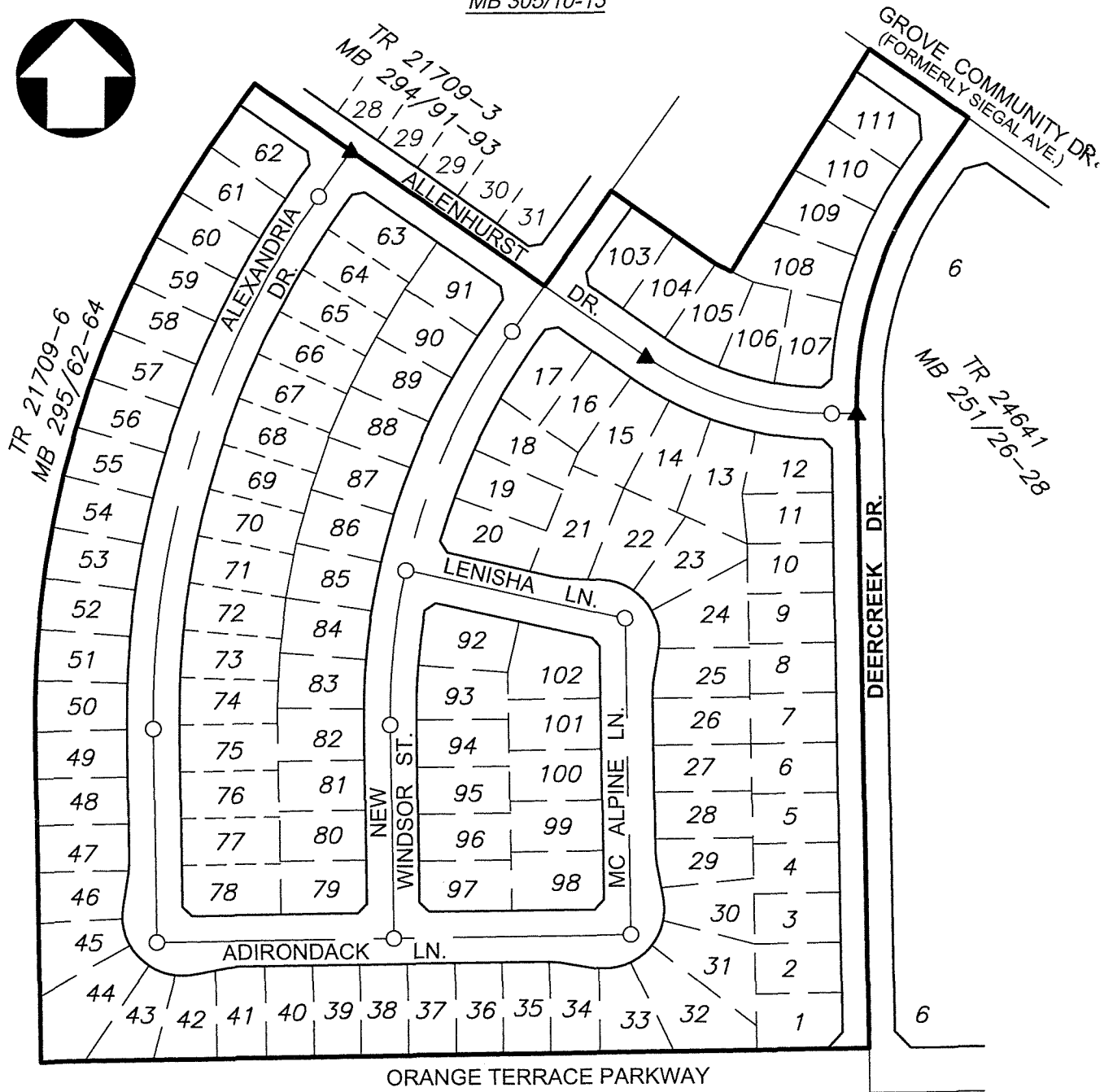

2010-0348030
07/26/2010 08:00A
2 of 3



SURVEYORS' NOTE

- ▲ - INDICATES FOUND 1/2" SPIKE AND R.C.E. 17550 TAG FLUSH
- - INDICATES SET GEAR SPIKE AND WASHER FLUSH STAMPED "LS 5022"

SCALE: 1" = 200'

DATE: 05-18-10

DR. BY: S.M.S.

W.O.: 4RIC030200

CITY OF RIVERSIDE, STATE OF CALIFORNIA -
CERTIFICATE OF CORRECTION - TRACT 21709-5

PREPARED BY:

PSOMAS

2010 Iowa Avenue #101 Riverside, California 92507
(951) 787-8421 www.psomas.com

SHEET

1

OF 1 SHEET

CC-213

CITY SURVEYOR'S CERTIFICATE

This certificate of correction has been examined by the undersigned and such examination disclosed that the only change(s) shown are in conformance with Section 66469 (a) through (f) of the Subdivision Map Act and Title 18 (Subdivision Ordinance) of the City of Riverside Municipal Code.

Dated: 6/16/2010

MARK S. BROWN, City Surveyor
L.S. No. 5655
License Expires 9/30/09

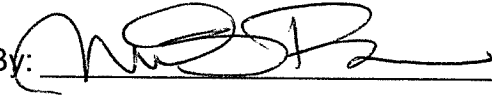
By: 



2010-0348030
07/26/2010 08:00A
3 of 3

CC-213