

2017-0292313

07/18/2017 02:13 PM Fee: \$ 18.00

Page 1 of 2

Recorded in Official Records
County of Riverside
Peter Aldana
Assessor-County Clerk-Recorder



Recording Requested by
and when Recorded Mail to:

City of Riverside
3900 Main Street
Riverside, Ca. 92522
Attn: City Surveyor

113					R	A	Exam: 110		
Page	DA	PCOR	Misc	Long	RFD	1st Pg	Adtl Pg	Cert	CC
2						2	2	1	
SIZE	NCOR	SMF	NCHG T:						

THIS SPACE FOR RECORDER'S USE

34

Certificate of Correction

George Darvasan-Stanciu certifies that I am a Licensed Land Surveyor of the State of California, and that Final Parcel Map No. 36589 was prepared by George Darvasan-Stanciu, PLS No. 7884, and is filed in Book 240, Pages 5 and 6 of Parcel Maps, records of Riverside County, California, and that the following corrections to said map are made by me in accordance with Chapter 3, Article 7, Section 66469 through 66472 of the Subdivision Map Act.

Incorrect Data (Monument Character)

- A) SW Corner Parcel 4 in lieu of 1" IP, LS 7884
- B) SE'LY Angle point for Parcel 4 on Cook Avenue
- C) SW'LY Angle point for Parcel 1 on Cook Avenue
- D) S'LY Angle point for Parcel 1 on Duarte Court

Correct Data (Monument Character)

- Set Lead and Tag LS 7884 in concrete
- Set Lead and Tag LS 7884 in concrete
- Set Lead and Tag LS 7884 in concrete
- Set Lead and Tag LS 7884 a top wall

There are no fee property owners affected by this correction.

Dated: 5/6/2017

By:

Surveyor: George Darvasan-Stanciu
L.S. No. 7884

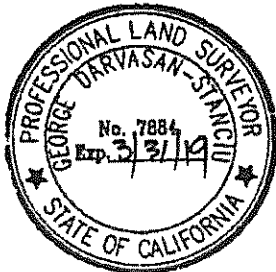

C.C. - 245

City Surveyor's Certificate

This certificate of correction has been examined by the undersigned and such examination disclosed that the only change(s) shown are in conformance with Section 66469 (a) through (f) of the Subdivision Map Act and Title 18 (Subdivision Ordinance) of the City of Riverside Municipal Code.

Dated: 5/15/17

Curtis C. Stephens, City Surveyor
L.S. No. 7519
License Expires 12/31/17



By: 