

When recorded mail to: HARRY WEISS
7045 - Pico Street
RIVERSIDE, CALIF. 92504

229627

RECORDED FOR INDEX
DEC-9-1960
1960

FOR RECORDER'S OFFICE USE ONLY

GRANT DEED

FOR A VALUABLE CONSIDERATION, receipt of which is hereby solemnly acknowledged, the
CITY OF RIVERSIDE, a municipal corporation, hereby GRANTS to GERTRUDE R. WEISS, husband and wife, as joint tenants, and EARL CARWELL and LARA CARWELL, husband and wife, as joint tenants,

the real property in the City of Riverside, County of Riverside, State of California, described as follows:

All that portion of blocks 24 and 25, and of Vacated 1, lots 2 and 3, as shown on Map of Tract No. 2 of the RiverView Addition to the City of Riverside, on file in Book 5, Page 33 of Maps, records of Riverside County, California, particularly described as follows:

COMMENCING at the intersection of the center line of Industrial Avenue with the northerly line of Jurupa Avenue, as shown on said Map;

THENCE North 89° 00' 00" along the northerly line of said Jurupa Avenue 271.3 feet;

THENCE westerly along the northerly line of said Jurupa Avenue to a curve concave to the south, having a radius of 1556 feet, through an angle of 10°, a distance of 100.00 feet;

THENCE westerly along the northerly line of said Jurupa Avenue, to a curve concave to the south, having a radius of 1339.57 feet, through an angle of 109° 00' 00" to a distance of 59.33 feet to a point thereon, said point being the westerly corner of that certain parcel of land conveyed to William Bishop by marriage, and by deed recorded January 13, 1941, in Book 706 499 of Official Records of Riverside County, California;

THENCE south along the east line of said parcel so conveyed to a point on the westerly line of a 50 foot strip conveyed to the Bishop by deed of Walter of America, by deed recorded January 28, 1941, in Book 706 499 of Official Records of Riverside County, California;

THENCE North 89° 00' 00" East and parallel with Fremont Street, as shown on said Map, 50.00 feet to a point on the northerly line of said Jurupa Avenue;

THENCE continuing North 07° East and parallel with said Jurupa Avenue, 250.00 feet to the cross point of beginning;

THENCE South 89° 51' East, 60.20 feet;

THENCE North 89° 07' 12" West, 170.88 feet to a point on a line South 07° 07' West, 160.00 feet from the point of beginning;

THENCE North 07° 07' East, 150.00 feet to the point of beginning.

Area 2.4502 square feet.

Signature and date

C.B. 413

1006

RECEIVED

DEC 9 1960

DEPT. OF PUBLIC WORKS

APPROVED AS TO FORM

Ray White
SENIOR DEPUTY CITY ATTORNEY

CITY OF RIVERSIDE, a Municipal Corporation

Dated December 4 1980

Robert E. Bowers

Mayor
Pro Tempore

Alice A. Hare

Attest City Clerk

STATE OF CALIFORNIA) ss.
COUNTY OF RIVERSIDE)

On this 4th day of December, 1980, before me, Margaret I. Allen, a Notary Public in and for said County and State, personally appeared Robert E. Bowers, Mayor Pro Tempore, and Alice A. Hare, City Clerk of City of Riverside, California, the municipal corporation described in which executed the within instrument, and acknowledged to me that such municipal corporation executed the same.

IN WITNESS WHEREOF, I have hereunto set my hand and affixed my official seal the day and year in the certificate first above written.

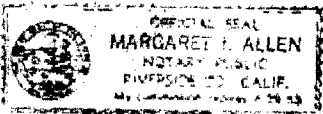

Margaret I. Allen
Notary Public in and for the County of Riverside, State of California

Page 2 of 2

CL 419 (Rev. 3/76)

1000

229627

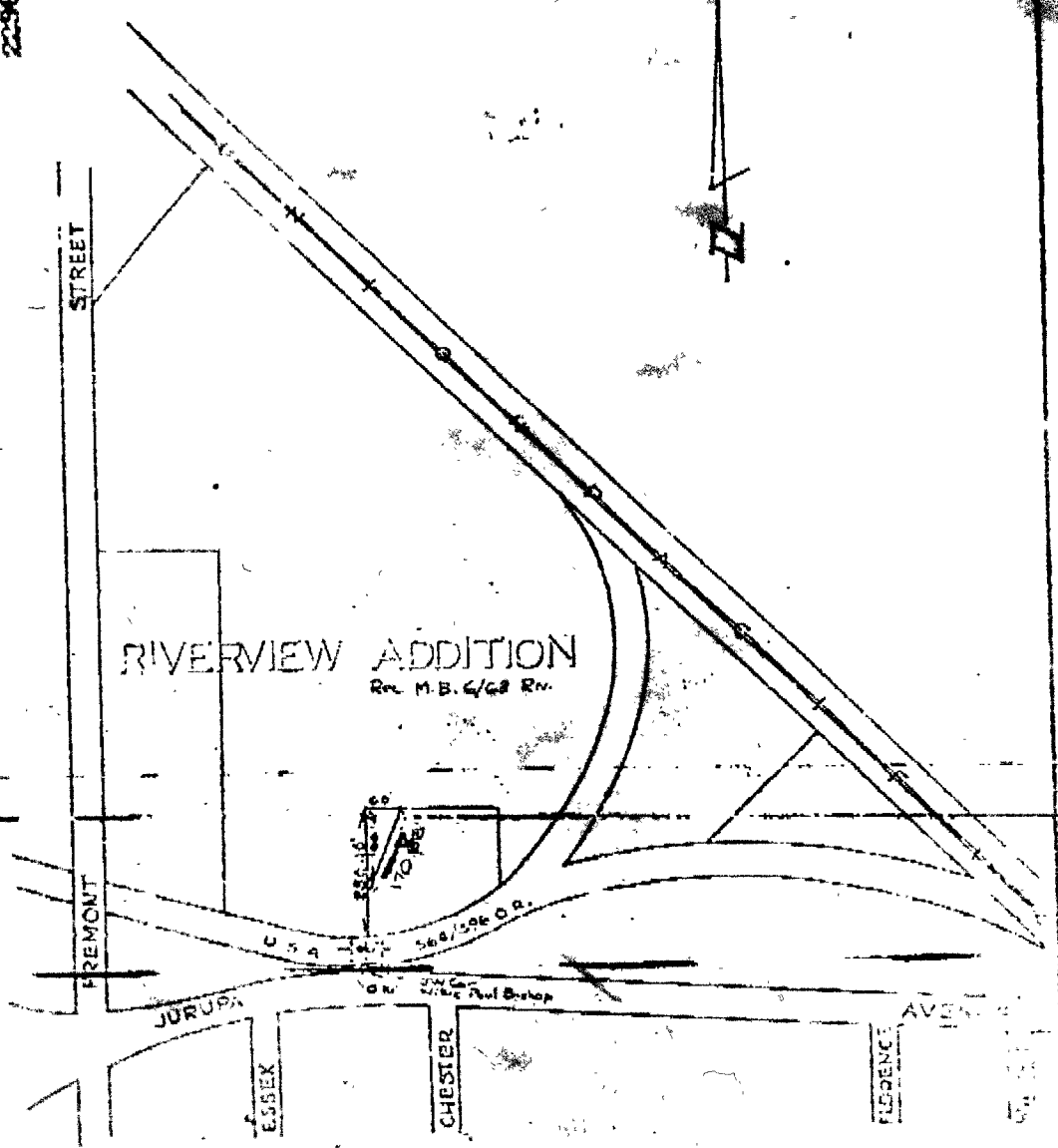

RIVERVIEW ADDITION
 Rev. M.B. 6/68 Rev.

CITY OF RIVERSIDE, CALIFORNIA

PLAT OF PARCEL(S) DESCRIBED
 IN THE ATTACHED DOCUMENT

*This plat is solely an aid in locating the parcel(s) described in the
 attached document. It is not a part of the written description therein.*

SCALE: 1" = 250' DRAWN BY: J.A.P. BY: J.L.P. SUBJECT: 10125 Jurupa Ave. 4/3

END RECORDED DOCUMENT DONALD D. SULLIVAN, COUNTY RECORDER

1006