

WORLD TITLE COMPANY

RECORDING REQUESTED BY

When Recorded Mail To
Department of Transportation
P.O. Box 231
San Bernardino, CA 92402
R. SIMMONS

388788

RECEIVED FOR RECORD
AT 8:00 O'CLOCK

OCT 15 1992

Presented to Office of Recorder
of Recorder of Deeds, California
W. J. [Signature] Recorder
Fees \$

SPACE ABOVE THIS LINE FOR RECORDER'S USE

GRANT DEED
(CORPORATION)

DISTRICT	COUNTY	ROUTE	POST MILE	NUMBER
08	Riv	60	13.3	13124

City of Riverside, a municipal corporation.

520372-43

a corporation organized and existing under and by virtue of the laws of the State of California

does hereby GRANT to the STATE OF CALIFORNIA all that real property in the

County of Riverside, State of California, described as:

(See Exhibit "A")

08-Riv-60-13.3-13124 (13124-1) (Continued)

1036

388788

EXHIBIT "A"

All that land described in a Deed to the City of Riverside recorded March 31, 1992 as Instrument No. 112824 of Official Records in the Office of the County Recorder of Riverside County, California.

DESCRIPTION APPROVAL 9, 4, 92
George P. Hutchinson
SURVEYOR, CITY OF RIVERSIDE

08-Riv-60-13.3-13124 (13124-1)

This real property description has been prepared by me, or under my direction, in conformance with the Professional Land Surveyors Act.

Signature

Michael W. Lofy
Professional Land Surveyor

Date

Sept 1, 1992



388788

EXHIBIT "A"

112824

LEGAL DESCRIPTION FOR DAY STREET ON-RAMP RIGHT-OF-WAY

THOSE PORTIONS OF PARCELS 2, AND 14 THROUGH 21 OF PARCEL MAP 20547, IN THE CITY OF MORENO VALLEY, COUNTY OF RIVERSIDE, STATE OF CALIFORNIA, AS SHOWN ON THE MAP RECORDED IN PARCEL MAP BOOK 140, PAGES 47 THROUGH 51, IN THE OFFICE OF THE COUNTY RECORDER OF SAID COUNTY, DESCRIBED AS FOLLOWS:

BEGINNING AT A POINT IN THE EAST LINE OF SAID PARCEL 14, SAID POINT BEING SOUTH 0°00'14" EAST, 43.00 FEET FROM THE NORTHEAST CORNER OF SAID PARCEL;

THENCE SOUTH 0°00'14" EAST, 123.65 FEET;

THENCE SOUTH 5°42'25" WEST, 100.00 FEET TO THE NORTHEAST CORNER OF PARCEL 15;

THENCE CONTINUING SOUTH 5°42'25" WEST, 50.76 FEET;

THENCE SOUTH 0°50'21" WEST, 381.71 FEET TO A POINT IN THE NORTH RIGHT OF WAY LINE OF STATE HIGHWAY 60 AND THE SOUTHEAST CORNER OF SAID PARCEL 15;

THENCE NORTH 77°47'14" WEST, 483.88 FEET TO THE SOUTHWEST CORNER OF SAID PARCEL 15;

THENCE CONTINUING NORTH 77°47'14" WEST, 129.96 FEET;

THENCE NORTH 79°47'30" WEST, 74.06 FEET TO THE SOUTHWEST CORNER OF PARCEL 16;

THENCE CONTINUING NORTH 79°47'30" WEST, 57.31 FEET TO THE SOUTHEAST CORNER OF PARCEL 18;

THENCE CONTINUING NORTH 79°47'30" WEST, 268.87 FEET;

THENCE NORTH 77°47'14" WEST, 24.53 FEET TO THE SOUTHWEST CORNER OF SAID PARCEL 18;

THENCE CONTINUING NORTH 77°47'14" WEST, 130.00 FEET TO THE SOUTHEAST CORNER OF PARCEL 19;

THENCE CONTINUING NORTH 77°47'14" WEST, 212.18 FEET TO THE SOUTHEAST CORNER OF PARCEL 20;

THENCE CONTINUING NORTH 77°47'14" WEST, 281.76 FEET TO THE SOUTHEAST CORNER OF PARCEL 21;

THENCE CONTINUING NORTH 77°47'14" WEST, 314.51 FEET TO THE SOUTHWEST CORNER OF SAID PARCEL 21;

RECORDER'S MEMO: Legibility of writing, Typing or Printing UNSATISFACTORY in this document when received for Record.

388785

112624

THENCE ALONG THE WEST LINE OF SAID PARCEL NORTH 0°00'39" EAST,
10.23 FEET;

THENCE SOUTH 77°47'14" EAST, 62.82 FEET;

THENCE NORTH 80°45'54" EAST, 15.27 FEET;

THENCE SOUTH 9°34'06" EAST, 6.00 FEET;

THENCE SOUTH 77°47'14" EAST, 235.30 FEET TO A POINT IN THE EAST
LINE OF SAID PARCEL 21;

THENCE CONTINUING SOUTH 77°47'14" EAST, 159.47 FEET;

THENCE SOUTH 78°55'59" EAST, 121.80 FEET TO A POINT IN THE EAST
LINE OF SAID PARCEL 20;

THENCE CONTINUING SOUTH 78°55'59" EAST, 211.32 FEET TO A POINT IN
THE EAST LINE OF SAID PARCEL 19;

THENCE CONTINUING SOUTH 78°55'59" EAST 129.47 FEET TO A POINT IN
THE WEST LINE OF SAID PARCEL 18;

THENCE CONTINUING SOUTH 78°55'59" EAST, 294.05 FEET TO A POINT IN
THE EAST LINE OF SAID PARCEL 18;

THENCE CONTINUING SOUTH 78°55'59" EAST, 42.84 FEET TO THE BEGINNING
OF A NON-TANGENT CURVE CONCAVE TO THE NORTH HAVING A RADIUS OF
2952.06 FEET AND TO WHICH A RADIAL LINE BEARS SOUTH 11°04'02" WEST:

THENCE EASTERLY, 14.63 FEET ALONG SAID CURVE THROUGH A CENTRAL
ANGLE OF 0°17'02" TO A POINT IN THE WEST LINE OF SAID PARCEL 16;

THENCE CONTINUING ALONG SAID CURVE EASTERLY, 149.80 FEET, THROUGH
A CENTRAL ANGLE OF 2°54'27";

THENCE SOUTH 82°07'27" EAST, 52.61 FEET TO A POINT IN THE EAST LINE
OF SAID PARCEL 16;

THENCE CONTINUING SOUTH 82°07'27" EAST, 224.12 FEET;

THENCE SOUTH 84°23'22" EAST, 50.60 FEET TO THE BEGINNING OF A NON-
TANGENT CURVE, CONCAVE TO THE NORTHWEST, HAVING A RADIUS OF 150.00
FEET AND TO WHICH A RADIAL LINE BEARS SOUTH 7°52'33" WEST;

THENCE EASTERLY, NORTH EASTERLY, AND NORTHERLY, 241.30 FEET ALONG
SAID CURVE THROUGH A CENTRAL ANGLE OF 92°10'08";

THENCE ON A NON-TANGENT LINE NORTH 7°58'19" EAST, 50.60 FEET;

THENCE NORTH 5°42'24" EAST, 158.16 FEET TO A POINT IN THE NORTH
LINE OF SAID PARCEL 15;

THENCE CONTINUING NORTH 5°42'24" EAST, 126.12 FEET;

1036

388788

112824

0

THENCE NORTH 0°00'14" WEST, 97.61 FEET;
THENCE NORTH 89°59'46" EAST, 16.00 FEET TO SAID POINT OF BEGINNING.
CONTAINING 1.438 ACRES.

SAID LAND IS MORE PARTICULARLY SHOWN ON EXHIBIT "B" ATTACHED HERETO
AND BY THIS REFERENCE MADE A PART HEREOF.

THIS CONVEYANCE IS MADE FOR THE PURPOSE OF A FREEWAY AND THE
GRANTORS HEREBY RELEASE AND RELINQUISH TO THE GRANTEE ANY AND ALL
ABUTTER'S RIGHTS, INCLUDING ACCESS RIGHTS, APPURTENANT TO GRANTORS
REMAINING PROPERTY, IN AND TO SAID FREEWAY.

Michael David Jones 8-15-90
MICHAEL DAVID JONES, P.L.S. 6173



D00224

DESCRIPTION APPROVAL 1, 2, 91
George P. Hutchinson
SURVEYOR, CITY OF RIVERSIDE

1036

112824

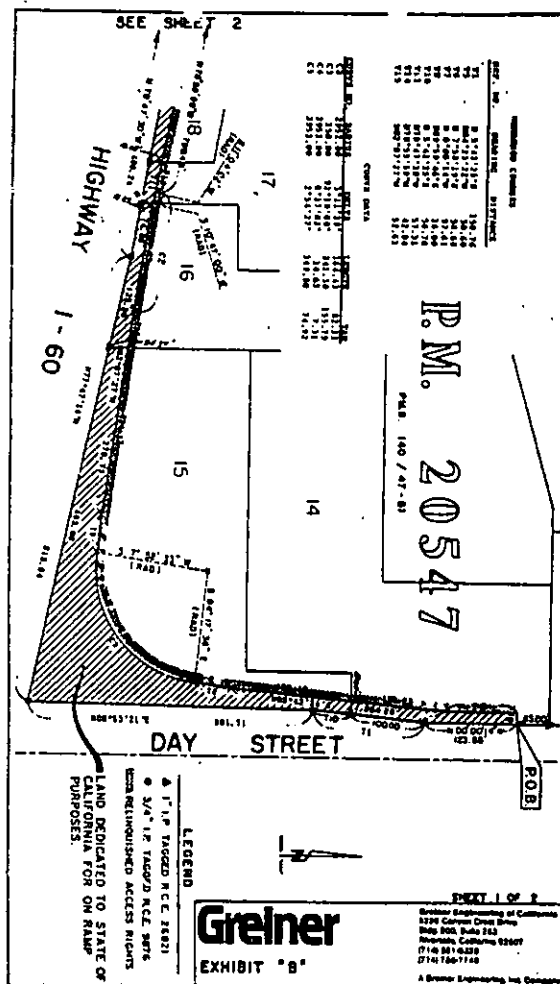

388788

City of Riverside, a Municipal Corporation

By Terry Tezzig Mayor

By Karen E. Ludwig City Clerk

1036

388788

STATE OF CALIFORNIA)
) ss
COUNTY OF RIVERSIDE)

On this 1st day of October, 1992, before me NONA E. CARTWRIGHT, a Notary Public in and for said State, personally appeared TERRY FRIZZEL and KAREN E. LINDQUIST, personally know to me to be the persons who executed this instrument as Mayor and City Clerk of the City of Riverside, a municipal corporation, and acknowledged to me that the municipal corporation executed it.

WITNESS my hand and official seal.

Nona E. Cartwright
Notary Public in and for said State

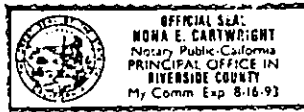

388788

~~APPROVED AS TO FORM--~~
~~CHIEF ASSISTANT CITY ATTORNEY~~

(CERTIFICATE OF ACCEPTANCE, GOVT. CODE, SECTION 27281)

This Is To Certify, That the State of California, grantee herein, acting by and through the Department of Transportation, hereby accepts for public purposes the real property or interest therein, conveyed by the within deed and consents to the recordation thereof.

In Witness Whereof, I have hereunto set my hand this 8th day of October, 19 92

JAMES W. VAN LOBEN SELS
Director of Transportation

By [Signature]
WILLIAM B. DAY Attorney in Fact
Deputy District Director-R/W

CEN 11-1-92

1036