

048169

When recorded mail to:

City Clerk's Office  
City of Riverside  
City Hall, 3900 Main Street  
Riverside, California 92522  
FREE RECORDING  
(Government Code 6103)

RECEIVED FOR RECORD  
AT 8:00 O'CLOCK

FEB - 8 1996

Recorded in Official Records  
of Riverside County, California

Recorder  
Fees \$           

FOR RECORDER'S OFFICE USE ONLY

Project: **Riverside Water Co. Upper Canal**  
**8932 Haskell Street**  
**APN 233-220-002**

DX-1109

QUITCLAIM DEED

FOR VALUABLE CONSIDERATION, receipt of which is hereby acknowledged, the CITY OF RIVERSIDE, a municipal corporation of the State of California, does hereby remise, release, and forever quitclaim to **SHARON THOMPSON, an unmarried woman**, the real property as described in **Exhibit "A"** attached hereto and incorporated herein by this reference, located in the City of Riverside, County of Riverside, State of California.

Dated February 7 1996

CITY OF RIVERSIDE,  
a municipal corporation

By John E. Holmes  
City Manager

Attest Karen E. Lindquist  
City Clerk

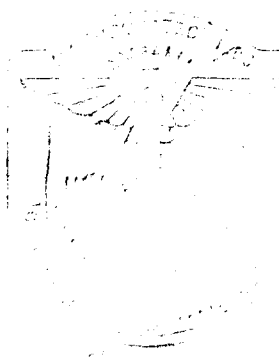

APPROVED AS TO FORM

Stan T. Yamamoto  
Stan T. Yamamoto, City Attorney

GENERAL ACKNOWLEDGEMENT

State of California }  
County of Riverside } ss

On \_\_\_\_\_, before me Janis Lowry  
(date) (name)

a Notary Public in and for said State, personally appeared

John E. Holmes & Karen E. Lundquist  
Name(s) of Signer(s)

personally known to me - OR -  proved to me on the basis of satisfactory evidence to be the person(s) whose name(s) ~~is~~ are subscribed to the within instrument and acknowledged to me that he/she/they executed the same in his/her/their authorized capacity(ies), and that by his/her/their signature(s) on the instrument the person(s), or the entity upon behalf of which the person(s) acted, executed the instrument.

WITNESS my hand and official seal.

Janis Lowry  
Signature

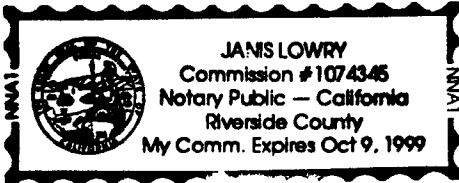

OPTIONAL SECTION

CAPACITY CLAIMED BY SIGNER

- ( ) Attorney-in-fact
- ( ) Corporate Officer(s)

Title \_\_\_\_\_

Title \_\_\_\_\_

- ( ) Guardian/Conservator
- ( ) Individual(s)
- ( ) Trustee(s)
- (X) Other

City Manager & City Clerk

- ( ) Partner(s)
- ( ) General
- ( ) Limited

The party(ies) executing this document ~~is~~ are representing:

City of Riverside  
3960 Main St  
Riverside CA 92502

## EXHIBIT "A"

**Canal Addition to Lot 75 of Amberwood Tract No. 2**

That portion of Parcel 55 the Riverside Water Company Upper Canal right of way, 33.00 feet in width, described in that certain Judgement in Eminent Domain and Final Order of Condemnation action No. 70784, recorded May 23, 1961, in Book 2911, page 299 et seq., Official Records of Riverside County, California, *described as follows:*

**BOUNDED westerly** by the southerly prolongation of the westerly line of Lot 75 of Amberwood Tract No. 2 as shown by map on file in Book 35 of Maps, pages 53 and 54 thereof, records of Riverside County, California and **BOUNDED easterly** by the southerly prolongation of the easterly line of said Lot 75.

Area: 1,950 square feet

*canal.75*

*This description was prepared by me or under my direction in conformance with the requirements of the Land Surveyors Act.*

*Mark S. Brown* *12/26/95* Prep. *WF*  
 Mark S. Brown, L.S. 5655 Date  
 License Expires 9/30/99

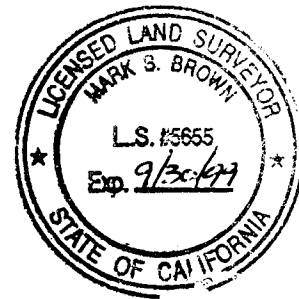

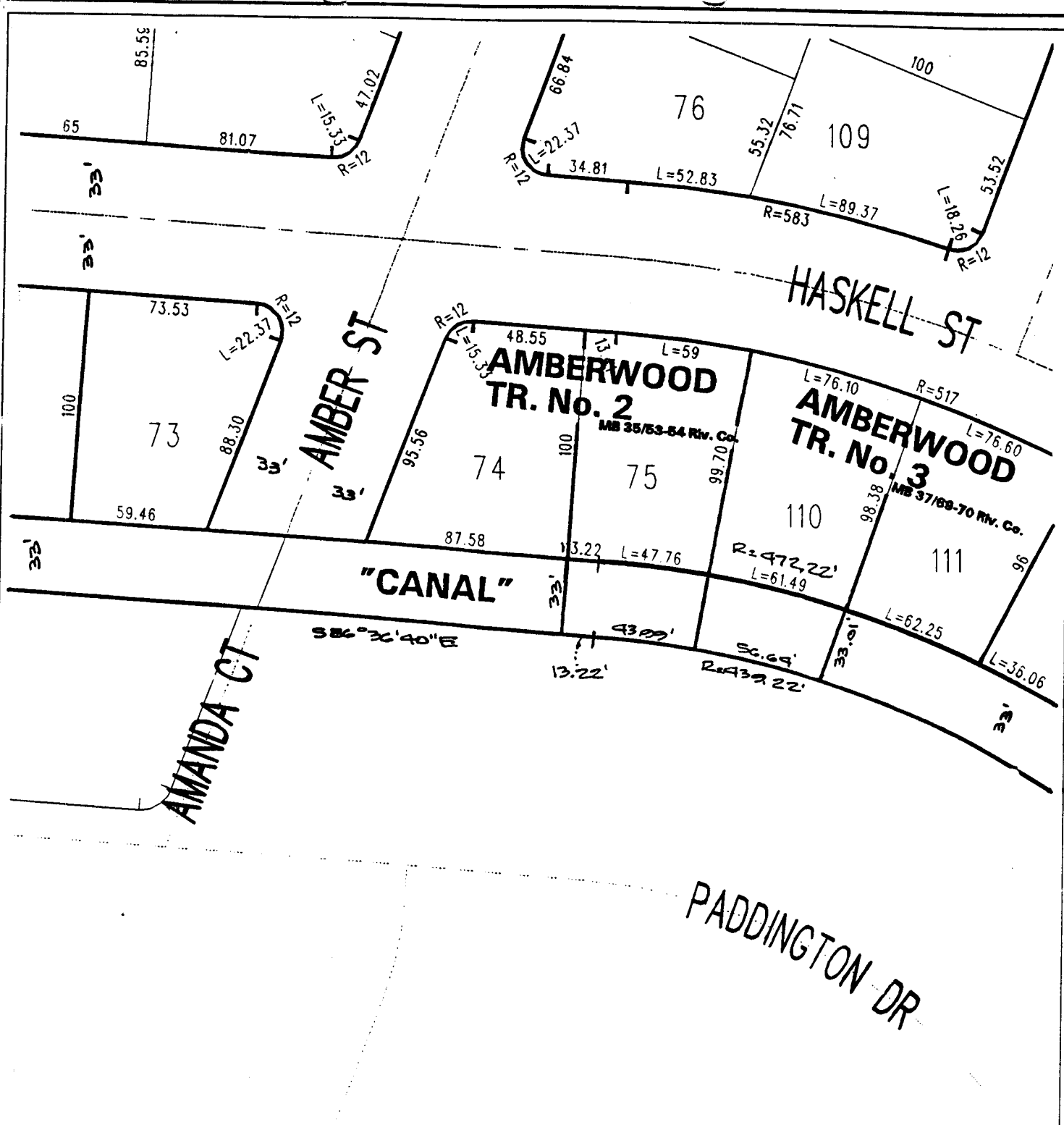

### Riverside Water Co. Upper Canal

- Symbology**
- Parcel Line
  - ROW Line
  - - - Project Limits Boundary
  - ..... Street Centerline
  - ..... Private Street Centerline

66-B  
 Map Produced on:  
 December 13, 1995



1 inch = 60 feet

Aerial photos taken on 4/19/1998. The City of Riverside makes no warranty on the accuracy or content of the data shown on this map. This map shall not be reproduced or distributed. © Copyright 1998, City of Riverside, California

**This plat is solely and aid in locating the PARCEL(S) described in the attached document. It is not a part of the written description therein.**

DX 1109