

OLD REPUBLIC TITLE
COMPANY

When recorded mail to:

SURVEYOR, City of Riverside
City of Riverside
City Hall, 3900 Main Street
Riverside, California 92522

DOC # 2004-0869663

11/02/2004 08:00A Fee:NC
Page 1 of 5 Doc T Tax Paid
Recorded in Official Records
County of Riverside
Gary L. Orso
Assessor, County Clerk & Recorder



M	S	U	PAGE	SIZE	DA	PCOR	NOCOR	SMF	MSC	
	1		5					✓	✓	
A	R	L				COPY	LONG	REFUND	NCHG	EXAM

1910 022 -033
2612005155-55

Project: PW-08
APN: 190-022-033
Address: River Road Parkway

TRA: 009
DTT: 220

FOR RECORDER'S OFFICE USE ONLY

DX - 1332

φ

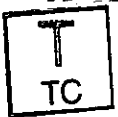

Government agency

GRANT DEED

FOR VALUABLE CONSIDERATION, receipt of which is hereby acknowledged, the CITY OF RIVERSIDE, a municipal corporation of the State of California, as Grantor does hereby grant to CESAR ANDAYA and ESMIREYDA ANDAYA, husband and wife as joint tenants, the real property as described in EXHIBIT A attached hereto and incorporated herein by this reference, located in the City of Riverside, County of Riverside, State of California.

Dated September 10, 2004

CITY OF RIVERSIDE,
a municipal corporation

APPROVAL
CITY ATTORNEY'S OFFICE

BY [Signature]
Deputy City Attorney

By [Signature]
City Manager
Pro Tempore

Attest [Signature]
City Clerk



DX 1332

GENERAL ACKNOWLEDGEMENT

State of California

County of Riverside

} ss

On September 10, 2004 before me Cheryl Balz
(date) (name)

a Notary Public in and for said State, personally appeared

Michael J. Beck
Name(s) of Signer(s)

personally known to me - OR - proved to me on the basis of satisfactory evidence to be the person(s) whose name(s) is/are subscribed to the within instrument and acknowledged to me that he/she/they executed the same in his/her/their authorized capacity(ies), and that by his/her/their signature(s) on the instrument the person(s), or the entity upon behalf of which the person(s) acted, executed the instrument.

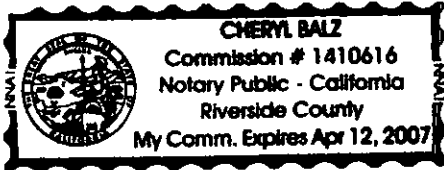

WITNESS my hand and official seal.

[Signature]
Signature

OPTIONAL SECTION

CAPACITY CLAIMED BY SIGNER

() Attorney-in-fact
() Corporate Officer(s)
Title _____
Title _____

() Guardian/Conservator
() Individual(s)
() Trustee(s)
() Other

() Partner(s)
() General
() Limited

The party(ies) executing this document is/are representing:

CALIFORNIA ALL-PURPOSE ACKNOWLEDGMENT

State of California
County of Riverside } ss.

On ^{CB} September 13, 2004 before me, Cheryl Balz, Notary Public
Date Name and Title of Officer (e.g., "Jane Doe, Notary Public")
personally appeared Colleen J. Nicol
Name(s) of Signer(s)

personally known to me
 proved to me on the basis of satisfactory evidence

to be the person(s) whose name(s) is/are subscribed to the within instrument and acknowledged to me that he/she/they executed the same in his/her/their authorized capacity(ies), and that by his/her/their signature(s) on the instrument the person(s), or the entity upon behalf of which the person(s) acted, executed the instrument.

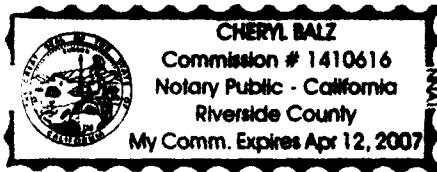

WITNESS my hand and official seal.

[Handwritten Signature]
Signature of Notary Public

Place Notary Seal Above

OPTIONAL

Though the information below is not required by law, it may prove valuable to persons relying on the document and could prevent fraudulent removal and reattachment of this form to another document.

Description of Attached Document

Title or Type of Document: grant deed w/ Cesar and Esmireyda Andaya
Document Date: 9-10-04 Number of Pages: 2

Signer(s) Other Than Named Above: _____

Capacity(ies) Claimed by Signer

- Signer's Name: _____
- Individual
 - Corporate Officer — Title(s): _____
 - Partner — Limited General
 - Attorney in Fact
 - Trustee
 - Guardian or Conservator
 - Other: _____

Signer Is Representing: _____



DX1332-3

EXHIBIT A
Project: PW-08



THAT CERTAIN REAL PROPERTY IN THE CITY OF RIVERSIDE, COUNTY OF RIVERSIDE, STATE OF CALIFORNIA DESCRIBED AS FOLLOWS:

LOTS 5 AND 6 OF BLOCK 27, AS SHOWN ON MAP OF RIVERVIEW ADDITION TRACT NO. 1, ON FILE IN BOOK 6, PAGE 38 OF MAPS, RECORDS OF RIVERSIDE COUNTY, CALIFORNIA.

EXCEPTING THEREFROM THE SOUTHERLY 8.00 FEET OF SAID LOTS 5 AND 6 AND THE WESTERLY 8.00 FEET OF SAID LOT 6.

This description was prepared by me or under my direction in conformance with the requirements of the Land Surveyors Act.

Mark S. Brown, L.S. 5655
License Expires 9/30/05

 Date
Prep. 



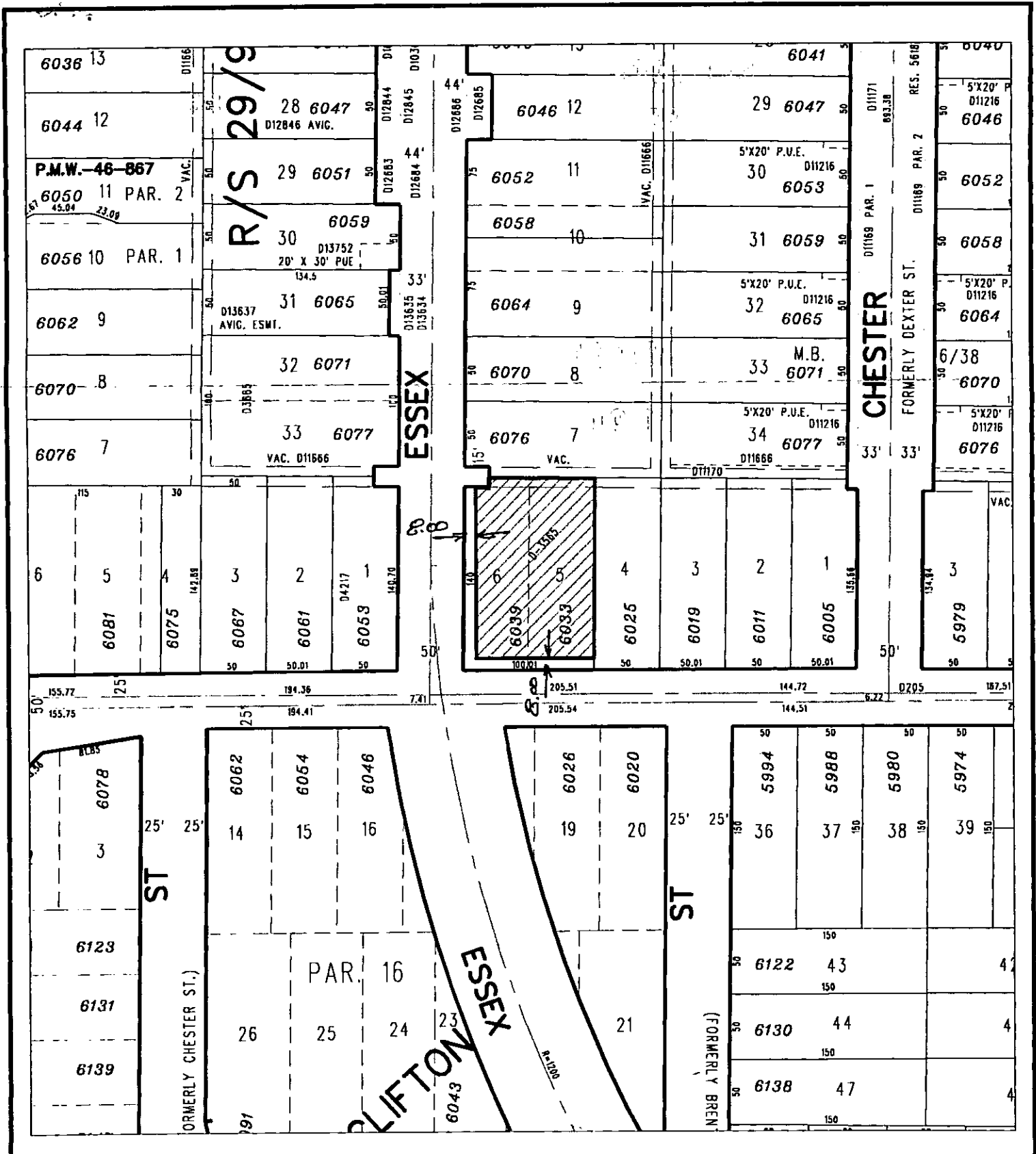

◆ CITY OF RIVERSIDE, CALIFORNIA ◆

36-8

THIS PLAT IS SOLELY AN AID IN LOCATING THE PARCEL(S) DESCRIBED IN THE ATTACHED DOCUMENT. IT IS NOT A PART OF THE WRITTEN DESCRIPTION THEREIN.

Sheet 1 of 1



Scale: 1" = 100'

Drawn by: BW

Date: 08/25/04

Subject: PW-08 River Road Parkway

DX133Z