

When recorded mail to:

Surveyor's Office
Public Works Department
City of Riverside
City Hall, 3900 Main Street
Riverside, California 92522

DOC # 2011-0563200

12/20/2011 03:30P Fee:NC

Page 1 of 6

Recorded in Official Records

County of Riverside

Larry W. Ward

Assessor, County Clerk & Recorder

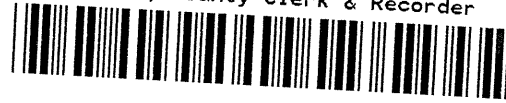

S	R	U	PAGE	SIZE	DA	MISC	LONG	RFD	COPY
			4						8
M	A	L	465	426	PCOR	NCOR	SMF	NCHG	EXAM
nchg-ok 65						T:	CTY	UNI	517 8

FOR RECORDER'S OFFICE USE ONLY

NOTE TO COUNTY RECORDER:

DO NOT ACCEPT FOR RECORDING IF AN ADDITIONAL COVER SHEET IS ATTACHED.



Project: 6250 Valley Springs Pkwy.
Sewer Esmt. Quitclaim
A.P.N. 291-460-026

DX - 1608

QUITCLAIM DEED

The CITY OF RIVERSIDE, a California charter city and municipal corporation, does hereby remise, release, and forever quitclaim to **WAL-MART STORES, INC.,** a Delaware corporation, that certain easement located in the City of Riverside, County of Riverside, State of California, described in Exhibit "A", attached hereto and incorporated herein by this reference.

Dated October 27, 2011

CITY OF RIVERSIDE,
a California charter city and municipal corporation

By *Thomas J. Boyd*
Thomas J. Boyd,
Interim Public Works Director

Attest *Sherry Morton-Ellis*
~~Colleen J. Nicol, City Clerk~~
Sherry Morton-Ellis, Assistant City Clerk

APPROVED AS TO FORM
[Signature]
DEPUTY CITY ATTORNEY

State of California

County of Riverside } ss

On October 29, 2011, before me, Lorena Verduco,

notary public, personally appeared, Thomas J. Boyd

who proved to me on the basis of satisfactory evidence to be the person(s) whose name(s) is/are subscribed to the within instrument and acknowledged to me that he/she/they executed the same in his/her/their authorized capacity(ies), and that by his/her/their signature(s) on the instrument the person(s), or the entity upon behalf of which the person(s) acted, executed the instrument.

I certify under PENALTY OF PERJURY under the laws of the State of California that the foregoing paragraph is true and correct.

WITNESS my hand and official seal.

Lorena Verduco
Notary Signature



6250 VALLEY SPRINGS PKWY WAL-MART OCD.DOC



2011-0563200
12/26/2011 03:39P
2 of 6

CALIFORNIA ALL-PURPOSE ACKNOWLEDGMENT

State of California

County of Riverside

On October 27, 2011 before me, LORENA VERDUSCO, Notary Public

personally appeared Sherry Marton-Ellis

who proved to me on the basis of satisfactory evidence to be the person(s) whose name(s) ~~is~~ are subscribed to the within instrument and acknowledged to me that he/she/they executed the same in his/her/their authorized capacity(ies), and that by his/her/their signature(s) on the instrument the person(s), or the entity upon behalf of which the person(s) acted, executed the instrument.



I certify under PENALTY OF PERJURY under the laws of the State of California that the foregoing paragraph is true and correct.

WITNESS my hand and official seal.

Signature Lorena Verdusco
Signature of Notary Public

Place Notary Seal Above

OPTIONAL

Though the information below is not required by law, it may prove valuable to persons relying on the document and could prevent fraudulent removal and reattachment of this form to another document.

Description of Attached Document

Title or Type of Document: Quitclaim Deed DX-1608 APN: 291-460-026

Document Date: October 27, 2011 Number of Pages: _____

Signer(s) Other Than Named Above: Thomas J. Boyd

Capacity(ies) Claimed by Signer(s)

Signer's Name: _____

- Individual
- Corporate Officer — Title(s): _____
- Partner — Limited General
- Attorney in Fact
- Trustee
- Guardian or Conservator
- Other: _____

Signer Is Representing: _____

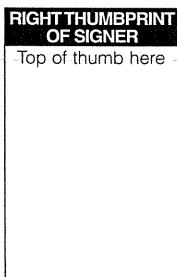

Signer's Name: _____

- Individual
- Corporate Officer — Title(s): _____
- Partner — Limited General
- Attorney in Fact
- Trustee
- Guardian or Conservator
- Other: _____

Signer Is Representing: _____

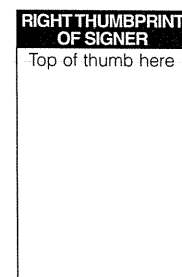

EXHIBIT "A"

SEWER EASEMENT QUIT CLAIM

ALL THAT PORTION OF THAT CERTAIN EASEMENT, 20.00 FEET IN WIDTH, DEDICATED TO THE CITY OF RIVERSIDE FOR THE CONSTRUCTION AND MAINTENANCE OF SANITARY SEWER FACILITIES, AS SHOWN ON SHEET 8 OF 11 SHEETS OF PARCEL MAP NO. 31387, SITUATED IN THE CITY OF RIVERSIDE, COUNTY OF RIVERSIDE, STATE OF CALIFORNIA, RECORDED ON OCTOBER 21, 2005 IN PARCEL MAP BOOK 214, PAGES 82 THROUGH 92, INCLUSIVE, IN THE OFFICE OF THE COUNTY RECORDER OF RIVERSIDE COUNTY, LYING WITHIN PARCEL 6 OF SAID PARCEL MAP NO. 31387 AND EASTERLY OF THE FOLLOWING DESCRIBED LINE:

COMMENCING AT THE MOST NORTHEASTERLY CORNER OF SAID EASEMENT, LYING WITHIN SAID PARCEL 8;

THENCE WESTERLY ALONG THE NORTHERLY LINE OF SAID EASEMENT SOUTH 79°20'25" WEST 48.16 FEET TO THE TRUE POINT OF BEGINNING OF THE HEREIN DESCRIBED LINE, SAID LINE LYING WITHIN SAID PARCEL 6;

THENCE SOUTH 53°02'36" EAST 27.08 FEET TO A POINT OF INTERSECTION WITH THE SOUTHERLY LINE OF SAID EASEMENT AND THE POINT OF TERMINATION OF THIS LINE DESCRIPTION.

AREA = 590 SQ. FT. / 0.014 OF AN ACRE, MORE OR LESS

DESCRIPTION APPROVAL:

BY: K. Strout 10/20/2011
K. STROUT DATE
FOR: MARK S. BROWN
CITY SURVEYOR



NOTE:

THIS PLAT IS SOLELY AN AID IN LOCATING THE PARCELS(S) DESCRIBED IN THE ATTACHED DOCUMENT. IT IS NOT PART OF THE WRITTEN DESCRIPTION THEREIN.

CERT. OF COMPLIANCE
1992-162744, O.R.

MWD FEE
PARCEL

EXISTING 20.00' EASEMENT TO THE CITY OF RIVERSIDE FOR SANITARY SEWER CONSTRUCTION AND MAINTENANCE PURPOSES GRANTED PER PARCEL MAP 31387, P.M.B. 214/82-92

N10°39'35"W
20.00'

PARCEL 8

APN: 291-600-070

S79°20'25"W 719.37'
671.21'

673.96'
N79°20'25"E 703.87'

SEE DETAIL SHEET 2

PORTION OF EXISTING
EASEMENT TO REMAIN

S03°46'45"W 386.89'
N03°46'45"E 371.39'

PM 31387
PMB 214/82-92
PARCEL 6
APN: 291-460-026

S86°13'15"E 20.00'

CORPORATE CENTER PLACE

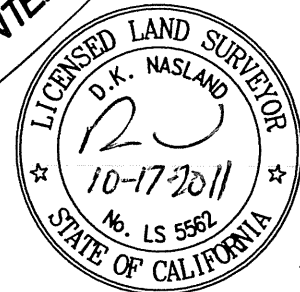

SCALE: 1" = 150'



SCALE 1" = 150'

SECTION 3, TOWNSHIP 3 SOUTH, RANGE 4 WEST, S.B.M.



NASLAND ENGINEERING

CIVIL ENGINEERING • SURVEYING • LAND PLANNING
4740 Ruffner Street, San Diego, California, 92111 • 858-292-7770

A SIZE	sewer vac ded DWG NO.	309-006.1 NE JOB NO.	2 REV
1" = 150' SCALE	SEWER EASEMENT & QUITCLAIM		1 OF 2 SHEET



2011-0563200
12/20/2011 03:38P

DX1608

BASIS OF BEARINGS

THE BASIS OF BEARINGS FOR THE SURVEY IS THE NORTHERLY LINE OF SEWER EASEMENT GRANTED TO CITY OF RIVERSIDE PER PM 31387 TAKEN AS NORTH 79°20'25" EAST

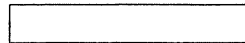

LEGEND

EXISTING EASEMENT TO REMAIN



SEWER EASEMENT GRANTED



QUITCLAIM OF SEWER EASEMENT

SURVEYOR'S STATEMENT

PREPARED UNDER MY DIRECTION

[Signature] 10-17-2011
 DK NASLAND, LS 5562 DATE

PORTION OF EXISTING 20.00' EASEMENT WITHIN PARCEL 6 EASEMENT TO THE CITY OF RIVERSIDE FOR SANITARY SEWER CONSTRUCTION AND MAINTENANCE PURPOSES GRANTED PER PARCEL MAP 31387, P.M.B. 214/82-92, TO REMAIN

PORTION OF EXISTING EASEMENT WITHIN PARCEL 6 QUITCLAIMED=±590 SQ. FT.

P.O.C.

PORTION OF EXISTING EASEMENT WITHIN PARCEL 8 QUITCLAIMED=±190 SQ. FT.

PARCEL 8

APN: 291-600-070

PM 31387
PMB 214/82-92

EASEMENT DEDICATED TO THE CITY OF RIVERSIDE FOR THE CONSTRUCTION AND MAINTENANCE OF SANITARY SEWER FACILITIES
 AREA=1,047 SQ. FT., 0.024 ACRES

PARCEL 6

APN: 291-460-026

DETAIL
 NOT TO SCALE



SCALE: 1"=150'

NASLAND ENGINEERING
 CIVIL ENGINEERING • SURVEYING • LAND PLANNING
 4740 Ruffner Street, San Diego, California, 92111 • 858-292-7770

A SIZE	sewer vac ded DWG NO.	309-006.1 NE JOB NO.	1 REV
N/A SCALE	SEWER EASEMENT & QUITCLAIM		2 OF 2 SHEET



DX1608