

CALIFORNIA TITLE COMPANY

When recorded mail to:

Hua Holding LLC
Attn: Giang Nguyen
8136 Wagon Wheel
Rosemead CA 91770

DOC # 2012-0452193
09/21/2012 01:45 PM Fees: \$24.00
Page 1 of 4 Doc T Tax Paid
Recorded in Official Records
County of Riverside
Larry W. Ward
Assessor, County Clerk & Recorder

**This document was electronically submitted
to the County of Riverside for recording**
Received by: YSEGURA

FOR RECORDER'S OFFICE USE ONLY

Project: 1865/75 University Ave
APNs: 211-182-016, 017
TRA#009-063
DTT \$607.20

DX- 1619

GRANT DEED

FOR VALUABLE CONSIDERATION, receipt of which is hereby acknowledged, the CITY OF RIVERSIDE, a California charter city and municipal corporation, AS SUCCESSOR AGENCY TO THE REDEVELOPMENT AGENCY OF THE CITY OF RIVERSIDE, as Grantor, does hereby grant to HUA HOLDING LLC, a California limited liability company, the real property as described in Exhibit "A" attached hereto and incorporated herein by this reference, located in the City of Riverside, County of Riverside, State of California.

Dated: June 18, 2012

CITY OF RIVERSIDE, a California charter city and municipal corporation, AS SUCCESSOR AGENCY TO THE REDEVELOPMENT AGENCY OF THE CITY OF RIVERSIDE

By: 
Deanna Lorson, Assistant City Manager for Scott C. Barber, City Manager acting on behalf of the Successor Agency to the Redevelopment Agency of the City of Riverside

Approved as to form:

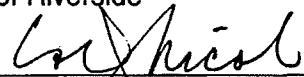
Attest: 
City Clerk, as Secretary to the Successor Agency to the Redevelopment Agency the City of the City of Riverside

Successor Agency General Counsel

EXHIBIT "A"

APN: 211-182-016 &017
FEE SIMPLE INTEREST

That certain real property in the City of Riverside, County of Riverside, State of California described as follows:

Lots 20 and 21 of Alta Mesa Tract on file in Book 7 of Maps at Page 30 thereof, Records of Riverside County, California;

EXCEPTING THEREFROM the Northerly 5.00 feet of said Lots 20 and 21.

This description was prepared by me or under my direction in conformance with the requirements of the Land Surveyors Act.

Curtis C. Stephens 9/21/12 Prep. E.V.
Curtis C. Stephens, L.S. 7519 Date



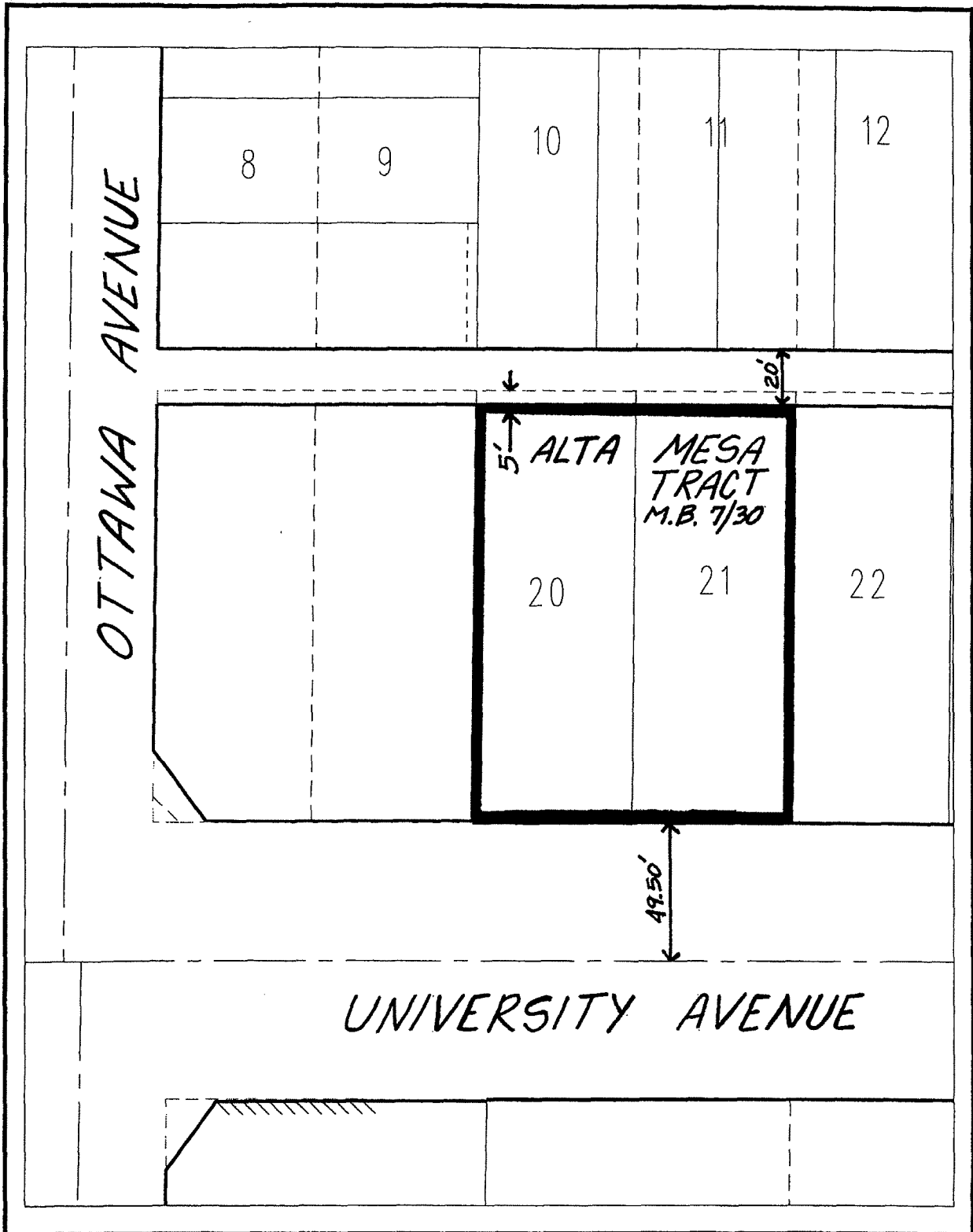

◆ CITY OF RIVERSIDE, CALIFORNIA ◆

THIS PLAT IS SOLELY AN AID IN LOCATING THE PARCEL(S) DESCRIBED IN THE ATTACHED DOCUMENT. IT IS NOT A PART OF THE WRITTEN DESCRIPTION THEREIN.

Sheet 1 of 1



Scale: 1" = 50'

Drawn by: EVEGA

Date: 05/08/12

Subject: LL-P11-0757

DX1019