

ASSIGN  
"DEED OUT"  
NUMBER

Recorded mail to:  
D. P. Ladd  
Ladd Development Co.  
6272 Van Buren Blvd.  
Riverside, Calif.  
CITY DEED NO.  
Central Ave. Extension

EXEMPTARY STATES AND TERRITORIES

The real property hereby described is in the City of Riverside

144020

QUITCLAIM DEED

FOR A VALUABLE CONSIDERATION, receipt of which is hereby acknowledged, the CITY OF RIVERSIDE, a municipal corporation, does hereby remise, release, and forever quitclaim to OWNERS OF RECORD, as their individual interest appears,

the real property in the City of Riverside, County of Riverside, State of California, described as follows:

Please record on behalf of and for the benefit of the City of Riverside, 10726-72  
J. M. Rice, Property Services Mgr.

That portion of THE SOUTHEAST QUARTER OF THE NORTHWEST QUARTER OF SECTION 32, T.2S., R.4W., S.B.M., as shown by United States Government Survey, described as follows:

Beginning at the most westerly corner of that certain parcel of land conveyed as Parcel No. 1 to the City of Riverside, a municipal corporation, by a deed recorded May 22, 1964, as Instrument No. 62850 of Official Records of Riverside County, California; said corner also being in the centerline of a 55 foot wide easement, for ingress and egress, as conveyed to the City of Riverside as Parcel No. 2 by said deed recorded May 22, 1964, Instrument No. 62850;

Thence South 69° 43' 39" East (bearing South 69° 43' 39" East), along said centerline, 207.53 feet;

Thence South 20° 16' 21" West, 27.50 feet to a line which is parallel with and distant 27.50 feet southwest as measured at right angles to said centerline;

Thence North 69° 43' 39" West, along said parallel line, 138.20 feet to the beginning of a tangent curve concave to the southwest and having a radius of 1,945.00 feet; said curve is concentric with a curve having a radius of 1,945.00 feet to said centerline;

Thence northwest, along said curve, an arc length of 154.77 feet thru a central angle of 5° 45' 41" to a point on the centerline of that certain parcel of land conveyed to the City of Riverside, a municipal corporation, by a deed recorded January 15, 1972, as Instrument No. 11,330 of Official Records of Riverside County; said point also being the location of a non-tangent curve concave to the southwest and having a radius of 1,945.00 feet; the initial radial line of said curve, having a radius of 1,945.00 feet, bears North 1° 22' 37" East;

Thence easterly, along said south line, an arc length of 154.77 feet thru a central angle of 5° 26' 35" to a line which is parallel with and distant 27.50 feet northeast as measured at right angles to said centerline;

Thence South 69° 43' 39" East, along last mentioned parallel line, 138.20 feet to the westerly line of said Parcel No. 1.

144020

Thence South 20° 16' 21" West, 27.50 feet to the point of beginning.

DESCRIPTION APPROVAL  
By [Signature] on 10/25/77

CITY OF RIVERSIDE  
CORPORATION

Dated October 24 19 77

[Signature]  
City Clerk

CL 304-448 (Rev. 11/68)

APPROVED  
[Signature]

RECORDED'S OFFICE - Liability of notary  
Typing or Printing QUALITY FACTORY  
in this document when recorded Fee \$2.00

144020

STATE OF CALIFORNIA )  
COUNTY OF RIVERSIDE ) ss

On this 25th day of October 19 77, before  
Barbara A. Whitmore a Notary Public in and for said County and State,  
personally appeared BEN H. LEWIS, Mayor, and VIRGINIA J. STONORCK, City Clerk  
of the City of Riverside, California, the municipal corporation described in  
and which executed the within instrument, and acknowledged to me that said  
municipal corporation executed the same.

IN WITNESS WHEREOF I have hereunto set my hand and affixed my  
official seal the day and year in this certificate first above written.

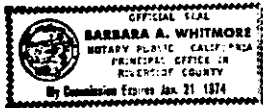

[Signature]  
Notary Public in and for the State of California  
Riverside, State of California

24000

SE 1/4 NW 1/4 SEC 32  
T2S R4W SBM

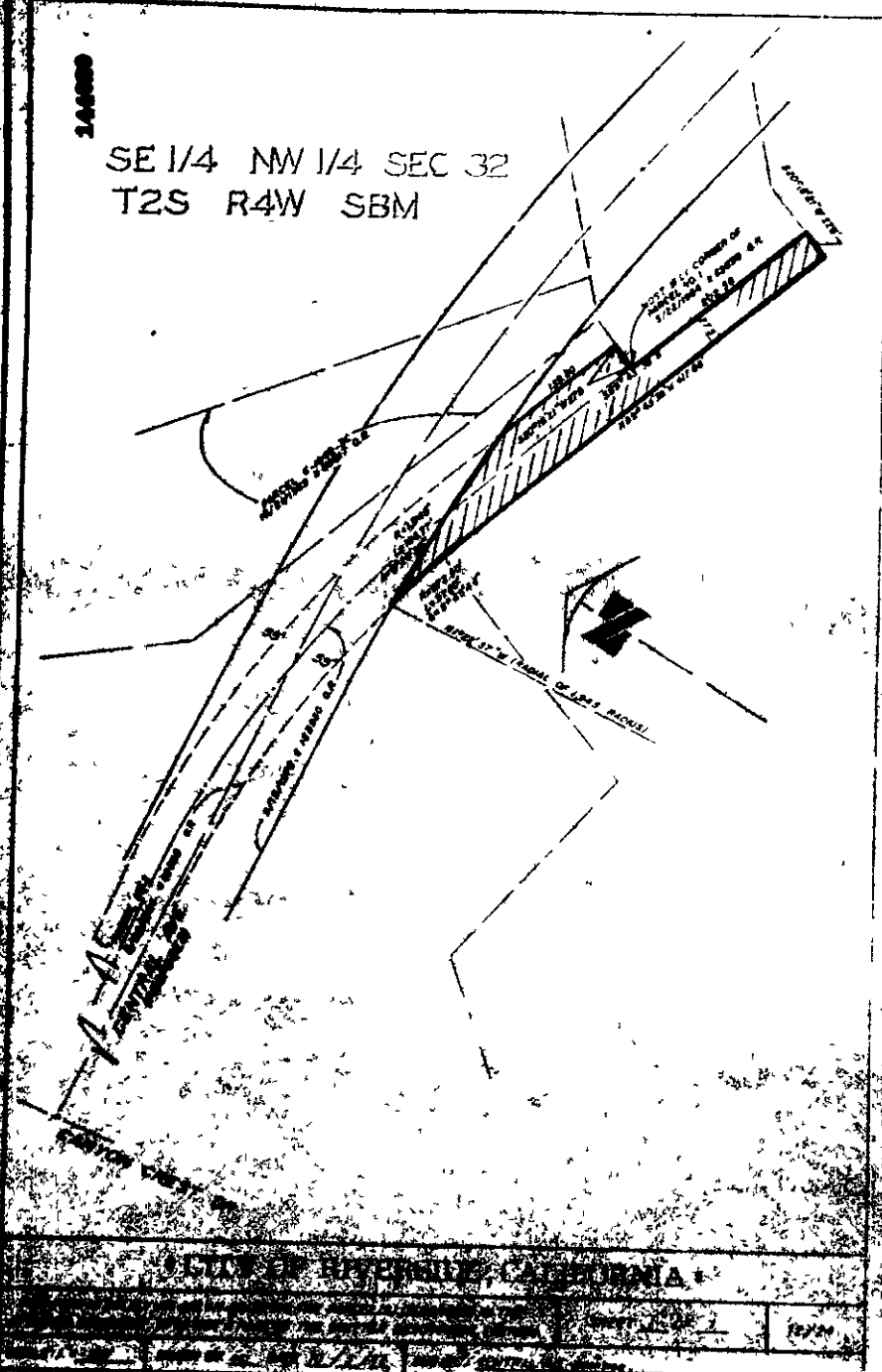

CITY OF BERBERIE, CALIFORNIA

10/20

144020

RECEIVED FOR RECORD

NOV 21 1962

STATE OF CALIFORNIA

COUNTY OF SAN DIEGO

RECORDED

RECORDED DOCUMENT. W. D. BALOGH, COUNTY RECORDER