

RECORDING REQUESTED BY

AND WHEN RECORDED MAIL TO

NAME Security Title Ins. Co.
 STREET ADDRESS P. O. Box 111
 CITY & STATE Riverside, California

PERMITTED FOR RECORD
 JAN 3 1963
 AT 10 O'CLOCK AM
 SECURITY TITLE INSURANCE CO
 No. 2022 in C. Road, Riverside

W. O. [Signature]
 REC-360

093
 360

SPACE ABOVE THIS LINE FOR RECORDER'S USE

APPROVED AS TO FORM

APPROVED AS TO FORM

APPROVED AS TO FORM

Corporation Quitclaim Deed

THIS FORM FURNISHED BY SECURITY TITLE INSURANCE COMPANY

FOR A VALUABLE CONSIDERATION, receipt of which is hereby acknowledged,
 THE CITY OF RIVERSIDE, a municipal corporation, as successor
 to RIVERSIDE WATER COMPANY

do hereby remise, release and forever quitclaim to the owners of record of the hereinafter described real property, as their respective interests may appear, that certain easement reserved to the Riverside Water Company for the construction and maintenance of water ditches and pipe lines over and across the following described real property in the City of Riverside county of Riverside state of California:

Lot 38 of Hewitt Place, as shown by Map on file in Book 7 page 3 of Maps, Riverside County records.

Dated December 5, 1963

STATE OF CALIFORNIA
 COUNTY OF _____

On _____ before me the undersigned a Notary Public in and for said County and State personally appeared _____

known to me to be the _____ President, and _____ known to me to be _____

Secretary of the corporation that executed the within instrument and known to me to be the person who executed the within instrument on behalf of the corporation therein named and acknowledged to me that such corporation executed the within instrument pursuant to its by-laws or resolution of its board of directors.

(Seal) _____
 Name (Typed or Printed)
 Notary Public in and for said County and State.

THE CITY OF RIVERSIDE
 BY: *[Signature]*
 Attest Mayor
 BY: *[Signature]*
 City Clerk

ACK. O.K.

Title Order No. 317537
 Form of Loan No. 48224-B

JAN 3 1963

S

796

APR 13 478

SECURITY TITLE
 LANE E. C. COMPANY

1/2 SECTION 31 T11N R11E S11W

7/9

JAN 3 1964

8

MAP
 OF
HEWITT PLACE
 BEING A SUBDIVISION OF
 LOT 24
 SOUTHERN CALIFORNIA COLONY
 ASSOCIATION LANDS
 RIVERSIDE, CAL.
 SURVEYED BY
 H.D. BRADLEY
 D.C. 1909.
 SCALE 1" = 20'

796

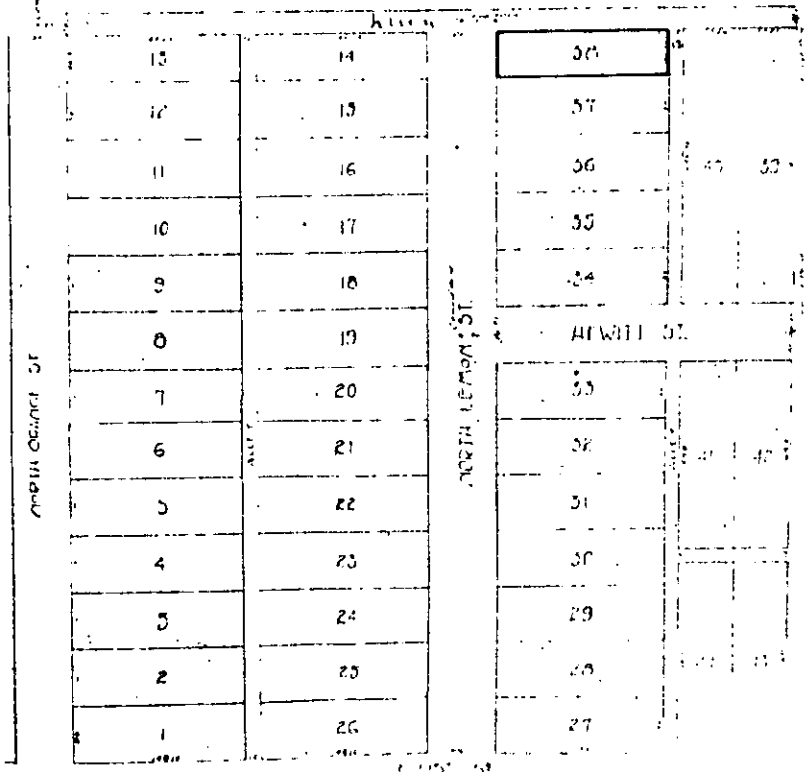

"This plat is for your aid in locating your land with reference to streets and other parcels. It is not a survey. While this plat is believed to be correct, the Company assumes no liability for any loss or cutting by reason of reliance thereon."

SECURITY TITLE
 LANE E. C. COMPANY

E.H. Sales

478