

148467

RECORDING REQUESTED BY

WHEN RECORDING MAKE THE

*City of Riverside  
County of Riverside  
16-118*

RECEIVED FOR RECORD  
DEC 14 1964  
AT 9:00 O'CLOCK A.M.  
TITLE INS & TRUST CO.  
Riverside, California

APPROVED AS TO FORM  
*John Woodhead*  
CITY ATTORNEY

DEC 14 1964

TI

148467

(SPACE ABOVE THIS LINE FOR RECORDERS USE)

### QUITCLAIM DEED

FOR A VALUABLE CONSIDERATION, receipt of which is hereby acknowledged The City of Riverside,  
a Municipal Corporation

do hereby  
REINSE, RELIANCE AND FOREVER QUITCLAIM to the Owners of Record, as their respective  
interests may appear

the real property in the City of Riverside County of Riverside  
State of California, described as

That certain right of way and easement reserved  
by the Riverside Water Company and its assigns for the construction  
and maintenance of all necessary water ditches, pipes, flumes and  
apparatus over and across the following described property:

The Northwesterly one-half of the Southwesterly 160.66 feet of that  
portion of the following described land:  
That portion of Lots 42 and 43 in Block 12 of the VILLAGE OF ARLINGTON,  
as shown by map on file in book 1 page 62 of Maps, San Bernardino  
County Records, described as follows:  
Beginning at the most Westerly corner of said Lot 42, said point being  
the intersection of the Northeasterly line of Van Buren Street, with  
the Southeasterly line of California Avenue, as shown on said map;  
Thence North 56° 02' 30" East, along the Southeasterly line of said  
California Avenue, being the Northwesterly line of said Lots 42 and 43,  
360.66 feet, to the most Westerly corner of that certain parcel of land  
conveyed to University Gardens, Inc., a corporation, by deed recorded  
May 29, 1953 in book 1477 page 207, Official Records, Riverside County  
Records;  
Thence South 34° 00' East, parallel with the Northeasterly line of said  
Lot 43, 400 feet;  
Thence South 56° 02' 30" West, parallel with the Northwesterly lines of  
said Lots 42 and 43 360.66 feet, more or less, to a point on the  
Southwesterly line of said Lot 42, said point being on the Northeasterly  
line of said Van Buren Street;  
Thence North 34° 00' West, along the Southwesterly line of said Lot 42  
and said Northeasterly line of Van Buren Street, 400 feet, to the point  
of beginning;  
EXCEPTING therefrom the Northwesterly 4 feet and the Southwesterly 10  
feet as conveyed to the City of Riverside, by deed recorded June 11, 1956  
as Instrument No. 40327.

5/6 532

DEC 14 1964

ST

148467

Date October 27, 1964

CITY OF RIVERSIDE

By E. J. Salas

Attest [Signature] Mayor  
[Signature] City Clerk

State of California, **ACK. O.K.**

County of \_\_\_\_\_

On \_\_\_\_\_ before me, the undersigned, a Notary Public in and for said State,

personally appeared \_\_\_\_\_

DEC 14 1964

TI

148487

PORTION OF  
LOTS 42&43 OF BLOCK 12 OF  
VILLAGE OF ARLINGTON

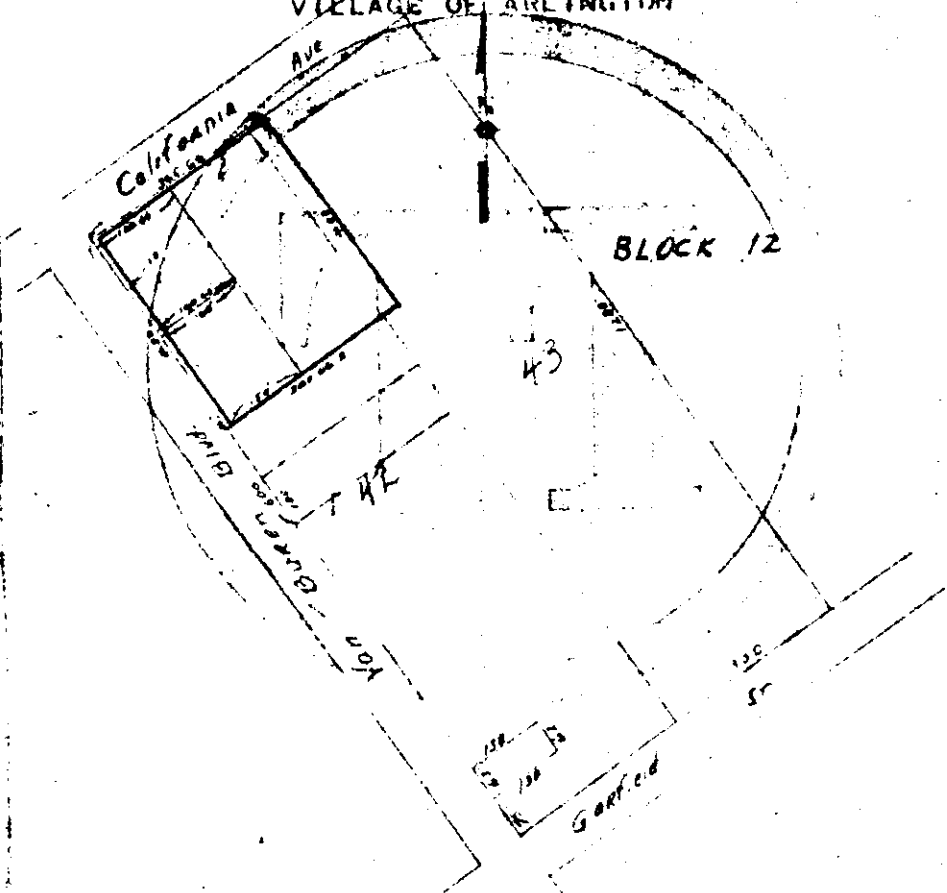

This is not a survey of the land but is compiled for information by the Title Insurance and Trust Company from data shown by the official records.