

51266

When recorded mail to:

Donald M. Pen
16500 Gardner
Riverside Ca
92504

RECEIVED FOR RECORD

When Paid (if check)

at Office of

Recorder

Book 1980 Page

MAR 17 1980

Recorder of Deeds, County of Riverside, California

David M. Pen

16500 Gardner

Riverside Ca

MAR 17 1980

FOR RECORDER'S OFFICE USE ONLY

Project: 6047 Sheppard Street
Building Permit

QUITCLAIM DEED

FOR A VALUABLE CONSIDERATION, receipt of which is hereby acknowledged,
the CITY OF RIVERSIDE, a Municipal Corporation, does hereby remise, release,
and forever quitclaim to DAVID M. ASHLEY, a single man

the real property in the City of Riverside, County of Riverside, State of
California, described as follows:

The Northeasterly 10.00 feet of Lot 5 in Block 2 of the Salt Lake Depot
Tract as shown by Map on file in Book 6 Page 54 of Maps, records of
Riverside County, California.

DESCRIPTION APPROVAL
By David M. Pen 2/21/80

INCIDENTARY TRANSFER TAX 0.
COMPUTED ON FULL VALUE OF PROPERTY CONVEYED
OR COMPUTED ON FULL VALUE LESS DEBTS AND
LIABILITIES REMAINING AT TIME OF SALE
Signature of Escrowee or Agent Determining Tax From Name

651

Mar. 17, 1980

1516661

APPROVED AS TO FORM

Robert Wilson
SENIOR COUNTY ATTORNEY

CITY OF RIVERSIDE, a Municipal Corporation

Dated March 5 1980

By *Ab Brown* Mayor

Attest *Margaret I. Allen* City Clerk

STATE OF CALIFORNIA)
COUNTY OF RIVERSIDE) ss.

On this 5th day of March, 1980, before me, Margaret I. Allen, a Notary Public in and for said County and State, personally appeared Ab Brown, Mayor, and Alice A. Hare, City Clerk of the City of Riverside, California, the municipal corporation described in and which executed the within instrument, and acknowledged to me that such municipal corporation executed the same.

IN WITNESS WHEREOF I have hereunto set my hand and affixed my official seal the day and year in the certificate first above written.

MARGARET I. ALLEN
NOTARY PUBLIC
STATE OF CALIFORNIA

Margaret I. Allen
Notary Public in and for the County of Riverside, State of California

17, 1900

61236

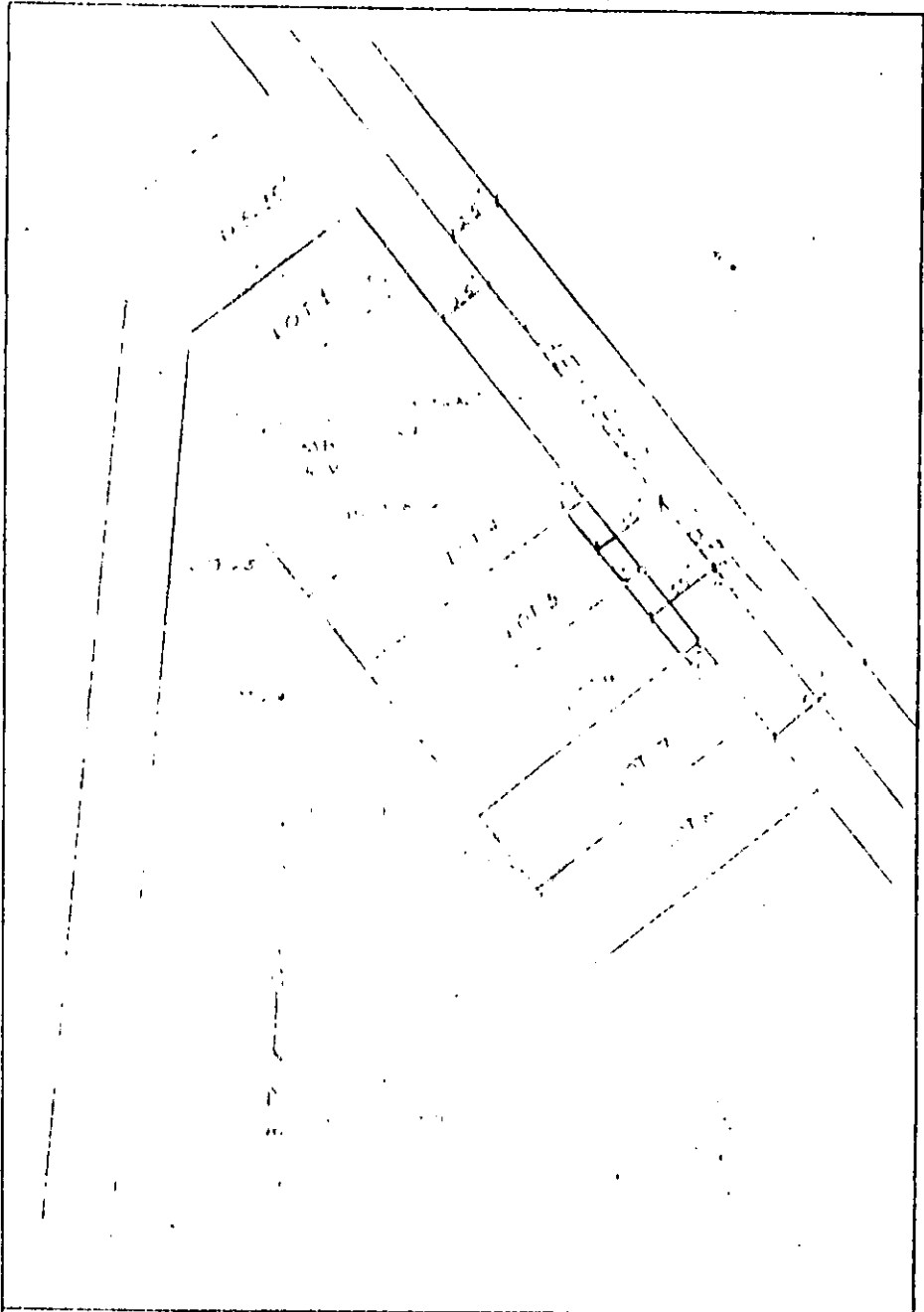

• CITY OF RIVERSIDE, CALIFORNIA •

THIS PLAN IS SUBMITTED AS AID IN LOCATING THE PARCELS DESCRIBED IN THE ATTACHED LIST WHICH IS NOT A PART OF THE APPLICABLE ZONING ORDINANCE		SHEET 1 OF 1	651
SCALE	DRAWN BY J. L. GARDNER, CIVIL ENGINEER	SERVED WITH LAND RECORDS DEPARTMENT	

651