

A-295

When recorded mail to:

42

166736

RECEIVED P.L. RECORD
OCT 29 1976

San Diego Title Insurance Co.
1100 Broadway, San Diego, Calif. 92101
Wm. B. ...

DOCUMENTARY TRANSFER TAX
\$ 0 None
Signature William J. McLean
CITY OF RIVERSIDE

FOR RECORDER'S OFFICE USE ONLY

Project: PM 18/9

QUITCLAIM DEED

FOR A VALUABLE CONSIDERATION, receipt of which is hereby acknowledged, the CITY OF RIVERSIDE, a Municipal Corporation, does hereby remise, release, and forever quitclaim to FORREST R. TOWNSEND and FRANCIS L. TOWNSEND, husband and wife, as joint tenants,

the real property in the City of Riverside, County of Riverside, State of California, described as follows:

That portion of Lot 4 in Block 6 of the Lands of the RIVERSIDE LAND & IRRIGATING CO., on file in Book 1 of Maps, at Page 70 thereof, records of San Bernardino County, California, described as follows:

The Northerly 33.00 feet of Parcel 3 of PARCEL MAP, on file in Book 13 of Parcel Maps, at Page 9 thereof, records of Riverside County, California; said Northerly 33.00 feet being measured at right angle 33.00 feet Southerly from the northerly line of said Parcel 3.

This instrument is given for the purpose of quitclaiming the rights created by that certain Grant Deed recorded February 8, 1957, in Book 2037 of Official Records, at Page 384, et seq., records of said Riverside County.

DESCRIPTION APPROVAL
By George P. White 2/24/76

R

11-75-76
032

CITY OF RIVERSIDE, a Municipal Corporation

Dated October 12, 1976

Margaret I. Allen
By

Mayor Pro Tempore

Alice A. Hare
Attest

City Clerk

STATE OF CALIFORNIA)
COUNTY OF RIVERSIDE) ss.

On this 12th day of October, 1976, before me, Margaret I. Allen, a Notary Public in and for said County and State, personally appeared Arden R. Anderson, Mayor Pro Tempore, and Alice A. Hare, City Clerk of the City of Riverside, California, the municipal corporation described in and which executed the within instrument, and acknowledged to me that said municipal corporation executed the same.

IN WITNESS WHEREOF I have hereunto set my hand and affixed my official seal the day and year in the certificate first above written.

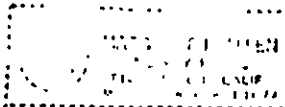

Margaret I. Allen
Notary Public in and for the County of Riverside, State of California

APPROVED AS TO FORM

Clarice Sumner
DEPUTY CITY ATTORNEY

720

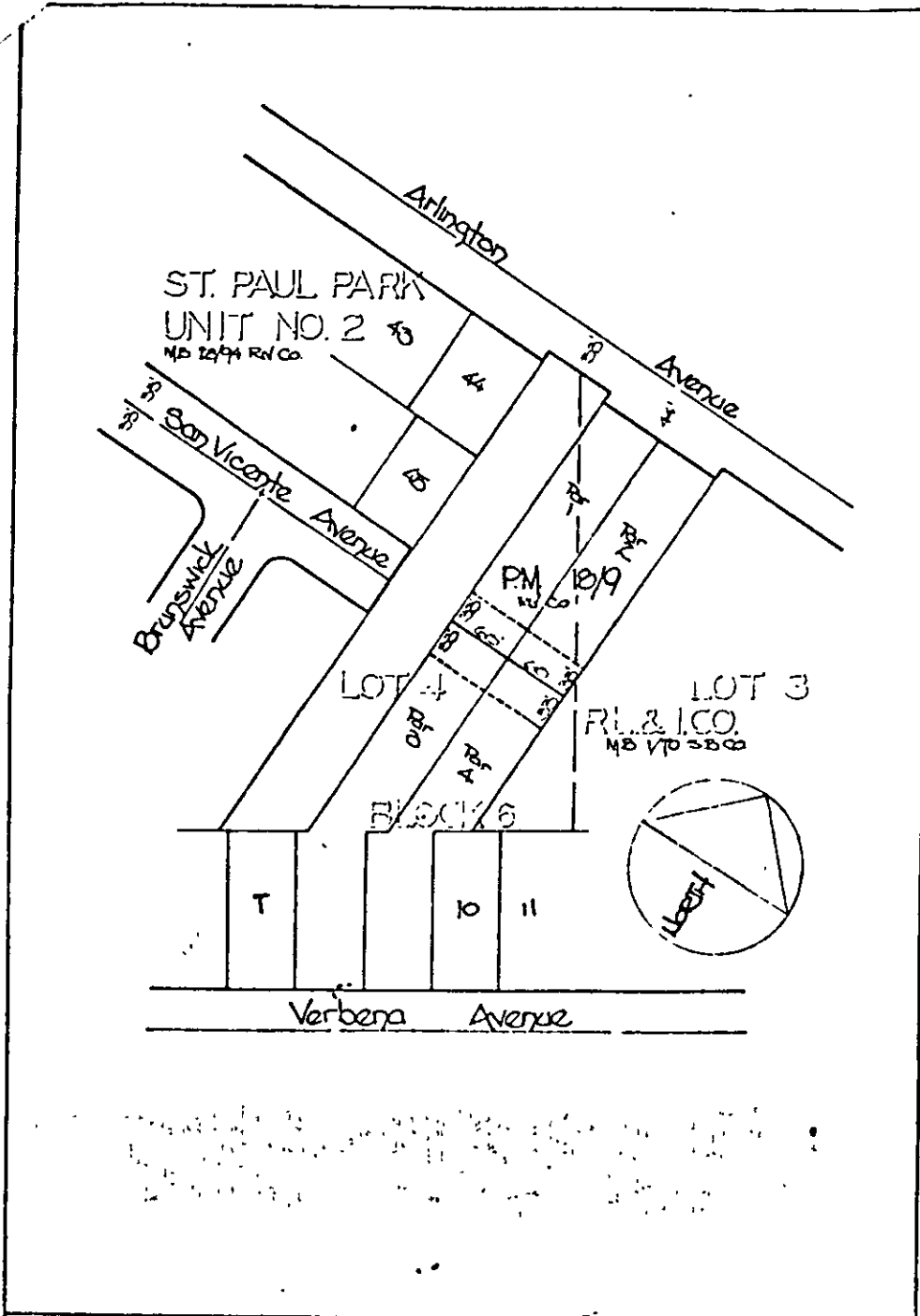

• CITY OF RIVERSIDE, CALIFORNIA •

THIS PLAT IS SOLELY AN AID IN LOCATING THE PARCEL(S) DESCRIBED IN THE ATTACHED DOCUMENT. IT IS NOT A PART OF THE WRITTEN DESCRIPTION THEREOF.		SHEET <u>1</u> OF <u>1</u>	5/33
SCALE 1" = 100'	DRAWN BY <u>V. LUTE B. 3/76</u>	SUBJECT <u>San Vicente Ave Ext. - T.M. 18/9</u>	

720