

When recorded mail to:
126419 Norman J. Celse
Wm. Austin Co.
600 Central Ave, Ste 81
Riverside, CA 92507

FAV 12-02

RECEIVED FOR RECORD
AT 9 00 O'CLOCK AM
BY
FIRST AMERICAN TITLE COMPANY
OF RIVERSIDE
Book 1583, Page

JUN 24 1983

Approved by
Willie J. Perry
Recorder

June 24, 1983

FOR RECORDERS OFFICE USE ONLY
Project: PMW-27-202 no transfer tax due

QUITCLAIM DEED

THIS INSTRUMENT IS SUBJECT TO THE RIGHTS OF THE CITY OF RIVERSIDE TO REVOKE OR MODIFY THE SAME BY ORDER OF THE BOARD OF SUPERVISORS OF THE CITY OF RIVERSIDE, CALIFORNIA, IN ACCORDANCE WITH THE PROVISIONS OF CHAPTER 10 OF THE CITY CHARTER, AS AMENDED, AND TO THE EXTENT OF SUCH RIGHTS, THIS INSTRUMENT SHALL BE VOID AND OF NO EFFECT.

FOR A VALUABLE CONSIDERATION, receipt of which is hereby acknowledged, the CITY OF RIVERSIDE, a Municipal Corporation, does hereby remise, release, and forever quitclaim to NAVLOR ENTERPRISES, a limited partnership,

the real property in the City of Riverside, County of Riverside, State of California, described as follows:

That portion of Lot 92 of the Lands of the Southern California Colony Association, as shown by map on file in Book 7 of Maps at Page 2 thereof, records of San Bernardino County California being more particularly described as follows:

- COMMENCING at the southwest corner of said Lot 92;
- THENCE Northeasterly 100 feet to the true point of beginning;
- THENCE Southeasterly and parallel with the most southerly property line of said Lot 92, a distance of 637.00 feet;
- THENCE Northeasterly and parallel with the most easterly property line of Lot 92, a distance of 10 feet;
- THENCE Northwesterly a distance of 637.00 feet;
- THENCE Southwesterly a distance of 10 feet to the true point of beginning.

UNRESTRICTED APPROVAL
George L. Hutchinson 5/13

126419

June 24, 1983

FA

126419

ACK. ATTACHED

Ronald M. Ventura
APPLICABLE AS TO FORM 1
SINCE DEPUTY CITY ATTORNEY

CITY OF RIVERSIDE, a Municipal Corporation

Dated June 24 1983

By *C. P. K. [unclear]* Mayor

Attest *Alice A. [unclear]* City Clerk

STATE OF CALIFORNIA) ss.
COUNTY OF RIVERSIDE)

On this 24 day of June, 1983, before me
Notary Public in and for said County and State, personally appeared
[unclear] Mayor, and [unclear] City Clerk of the
City of Riverside, California, the municipal corporation described in and
which executed the within instrument, and acknowledged to me that such
municipal corporation executed the same.

IN WITNESS WHEREOF I have hereunto set my hand and affixed my official
seal the day and year in the certificate first above written.

Notary Public in and for the County
of Riverside, State of California

June 24, 1983

FA

126419

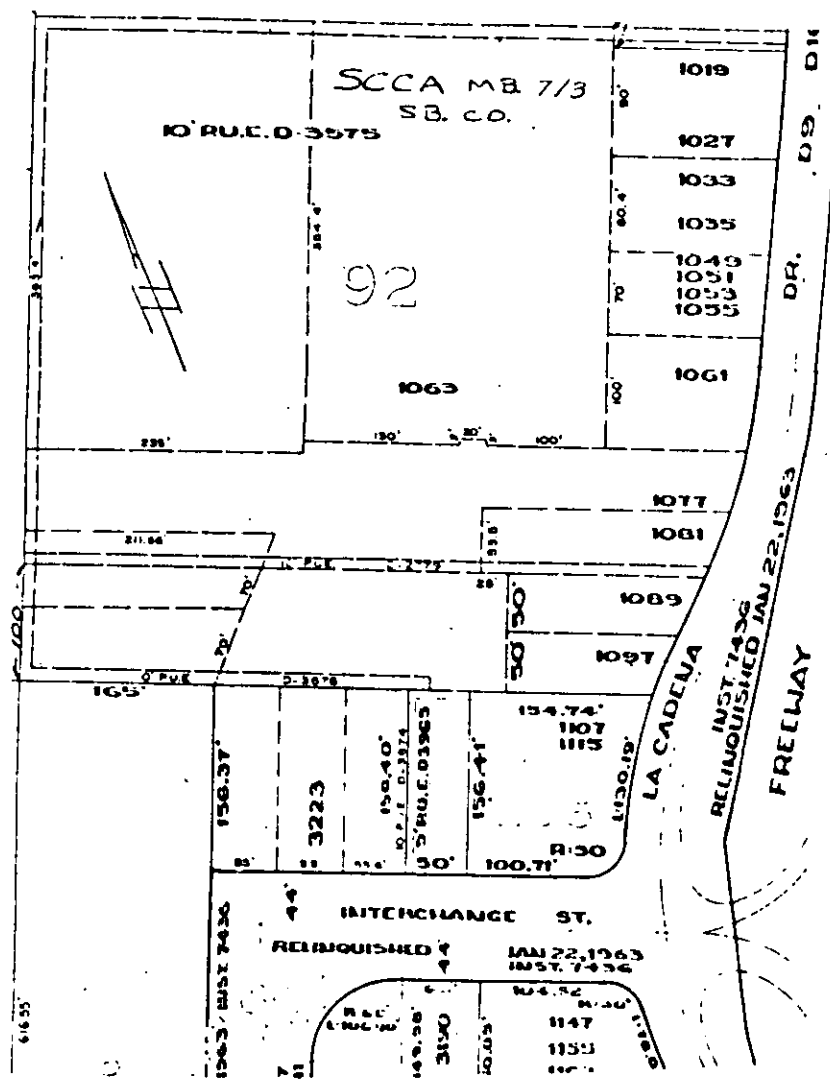

• CITY OF RIVERSIDE, CALIFORNIA •

THIS PLAT IS SOLELY AN AID IN LOCATING THE PARCEL(S) DESCRIBED IN THE WRITTEN INSTRUMENT. IT IS NOT A PART OF THE WRITTEN DESCRIPTION THEREIN.

SHEET 1 OF 1

E.P. _____ DRAWN BY _____ DATE 6/27/83 SUBJECT _____