

When recorded mail to:

COPY of Document Recorded
 OCT 08 1987 on..... as No. 87-363471
 Has not been compared with original.
 SAN BERNARDINO COUNTY RECORDER

FOR RECORDER'S OFFICE USE ONLY

Project: Quitclaim Deed of Waterline Facilities

QUITCLAIM DEED

FOR VALUABLE CONSIDERATION, receipt of which is hereby acknowledged, the CITY OF RIVERSIDE, a municipal corporation, does hereby remise, release, and forever quitclaim to ONE MARKET STREET PROPERTIES, INC., a corporation, the real property in the City of Colton, County of San Bernardino, State of California, described as follows:

That certain easement for waterline facilities conveyed to the Riverside Water Company, a corporation, by a deed recorded May 17, 1910, in Book 460, Page 88, et seq., of Deeds, records of San Bernardino County, described as follows:

COMMENCING at the southwest corner of Lot 7 in Block 64 of Rancho San Bernardino, on file in Book 7 of Maps, Page 2, records of San Bernardino County, California;

THENCE North 0° 03' West, a distance of 676.8 feet for the POINT OF BEGINNING;

THENCE North 52° 22' East, a distance of 2,142.3 feet thru Lots 7 and 8 in said Block 64 to the southerly line of Southern Pacific Transportation Company right-of-way as shown on Tract 11414, on file in Book 157, Pages 41 thru 44 of Maps, records of said San Bernardino County;

EXCEPTING THEREFROM that portion lying south of the northerly boundary line and the easterly prolongation thereof of Parcel Map 3902, on file in Book 36, Pages 19 and 20 of Parcel Maps, records of said San Bernardino County.

DESCRIPTION APPROVAL 9/18/87
Serge P. Hutchinson
 SURVEYOR, CITY OF RIVERSIDE by [Signature]

Dated September 30, 1987

CITY OF RIVERSIDE,
a municipal corporation

By *Ab Brown*
Mayor

Attest *Alice A. Hare*
City Clerk

APPROVED AS TO FORM
Kathleen M. Angel
ASST. CITY ATTORNEY

STATE OF CALIFORNIA) ss.
COUNTY OF RIVERSIDE)

On this 30th day of September, in the year 1987, before me,
Margaret I. Archambault a Notary Public in
and for said County and State, personally appeared Ab Brown and
Alice A. Hare personally known to me to
be the persons who executed this instrument as Mayor and City Clerk of the City
of Riverside, a municipal corporation, and acknowledged to me that the municipal
corporation executed the same.

Witness my hand and official seal.

Margaret I. Archambault
Notary Public in and for said State

311.8/m - SURVEY.141/k

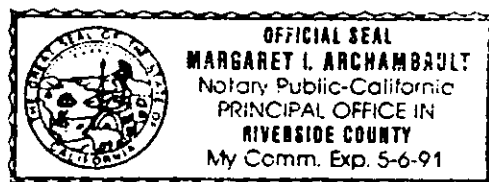

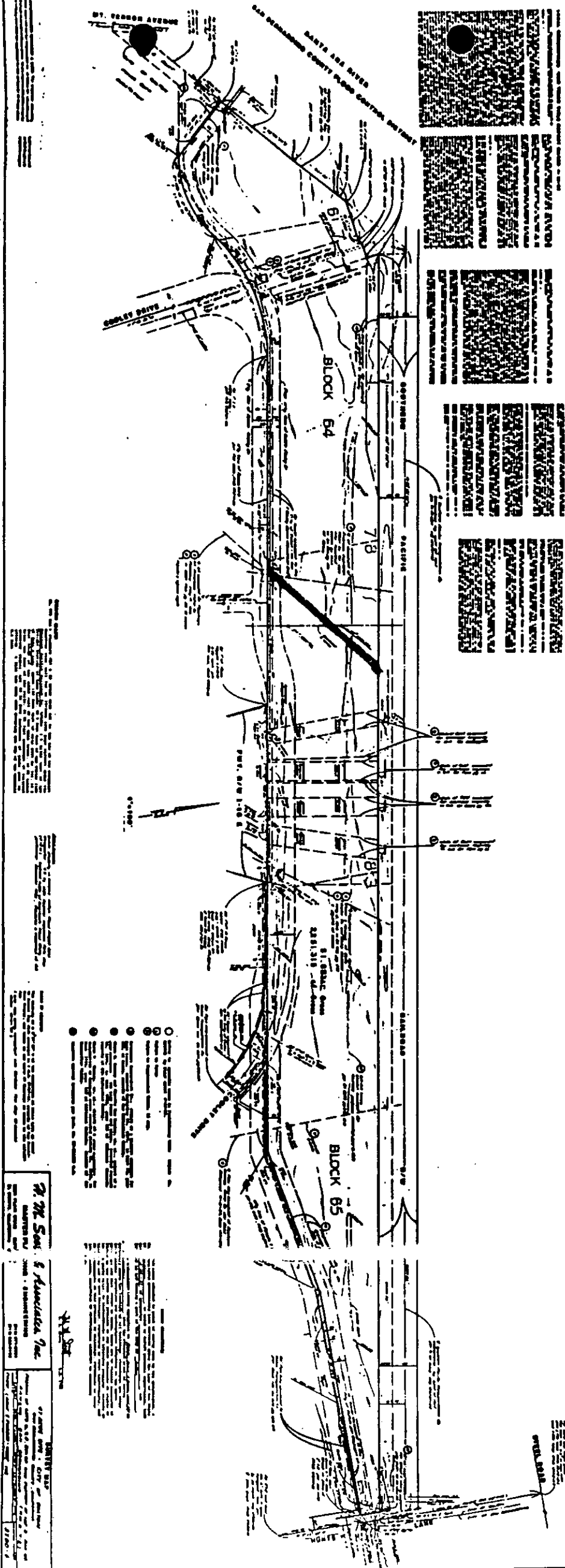

ALL DISTANCES SHOWN ON THIS PLAN ARE IN FEET AND DECIMALS THEREOF.
 ALL DIMENSIONS ARE TO CENTER OF CURVES UNLESS OTHERWISE NOTED.
 ALL CURVES ARE TO BE CONFORMED TO THE STANDARD PRACTICE.
 ALL DISTANCES ARE TO BE MEASURED ALONG THE CENTER LINE.
 ALL DISTANCES ARE TO BE MEASURED ALONG THE CENTER LINE.
 ALL DISTANCES ARE TO BE MEASURED ALONG THE CENTER LINE.
 ALL DISTANCES ARE TO BE MEASURED ALONG THE CENTER LINE.
 ALL DISTANCES ARE TO BE MEASURED ALONG THE CENTER LINE.
 ALL DISTANCES ARE TO BE MEASURED ALONG THE CENTER LINE.

- 1. 12" WATER MAIN
- 2. 8" WATER MAIN
- 3. 6" WATER MAIN
- 4. 4" WATER MAIN
- 5. 2" WATER MAIN
- 6. 12" SANITARY SEWER
- 7. 8" SANITARY SEWER
- 8. 6" SANITARY SEWER
- 9. 4" SANITARY SEWER
- 10. 2" SANITARY SEWER
- 11. 12" GAS MAIN
- 12. 8" GAS MAIN
- 13. 6" GAS MAIN
- 14. 4" GAS MAIN
- 15. 2" GAS MAIN
- 16. 12" ELECTRIC MAIN
- 17. 8" ELECTRIC MAIN
- 18. 6" ELECTRIC MAIN
- 19. 4" ELECTRIC MAIN
- 20. 2" ELECTRIC MAIN

THE SOUL & ASSOCIATES, INC.
 ARCHITECTS
 2100 ...
 ...
 ...