

When recorded mail to:

RECORDED Feb 4, 1986
INSTRUMENT NO #27693
OFFICIAL RECORDS, RIV. CO.

FOR RECORDER'S OFFICE USE ONLY

Project: Quitclaim Deed for Lots in Vacated Streets
QUITCLAIM DEED

FOR VALUABLE CONSIDERATION, receipt of which is hereby acknowledged, the CITY OF RIVERSIDE, a municipal corporation, does hereby remise, release, and forever quitclaim to BUTCHER BOY FOOD PRODUCTS INCORPORATED, a California Corporation, the real property in the City of Riverside, County of Riverside, State of California, described as follows:

Parcel 1

All those portions of Lots 57 through 63, inclusive, Lot 65 and Lots 75 through 83, inclusive of Division "A" of Hall's Addition to Riverside, as shown by map recorded in Book 9, Page 1 of Maps, records of San Bernardino County, California, lying southeasterly of a line which is parallel with and distant 30 feet southeasterly as measured at right angle from the centerline of Commerce Street (formerly Pachappa Avenue), and lying northwesterly of a line which is parallel with and distant 30 feet northwesterly as measured at right angle from the centerline of Howard Avenue.

Parcel 2

All that portion of Lots 1 and 18 of the Foster Tract, as shown by map on file in Book 8, Page 13 of Maps, records of Riverside County, California, lying southeasterly of line which is parallel with and distant 30 feet southeasterly as measured at right angle from the centerline of Commerce Street (formerly Pachappa Avenue) and lying northeasterly of a line which is parallel with and distant 28.31 feet northeasterly as measured at right angle from the southwesterly line of said Lot 1.

DESCRIPTION APPROVED
[Signature] 11/21/85
1

COPY

883

Dated _____ 19__

CITY OF RIVERSIDE,
a municipal corporation

By _____
Mayor

Attest _____
City Clerk

STATE OF CALIFORNIA) ss.
COUNTY OF RIVERSIDE)

On this _____ day of _____, in the year _____, before me,
a Notary Public

in and for said County and State, personally appeared _____
personally known to me
to be the persons who executed this instrument as Mayor and City Clerk of the
City of Riverside, a municipal corporation, and acknowledged to me that the
municipal corporation executed the same.

Witness my hand and official seal.

Notary Public in and for said State

0046X/m - 8486M/a

COPY

[883]

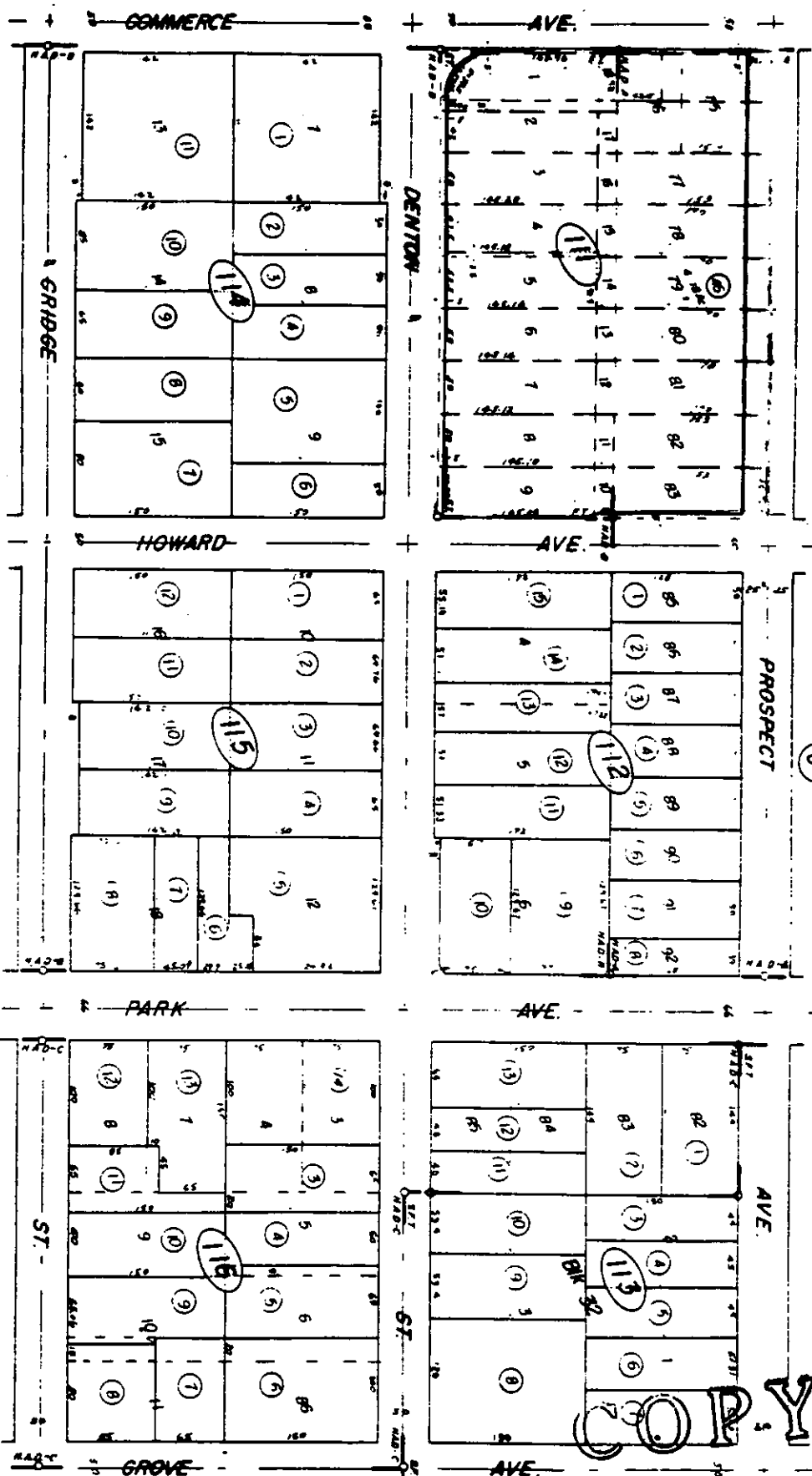

ASSESSOR'S MAP BK. 219 PG. 11
RIVERSIDE COUNTY, CALIF.

M.B. 8/13 Foster Tract
M.B. 9/1 S.B. Hall's Addition Division A
M.B. 9/2 S.B. " " " B
M.B. 9/3 S.B. " " " C
M.B. 6/14 S.B. Sonia Rb Tract

MAR 1974

TRACT	ACRES	DATE	REMARKS
114	1.14	8/13	Foster Tract
115	1.15	9/1	Hall's Addition Division A
116	1.16	9/2	" " " B
		9/3	" " " C
		6/14	Sonia Rb Tract

FOR CITY OF RIVERSIDE
(T2SR5)

T.R.A. 305

219-06

BK 211

COPY

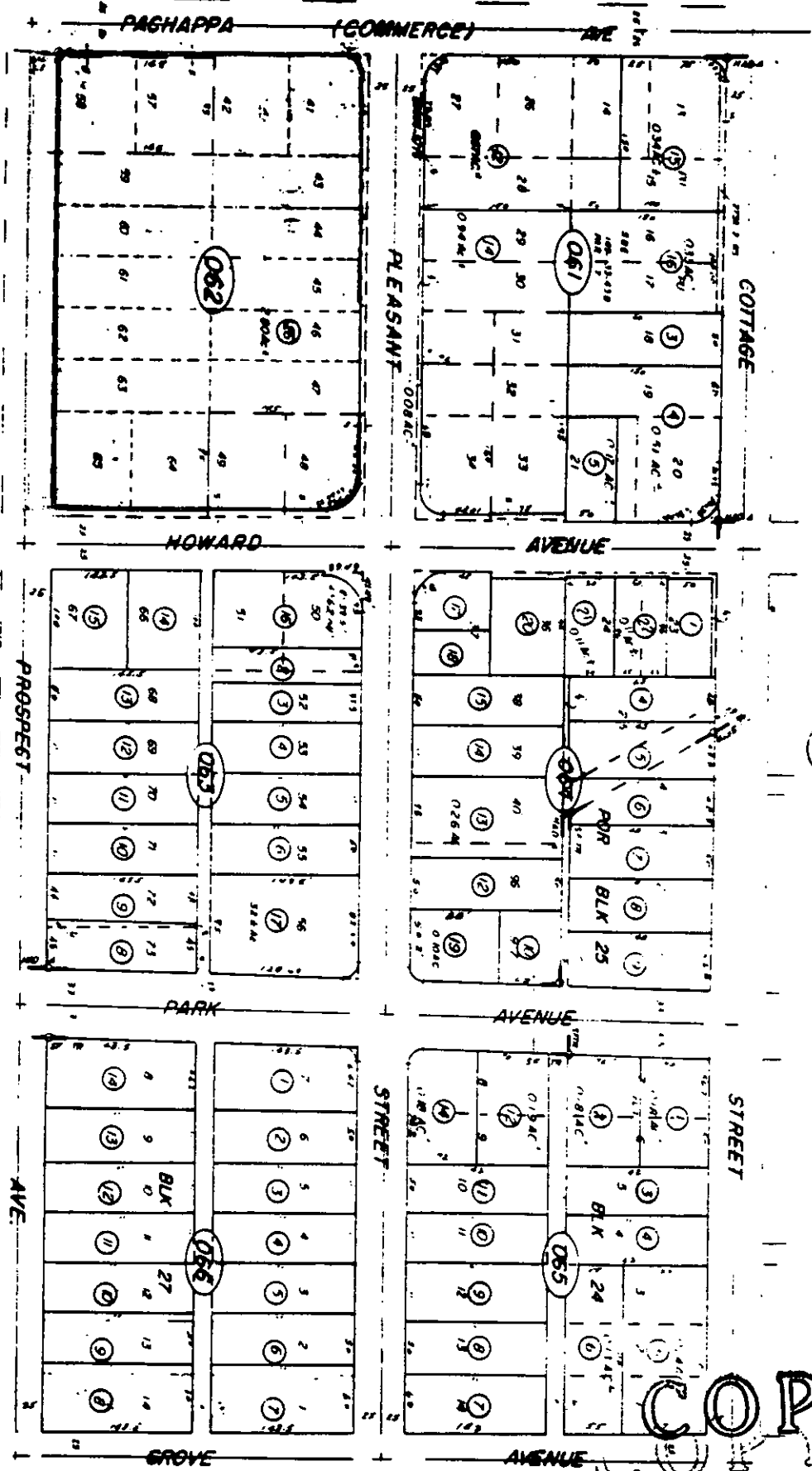

ASSESSOR'S MAP BK 219 PG 05
RIVERSIDE COUNTY, CALIF.

MB 9/158 North Addition Division - A
MB 6/158 SR Santa Fe Tract

Lot No.	Area (Ac.)	Area (Sq. Ft.)	Area (Sq. Ft.)
1	0.10	4,356	4,356
2	0.10	4,356	4,356
3	0.10	4,356	4,356
4	0.10	4,356	4,356
5	0.10	4,356	4,356
6	0.10	4,356	4,356
7	0.10	4,356	4,356
8	0.10	4,356	4,356
9	0.10	4,356	4,356
10	0.10	4,356	4,356
11	0.10	4,356	4,356
12	0.10	4,356	4,356
13	0.10	4,356	4,356
14	0.10	4,356	4,356
15	0.10	4,356	4,356
16	0.10	4,356	4,356
17	0.10	4,356	4,356
18	0.10	4,356	4,356
19	0.10	4,356	4,356
20	0.10	4,356	4,356
21	0.10	4,356	4,356
22	0.10	4,356	4,356
23	0.10	4,356	4,356
24	0.10	4,356	4,356
25	0.10	4,356	4,356
26	0.10	4,356	4,356
27	0.10	4,356	4,356
28	0.10	4,356	4,356
29	0.10	4,356	4,356
30	0.10	4,356	4,356
31	0.10	4,356	4,356
32	0.10	4,356	4,356
33	0.10	4,356	4,356
34	0.10	4,356	4,356
35	0.10	4,356	4,356
36	0.10	4,356	4,356
37	0.10	4,356	4,356
38	0.10	4,356	4,356
39	0.10	4,356	4,356
40	0.10	4,356	4,356
41	0.10	4,356	4,356
42	0.10	4,356	4,356
43	0.10	4,356	4,356
44	0.10	4,356	4,356
45	0.10	4,356	4,356
46	0.10	4,356	4,356
47	0.10	4,356	4,356
48	0.10	4,356	4,356
49	0.10	4,356	4,356
50	0.10	4,356	4,356
51	0.10	4,356	4,356
52	0.10	4,356	4,356
53	0.10	4,356	4,356
54	0.10	4,356	4,356
55	0.10	4,356	4,356
56	0.10	4,356	4,356
57	0.10	4,356	4,356
58	0.10	4,356	4,356
59	0.10	4,356	4,356
60	0.10	4,356	4,356
61	0.10	4,356	4,356
62	0.10	4,356	4,356
63	0.10	4,356	4,356
64	0.10	4,356	4,356
65	0.10	4,356	4,356
66	0.10	4,356	4,356
67	0.10	4,356	4,356
68	0.10	4,356	4,356
69	0.10	4,356	4,356
70	0.10	4,356	4,356
71	0.10	4,356	4,356
72	0.10	4,356	4,356
73	0.10	4,356	4,356
74	0.10	4,356	4,356
75	0.10	4,356	4,356
76	0.10	4,356	4,356
77	0.10	4,356	4,356
78	0.10	4,356	4,356
79	0.10	4,356	4,356
80	0.10	4,356	4,356
81	0.10	4,356	4,356
82	0.10	4,356	4,356
83	0.10	4,356	4,356
84	0.10	4,356	4,356
85	0.10	4,356	4,356
86	0.10	4,356	4,356
87	0.10	4,356	4,356
88	0.10	4,356	4,356
89	0.10	4,356	4,356
90	0.10	4,356	4,356
91	0.10	4,356	4,356
92	0.10	4,356	4,356
93	0.10	4,356	4,356
94	0.10	4,356	4,356
95	0.10	4,356	4,356
96	0.10	4,356	4,356
97	0.10	4,356	4,356
98	0.10	4,356	4,356
99	0.10	4,356	4,356
100	0.10	4,356	4,356