

44038

When recorded mail to:

City of Riverside
Public Works Department
3900 Main Street
Riverside, CA 92522

RECEIVED FOR RECORD
Min. Past 2 o'clock P.M.

FEB 10 1989

Rec'd in Office of Recorder of Riverside County, California

William E. Shroy
RECORDER

Please record for the benefit of the City of Riverside
Property Services Manager

FOR RECORDER'S OFFICE USE ONLY

Project: Parcel Map No. 21398
1525 Third Street

QUITCLAIM DEED

FOR VALUABLE CONSIDERATION, receipt of which is hereby acknowledged, the CITY OF RIVERSIDE, a municipal corporation, does hereby remise, release, and forever quitclaim to BUSINESS WAY INVESTMENTS, LIMITED, a California limited partnership, the real property in the City of Riverside, County of Riverside, State of California, described as follows:

That portion of those certain access rights for vehicular ingress and egress which were relinquished to the City of Riverside, a municipal corporation, from that portion of Parcel 6 of Parcel Map No. 17,402, as shown by map on file in Book 119, Pages 50 and 51 of Parcel Maps, records of Riverside County, California, over and across Third Street, more particularly described as follows:

The westerly 50.00 feet of the easterly 115.00 feet of Parcel 3 of Parcel Map No. 21398, as shown by map on file in Book 136, Pages 94 and 95 of Parcel Maps, records of said Riverside County.

DESCRIPTION APPROVAL 11/30/88
George P. Hutchinson
SURVEYOR, CITY OF RIVERSIDE

Dated February 7, 1989

CITY OF RIVERSIDE,
a municipal corporation

By [Signature]
Mayor

Attest [Signature]
City Clerk



APPROVED AS TO FORM
[Signature] 1/27/89
CAROLYN CONFER
ASSISTANT CITY ATTORNEY



STATE OF CALIFORNIA) ss.
COUNTY OF RIVERSIDE)

On this 7th day of February, in the year 1939, before me,
Margaret I. Archambault a Notary Public in
and for said County and State, personally appeared Ab Brown and
Alice A. Hare personally known to me to
be the persons who executed this instrument as Mayor and City Clerk of the City
of Riverside, a municipal corporation, and acknowledged to me that the municipal
corporation executed the same.

Witness my hand and official seal.

Margaret I. Archambault
Notary Public in and for said State

0008u/m - 0277u/w

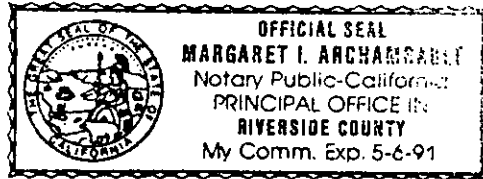

41038

PARCEL MAP NO. 21398
PMB 136/94-95
RIV. CO.

PARCEL 3

PARCEL MAP 17402
PMB 119/50-51

PARCEL 2

R/S 38/34
PARCEL 1

PARCEL 6

N00°11'20"E
332'

N00°11'20"E 251.60'

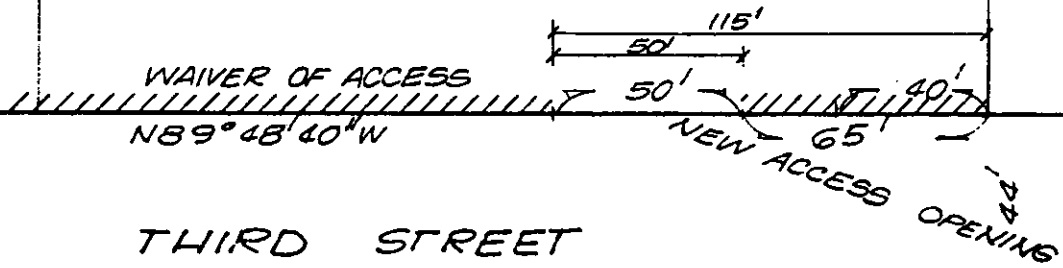

THIRD STREET

TO CHICAGO AVE.

NB9°48'40"W

REV - 11/28/88 K93

• CITY OF RIVERSIDE, CALIFORNIA •

THIS PLAT IS SOLELY AN AID IN LOCATING THE PARCEL(S) DESCRIBED IN THE ATTACHED DOCUMENT. IT IS NOT A PART OF THE WRITTEN DESCRIPTION THEREIN.

SHEET 1 OF 1

12/18-3

SCALE 1" = 50'

DRAWN BY GS DATE 12/18/87

SUBJECT PM NO. 21398, 1525 THIRD ST.

384