

299312

When recorded mail to:

City Clerk's Office
City of Riverside
City Hall, 3900 Main Street
Riverside, California 92522

RECEIVED FOR RECORD
AT 8:30 O'CLOCK A.M.
AT REQUEST OF
FIRST AMERICAN TITLE COMPANY
OF RIVERSIDE

OCT 16 1987

Recorded in Official Records
of Riverside County, California

William E. Smith
RECORDER
Fee \$ 9

FOR RECORDER'S OFFICE USE ONLY

Project: Tract 22291

GRANT DEED

TAX-NONE

9/2

FOR VALUABLE CONSIDERATION, receipt of which is hereby acknowledged, the CITY OF RIVERSIDE, a municipal corporation, does hereby grant to FILLMORE LTD., a California limited partnership, the real property in the City of Riverside, County of Riverside, State of California, described as follows:

That portion of the Riverside Water Company Canal property as described by deed recorded March 29, 1895, in Book 15, Page 405, et seq. of Deeds, records of Riverside County, California, lying within that portion of Sections 23 and 26, T.3S., R.6W, of Rancho El Sobrante of San Jacinto per map Book 1, Page 8, San Bernardino County, California, together with that portion of said canal as described in quitclaim deed recorded July 5, 1977, as Instrument No. 124803 of Official Records of said Riverside County, lying between and bounded by the following described lines:

Bounded easterly by the westerly line of Fillmore Street as shown by map of the Riverside Land and Irrigating Company, on file in Book 1 of Maps, at Page 70 thereof, records of San Bernardino County, California, and as shown by map of J. F. Moulton and H. B. Praed, on file in Book 3 of Maps, Pages 5 and 6 thereof, records of Riverside County, California;

Bounded westerly by the following described line:

COMMENCING at the southwest corner of Lot 23 of Tract No. 7503-3, as shown by map on file in Book 93 of Maps, Pages 64 through 66 thereof, records of Riverside County, California;

THENCE North 51° 48' 25" West, along the boundary of said Tract No. 7503-3, a distance of 139.31 feet to the true POINT OF BEGINNING;

THENCE South 38° 11' 35" West, 59.23 feet;

THENCE North 75° 27' 00" West, 177.61 feet to the end of this line description.

First American Title Company has recorded this instrument by request as an accommodation only and has not examined it for regularity and sufficiency or as to its effect upon the title to any real property that may be described herein.

DESCRIPTION APPROVAL 9/21/87
George P. Hutchinson by *WF*
SURVEYOR, CITY OF RIVERSIDE

299312

Dated September 25, 19 87

CITY OF RIVERSIDE,
a municipal corporation

By Ab Brown
Mayor

APPROVED AS TO FORM
Kathleen M. Grogan
ASST. CITY ATTORNEY

Attest Alice A. Hare
City Clerk

STATE OF CALIFORNIA)
COUNTY OF RIVERSIDE) ss.

On this 25th day of September, in the year 1987, before me,
Margaret I. Archambault, a Notary Public in
and for said County and State, personally appeared Ab Brown and
Alice A. Hare personally known to me to
be the persons who executed this instrument as Mayor and City Clerk of the City
of Riverside, a municipal corporation, and acknowledged to me that the municipal
corporation executed the same.

Witness my hand and official seal.

Margaret I. Archambault
Notary Public in and for said State
OFFICIAL SEAL
MARGARET I. ARCHAMBAULT
Notary Public-California
PRINCIPAL OFFICE IN
RIVERSIDE COUNTY
My Comm. Exp. 5-6-91

311.6/m - SURVEY.128/c

299312

INST. No. 124803
REC. 7/5/77, RIV. Co.

N 75° 27' 00" W, 177.64'

S 25° 11' 35" W, 50.23'
N 59° 48' 25" W, 139.31'

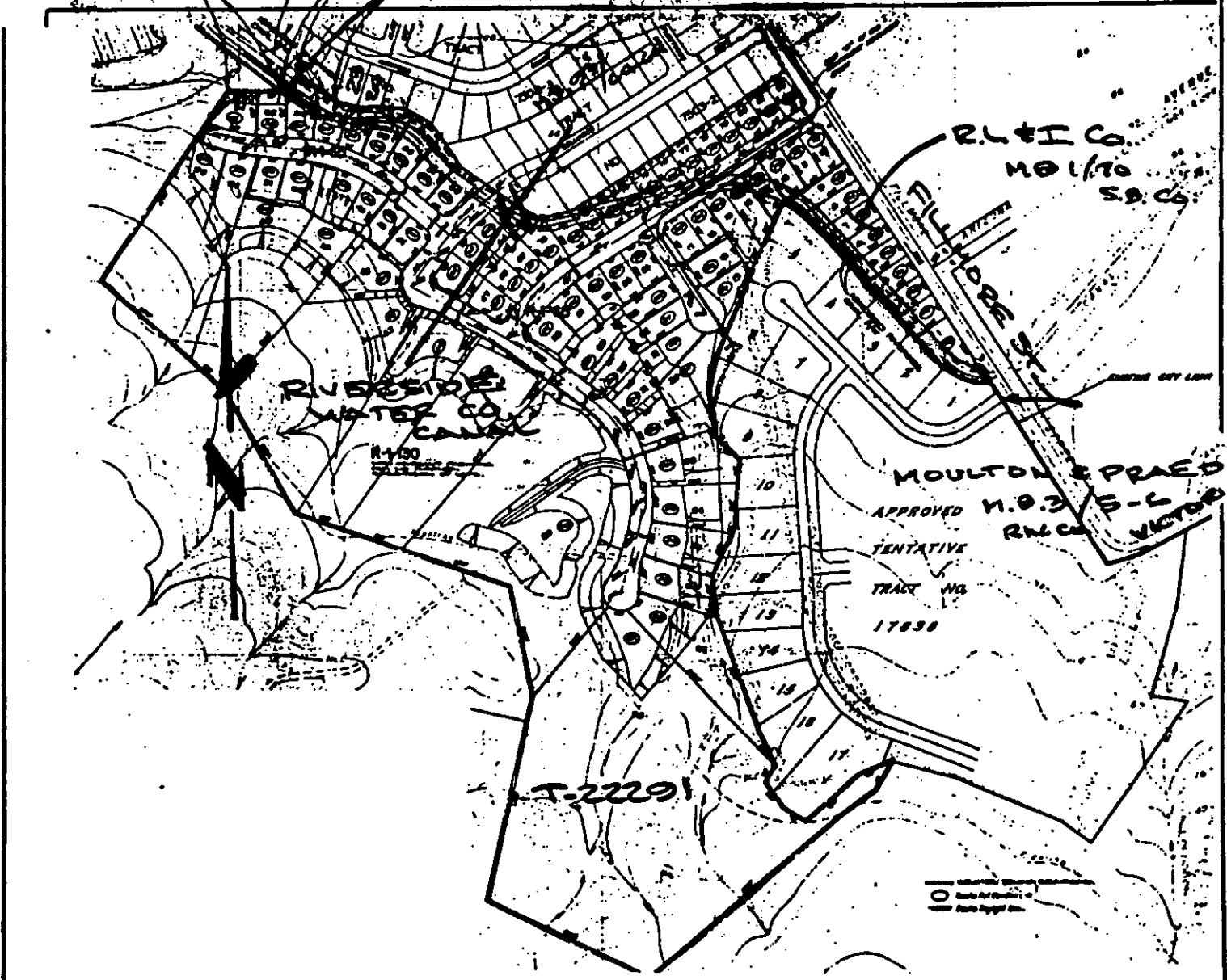

• CITY OF RIVERSIDE, CALIFORNIA •

THIS PLAT IS SOLELY AN AID IN LOCATING THE PARCEL(S) DESCRIBED IN THE ATTACHED DOCUMENT. IT IS NOT A PART OF THE WRITTEN DESCRIPTION THEREIN.	SHEET 1 OF 1	6/53 SS
SCALE: 1" = [redacted]	DRAWN BY [redacted] DATE 2/3/87	SUBJECT T-2229