

THIS INDENTURE, Made this 16th day of February, 1911,

1911, by and between Dora J. Adsit and Henry B. Adsit, her husband, and F. W. Burdell and Margaret S. Burdell, his wife, all of the City of Riverside, California, grantors, and the City of Riverside, a municipal corporation organized and existing under the laws of the State of California, grantee,

WITNESSETH:- That in consideration of the premises and other valuable considerations moving them thereto, the said grantors hereby grant to the said grantee that portion of that certain piece or parcel of land situate, lying and being in the City of Riverside, County of Riverside, State of California, and particularly described as follows, to-wit:-

A strip of land fifty (50) feet in width off the Easterly side of Lot Two Hundred Twenty (220) of the lands of the Southern California Association, as surveyed by Goldsworthy and Hieble, a plat of which survey is of record in the office of the County Recorder of the County of San Bernardino, State of California, in Book 7 of Maps at page 3 thereof.

Said portion so conveyed to said grantee is here definitely shown in the colored portion of the diagram subscribed and made a part hereof.

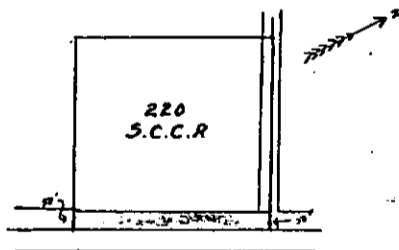

TO HAVE AND TO HOLD the same, together with its appurtenances, unto the grantee for the purposes of a public street.

IN WITNESS WHEREOF, the said grantors have hereunto set their names the day and year first above written.

Dora J. Adsit
Henry B. Adsit

F. W. Burdell

Margaret S. Burdell

State of California, }
COUNTY OF RIVERSIDE } SR.

On this 16th day of February in the year one thousand nine hundred and Eleven
before me, Martha L. Cole Notary Public in and for said County of Riverside, residing therein, duly commissioned and sworn,
personally appeared Dora J. Adsit, Henry B. Adsit, F. W. Burdell and Margaret S.
Burdell

personally known to me to be the person s described in, and whose name s are
subscribed to and who executed the within instrument, and acknowledged to me that t he y
executed the same freely and voluntarily.

In Witness Whereof, I have hereunto set my hand and official seal,
in Riverside, in the said County, the 16th day and year in this Certificate first above written.
Martha L. Cole
Notary Public in and for Riverside County, State of California.

DEED

330

from ADSIT & BURDELL

AR

to City of Riverside.

Magnolia Avenue Extension.

O.K. for description.

A. E. Campbell
City Engineer.

RECEIVED FOR RECORD

FEB 17 1911

at 41 Min. past 3 o'clock P. M. at
request of *D. G. Evans*

Copied in Book No. 329 of
Deeds page 173 of

seq., Records of Riverside County,
California.

D. S. Rogers Recorder

By _____ Deputy Recorder