

THIS INDENTURE, Made this 16th day of February, 1911, by and between Dora J. Adsit and Henry B. Adsit, her husband, and F. W. Burdell and Margaret S. Burdell, his wife, ^{a widow,} and John Dobbie, all of the City of Riverside, grantors, and the City of Riverside, a municipal corporation organized and existing under the laws of the State of California, grantees,

WITNESSETH:- That in consideration of the promises and other valuable considerations moving then thereto, the said grantors hereby grant to the said grantees that portion of that certain piece or parcel of land situate, lying and being in the City of Riverside, County of Riverside, State of California, and particularly described as follows, to-wit:-

A strip of land fifty (50) feet in width off the Westerly side of Lot Two Hundred Nineteen (219) of the lands of the Southern California Colony Association, as surveyed by Coldsworthy and Higbie, a plat of which survey is in the office of the County Recorder of the County of San Bernardino, State of California, in Book 7 of Maps at page 3 thereof.

Said portion so conveyed to said grantees is more definitely shown in the colored portion of the diagram subscribed and made a part hereof.

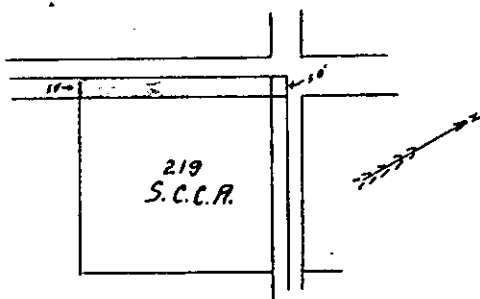

TO HAVE AND TO HOLD the same, together with its appurtenances, unto the grantees for the purposes of a public street.

IN WITNESS WHEREOF, the said grantors have hereunto set their names the day and year first above written.

Dora J. Adsit
Henry B. Adsit

F. W. Burdell

Margaret S. Burdell
John Dobbie

State of California, }
COUNTY OF RIVERSIDE } SS.

On this 16th day of February in the year one thousand nine hundred and Eleven
before me, Martha L. Cole, a Notary Public in and for said County of Riverside, residing therein, duly commissioned and sworn,
personally appeared Dora J. Adsit, Henry B. Adsit, F. W. Burdell, Margaret S.
Burdell, and John Dobbie,

personally known to me to be the person described in, and whose name is are
subscribed to and who executed the within instrument, and acknowledged to me that he
executed the same freely and voluntarily.

In Witness Whereof, I have hereunto set my hand and official seal
in Riverside, in the said County, the day and year in this Certificate first above written.

Martha L. Cole
Notary Public in and for Riverside County, State of California.

DEED 49 329

From Adsit & Burdell
& *W. O. O'Brien*

to City of Riverside.

Magnolia Avenue Extension.

O.K. for description.

O.P. Eamshell
City Engineer.

RECEIVED FOR RECORD

FEB 17 1911

at *4 1/2* Min. past *3* o'clock *P.* M. at

request of *W. O. O'Brien*

Copied in Book No. *329* of

Deeds. Page *175* etc.

seq., Records of Riverside County,
California.

D. S. Rogers Recorder

By *D. S. Rogers* Deputy Recorder