

621

BLANKET DEED

NORTH MULBERRY STREET

THIS INDENTURE, made and entered into by and between the undersigned property owners, parties of the first part, grantors, and the CITY OF RIVERSIDE, a municipal corporation, organized and existing under the laws of the State of California, party of the second part, grantee;

Witnesseth, that for and in consideration of the sum of one dollar in hand paid by the party of the second part to the said parties of the first part, the receipt of which is hereby acknowledged, by each and every one of the parties of the first part hereunto, and for other valuable considerations, the said parties of the first part do by these presents grant, bargain, sell, quit claim, convey and confirm unto the said party of the second part, and to its successors and assigns forever, all of the right, title and interest of the undersigned property owners, parties of the first part, in and to all of the certain parcels of land situate in the City of Riverside, County of Riverside, state of California, said parcels of land being described as follows, to wit;

PARCELS 1, 2, 3, and 4; The private driveway over the easterly 50 feet of the southerly rectangular 12 feet of Lot 57 of the Southern California Colony Association lands, a map of said lands being recorded in Book 7 of Maps, Page 5, records of San Bernardino County, State of California and a driveway now existing commencing at the easterly end of said driveway above described and running in a southerly and easterly direction across Lots 27 and 26 of said Southern California Colony Association lands to La Cadena Drive, said driveway across said Lots 27 and 26 being 14 feet in

CITY ATTORNEY'S OFFICE  
Riverside, California

1 width, subject to the rights of ways granted to the Crescent  
2 City Railway Company (now the Los Angeles and Salt Lake/<sup>Railroad</sup>Com-  
3 pany) and to the Southern Pacific Railroad Company.

4 PARCEL 5; The easterly rectangular 30 feet of Lot 40 of  
5 said Southern California Colony Association Lands.

6 PARCEL 6; The westerly rectangular 30 feet of Lot 39 of  
7 said Southern California Colony Association Lands.

8 PARCEL 7; The westerly rectangular 30 feet of the north-  
9 erly rectangular one-half of Lot 38 of said Southern California  
10 Colony Association Lands.

11 PARCEL 8; The westerly rectangular 30 feet of the south-  
12 erly rectangular one-half of Lot 38 of said Southern California  
13 Colony Association Lands.

14 PARCEL 9; The easterly rectangular 16 feet of the westerly  
15 rectangular 30 feet of the northerly rectangular one-half of  
16 Lot 27 of said Southern California Colony Association Lands.

17 PARCEL 10; The easterly rectangular 30 feet of the north-  
18 erly rectangular one-half of Lot 26 of said Southern Calif-  
19 ornia Colony Association Lands.

20 All of the lands hereinabove referred to are shown upon  
21 the map hereto attached and made a part hereof. Said map also  
22 shows the lands this indenture hereby conveys, each parcel  
23 hereinabove described being numbered in red ink and said num-  
24 bers are also set above the respective signatures hereinafter  
25 attached and acknowledged, to show the lands that each grantor  
26 hereby conveys.

27 Together with all and singular, the tenements, heredita-  
28 ments and appurtenances hereunto belonging, or in any wise  
29 appertaining and the reversion and reversions, remainder and  
30 remainders, rents, issues and profits thereof.

TO HAVE AND TO HOLD all and singular, the said premises,  
together with the appurtenances unto the said party of the  
second part and to its successors and

1 assigns forever.

2 IN WITNESS WHEREOF, the said parties of the first part  
3 have hereunto set their hands and seals the day and year of the  
4 acknowledgement of their respective signatures.

5 PARCELS 1, 2, 3, AND 4; \_\_\_\_\_

6 PARCEL 5; \_\_\_\_\_

7 PARCELS 6 AND 7; \_\_\_\_\_  
8 \_\_\_\_\_  
9 \_\_\_\_\_  
10 \_\_\_\_\_

11 PARCELS 8, 9, AND 10; \_\_\_\_\_

12 PARCEL 10; \_\_\_\_\_

13 *Jacob A. McMullen* *John R. McMullen*  
14 Witness to signature of *Jacob H. McMullen*  
15 *John R. McMullen*  
16 *Mary E. Fouth*

17  
18  
19 Approved as to form,

20 *M. S. [Signature]*

21 City Attorney.

22  
23  
24  
25  
26  
27  
28  
29  
30  
31  
STATE OF CALIFORNIA,  
County of San Bernardino.

STATE OF ARIZONA,  
County Yavapai. } ss.

Before me, E. A. MCSWIGGIN, a Notary Public in and  
for the County of Yavapai State of Arizona, on this day personally appeared  
H. A. MCMULLEN  
known to me to be the person whose name is subscribed to the foregoing instrument,  
and acknowledged to me that he executed the same for the purpose of and consideration  
therein expressed.

Given under my hand and seal of office, this 13th. day of June, A. D. 1919.  
(My Commission expires Dec. 7th. - 1922.)  
*E. A. McSwiggin*  
Notary Public.

No. 130—ACKNOWLEDGMENT—The McNeil Company's Red-Line Blanks. Phoenix, Arizona

6-1-13-1m

State of California, } ss.

COUNTY OF ~~KERN~~

San Bernardino May

nine hundred and ~~thirty~~ nineteen

On this 31 day of Olive Copeland in the year of our Lord one thousand ~~eight~~ hundred and ~~thirty~~ nineteen before me, ~~ALEXIS WAKSON~~ a Notary Public in and for said County and State, residing therein, duly commissioned and sworn, personally appeared Jacob H. McMullen personally known to me to be the same person whose name is subscribed to the within instrument, as a witness thereto, who, being by me duly sworn deposed and said: that he resided in Redondo Beach, Cal. that he was present and saw John R. MC Mullen

personally known to him to be the same person described in and who executed the said within instrument, as part 7 thereof, sign, seal and deliver the same; and that the said John R. McMullen

duly acknowledged in the presence of said affiant, that he executed the same, and that he the said affiant, thereupon at his request, subscribed his name as a witness thereto. IN WITNESS WHEREOF, I have hereunto set my hand and affixed my Official Seal the day and year in this certificate first above written.

*Olive Copeland*  
NOTARY PUBLIC

[Witness.]

Handwritten notes in a box on the left margin, including the word "WITNESS" and other illegible scribbles.

STATE OF CALIFORNIA, }  
County of San Bernardino, } ss.

On this 31 day of May in the year one thousand, nine hundred and nineteen  
A. D., before me, OLIVE COPELAND, a Notary Public in and for said County of San Bernardino, State of California,  
residing therein, duly commissioned and sworn, personally appeared Jacob H. McMullen and  
Mary E. Fouth

..... personally  
known to me to be the person whose name are subscribed to the within  
instrument, and acknowledged to me that the y executed the same.

In Witness Whereof, I have hereunto set my hand and affixed my official seal the  
day and year in this certificate first above written.

Olive Copeland  
Notary Public in and for San Bernardino County, State of California.  
My Commission Expires April 8, 1919.

SCALE 1 IN = 200 FT.

RUSSELL ST.

LOT 40  
SOUTHERN CALIFORNIA  
COLONY ASSOCIATION LANDS

LOT 39  
SOUTHERN CALIFORNIA  
COLONY ASSOCIATION LANDS

LOT 38  
SOUTHERN CALIFORNIA  
COLONY ASSOCIATION LANDS

NORTHERLY 1/2 OF  
LOT 27  
SOUTHERN CALIFORNIA  
COLONY ASSOCIATION LANDS

LOT 28  
SOUTHERN CALIFORNIA  
COLONY ASSOCIATION LANDS

ELLIOTT'S  
ALLEN PLACE

SUB 15 14 13 12 11 10 9 8 7 6 5 4 3 2 1

ST. HUGART'S  
HOMESTEAD TRACT  
PORTION OF  
LOT 26  
SOUTHERN CALIF  
COLONY ASS'N LANDS

ST. ANDREWS BLVD

NOLAND

PLACE

N. MULBERRY ST.

LA CADENA DRIVE

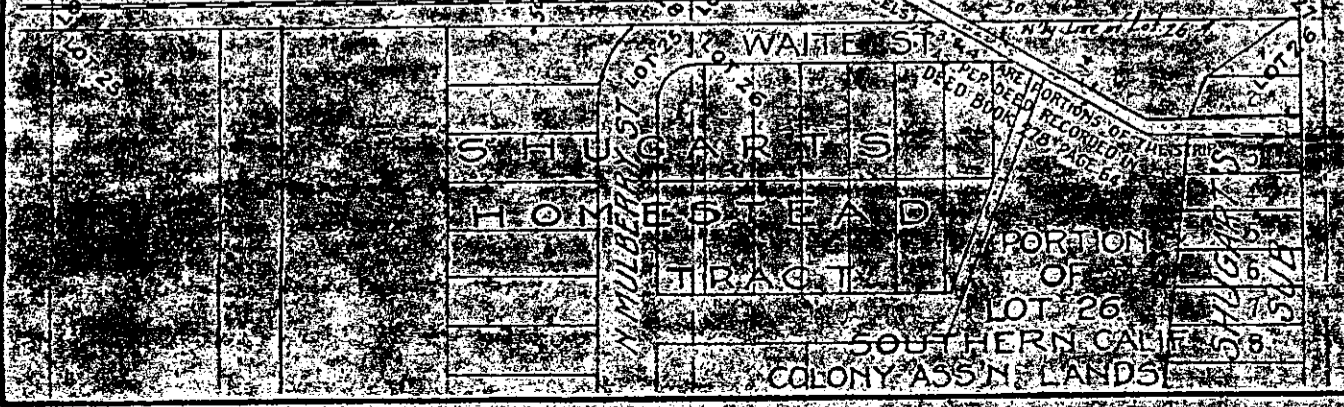
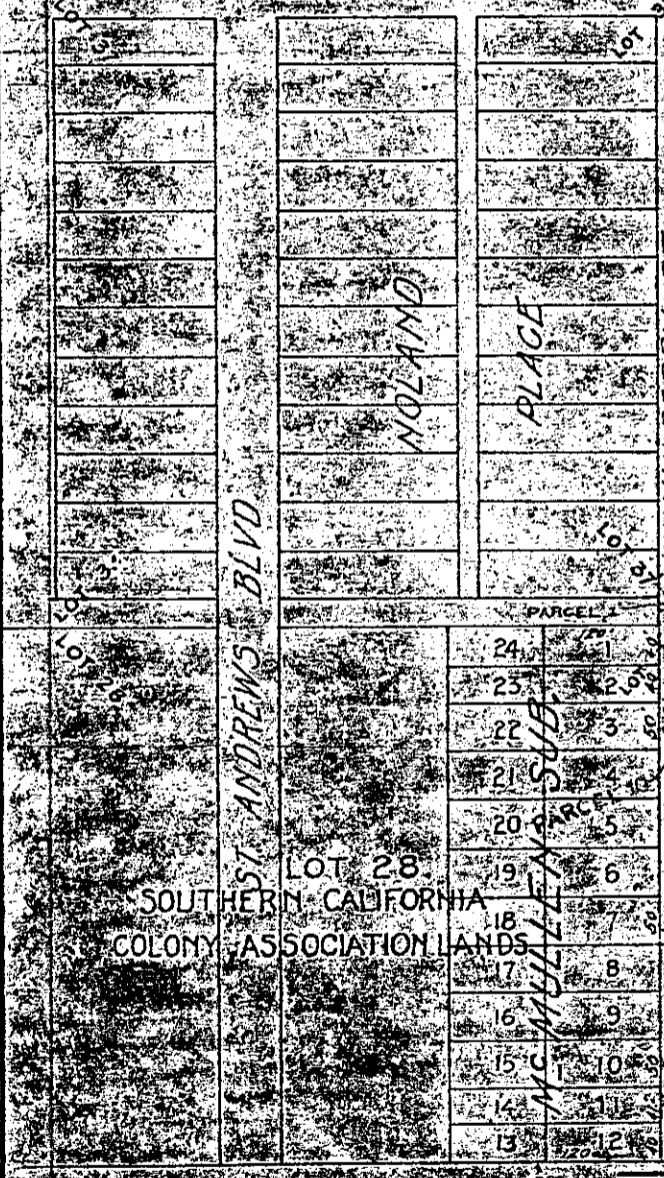

58

BLANKET DEED  
NORTH MULBERRY STREET

*MAR*

RECEIVED FOR RECORD	
JUL 9 1919	
at 27 Min, past 2 o'clock P.M.	
quest of <i>City Engineer</i>	
Copied in Book No. <i>H 94</i> of	
	page <i>111</i>
cc. Records of Riverside County,	
Calif.	
<i>Ed Quinonez</i> Recorder	
<i>W. J. [unclear]</i>	

*14*  
*map 75*

RECORDED  
INDEXED  
F. HESS

CITY OF RIVERSIDE  
OFFICE OF  
CITY ATTORNEY  
MIGUEL ESTUDILLO  
GEO. H. BUSH  
RIVERSIDE, CALIFORNIA