

DEEDS

Resolved, by the Common Council of the City of Riverside, that those certain deeds to the City of Riverside, a municipal corporation, of the County of Riverside, State of California, and covering the premises therein set forth and described as follows, to wit:

1. Deed dated April 21st, 1922, executed by Herman G. Wilson and Katy Wilson, for a strip of land ten feet in width, lying five feet on each side of a line described as follows:

Beginning at the intersection of the center line of El Prado Street, as shown on the map of the Re-subdivision of the El Prado Rancho, as recorded in map book 9, page 72, Records of Riverside County, California, with the northerly line of Magnolia Avenue; thence easterly along the northerly line of Magnolia Avenue, a distance of 957.75 feet to a point of beginning; thence northerly, parallel with the center line of El Prado Street, a distance of 122.8 feet more or less to a point on the southerly line of Arlington Avenue.

2. Deed dated April 18th, 1922, executed by Samuel Outwater, for the following described premises:

Beginning at a point in the northerly boundary line of Block 7, Range 8, of the Town, now City of Riverside, as recorded in the County Recorders office of San Bernardino, California, in Book 7 of Maps, Page 17, said point being the intersection of the northerly and southerly center line of said block, with the northerly boundary line of said block; thence easterly along said northerly boundary line $7\frac{1}{2}$ feet; thence southerly parallel with the westerly boundary line of said block to a point $7\frac{1}{2}$ feet southerly from the easterly and westerly center line of said block; thence west parallel with the northerly boundary line of said block to a point 100 feet easterly from the westerly line of said Block; thence northerly parallel with the westerly boundary line of said block, $7\frac{1}{2}$ feet; thence easterly along the easterly and westerly center line to the center said block; thence northerly along the northerly and southerly center line of said block to the northerly boundary line of said block, the point of beginning,

be and the same are hereby accepted, for the purposes and intentions as therein set forth; and

Be it further resolved, that a copy of this resolution be attached to said deeds and that the same be recorded in the office of the County Recorder of the County of Riverside, State of California, and filed in the office of the City Engineer of said City.

State of California)
County of Riverside)ss.
City of Riverside)

I, C. B. Burns, City Clerk and ex-officio Clerk of the Common Council of the City of Riverside, State of California, do hereby certify that the foregoing is a full, true and correct copy of a resolution of said Common Council adopted on the 25th day of April, 1922.

In witness whereof, I have hereunto set my hand and affixed the official seal of the City of Riverside, this 26th day of April, 1922.

Clerk of the City of Riverside

NOTARY PUBLIC
COUNTY OF RIVERSIDE
STATE OF CALIFORNIA

State of California, }
COUNTY OF RIVERSIDE } SS.

On this 25th day of Apr in the year one thousand nine hundred and
twenty-two before me, Charles E. Johnson a Notary Public, in and for said County
of Riverside, State of California, residing therein, duly commissioned and sworn, personally appeared

Herman G. Wilson & Fatsy Wilson wife

personally known to me to be the person described in and whose name is subscribed to and who executed the within instrument, and acknowledged to me that they executed the same freely and voluntarily.

In Witness Whereof, I have hereunto set my hand and Official Seal at my office in Riverside, in the said County the day and year in this Certificate first above written.

Charles E. Johnson
Notary Public in and for Riverside County, State of California

[GENERAL—Walter D. Clark, Printer, 3m 1 18]

GRANT OF RIGHT-OF-WAY.

WE, HERMAN G. WILSON and KATY WILSON,

and each of us, grant to the CITY OF RIVERSIDE, a Municipal Corporation of the State of California, an EASEMENT OF RIGHT-OF-WAY for the construction and maintenance of a storm conduit over and through the following described premises, situate in the City of Riverside, County of Riverside, State of California, and described as follows, to-wit:

A strip of land ten-feet in width, lying five feet on each side of a line described as follows:

Beginning at the intersection of the center line of El Padro Street, as shown on the map of the Re-Subdivision of the El Padro Ranch, as recorded in map book 9, page 72, Records of Riverside County, California, with the northerly line of Magnolia Avenue; thence easterly along the northerly line of Magnolia Avenue, a distance of 957.75 feet to a point of beginning; thence northerly, parallel with the center line of El Padro Street, a distance of 122.8 feet more or less to a point on the southerly line of Arlington Avenue.

WITNESS our hands this 21st day of April, 1922.

Herman G. Wilson

Katy Wilson

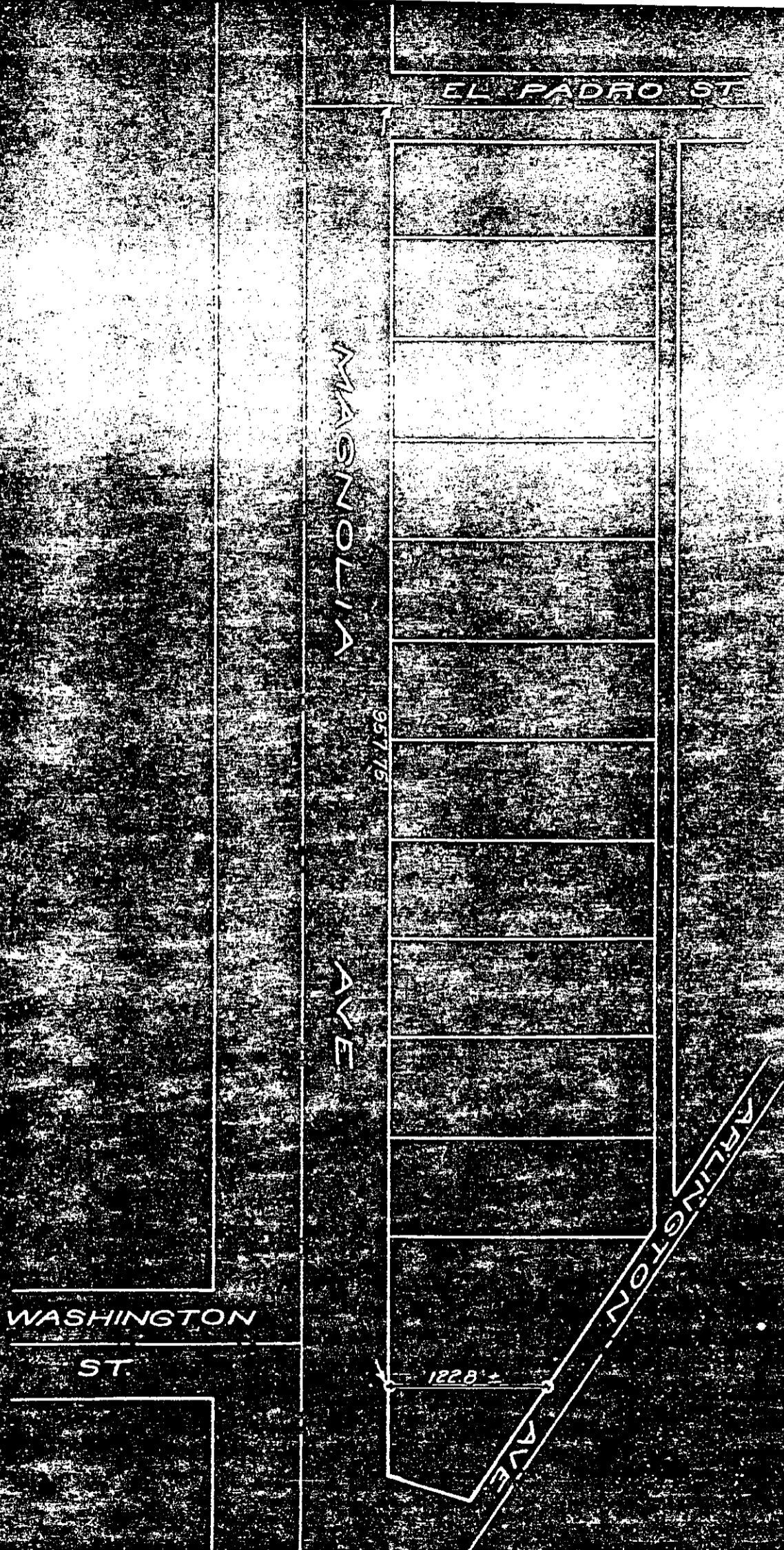

City Engineer

RECEIVED FOR RECORD	
APR 28 1922	
# 30	City Clerk
PAID TO BANK	116
Board of Riverside County	
<i>Henriette</i>	
None	

Approved at 40
 George A. Burch
 City Attorney

CC. HESS

M. HESS

E. KETTERING