

When recorded mail to:

City Clerk's Office
City of Riverside
City Hall, 3900 Main Street
Riverside, California 92522

FREE RECORDING

This instrument is for the benefit of the City of Riverside and is entitled to be recorded without fee. (Government Code 6103)

RECEIVED FOR RECORD
50 Min. Past 3 o'clock P.M.
At Request of
City Clerk

Book 1987, Page 209920

DEC 3 1982

Recorded in Official Records
of Riverside County, California

William J. Parnley
Recorder
Fees \$

209920

FOR RECORDER'S OFFICE USE ONLY

Project: Van Buren Boulevard Widening
Parcel 9

SLOPE EASEMENT

10459

FOR VALUABLE CONSIDERATION, receipt of which is hereby acknowledged,
EMMA MORROW, a widow,

as Grantor__, grant(s) to the CITY OF RIVERSIDE, a Municipal Corporation of the State of California, as Grantee, its successors and assigns, a perpetual easement and right of way for roadway slope and support purposes, in, on, under, through, over and along that certain real property situated in the City of Riverside, County of Riverside, State of California, described as follows:

A strip of land 2.00 feet in width over a portion of the S $\frac{1}{2}$ of the SE $\frac{1}{4}$ of the NE $\frac{1}{4}$ of the SE $\frac{1}{4}$ of Section 1, T. 3 S., R. 6 W., S.B.M., more particularly described as follows:

COMMENCING at the northeasterly corner of that certain parcel of land conveyed to the City of Riverside, by deed recorded November 18, 1966, as Instrument No. 112302 of Official Records of said Riverside County; said corner being in the line which is parallel with and distant 40.00 feet west, as measured at right angle, from the east line of Section 1;

THENCE North along said parallel line 135 feet to a point in the north line of that certain parcel of land conveyed to Gustav G. Kuhn, et ux., by deed recorded October 2, 1968, as Instrument No. 94990 of Official Records of said Riverside, County;

THENCE West along said north line 7.00 feet to a line which is parallel with and distant 47.00 feet west, as measured at right angle, from said east line of Section 1, and to the true point of beginning;

THENCE North along said parallel line 70 feet to the south line of that certain parcel of land conveyed to Le Roy Bain, et ux, by deed recorded June 15, 1977, as Instrument No. 227370 of Official Records of said Riverside County;

THENCE West along said south line 2.00 feet to a line which is parallel with and distant 49.00 feet west, as measured at right angle, from said east line of Section 1;

THENCE South along said parallel line 70 feet to said north line of said parcel so conveyed to Gustav G. Kuhn, et ux.;

209920

THENCE East along said north line 2.00 feet to said true point of beginning.

Area - 140 square feet.

DESCRIPTION APPROVAL
George Hutchison 3/24/82
Surveyor

Said slope and support easement is to be used for all purposes proper and convenient in the construction, reconstruction and maintenance of road-

STATE OF: CALIFORNIA
COUNTY OF RIVERSIDE

} ss.

On this 23 day of NOVEMBER, in the year 1982, before me, the undersigned, a Notary Public, in and for said State, personally appeared RONALD W. BRALEY, known to me (or proved to me on the oath of

to be the person whose name is subscribed to the within Instrument, as a Witness thereto, who being by me duly sworn, deposes and says: That this witness resides in RIVERSIDE COUNTY and that this witness was present and saw EMMA MORROW

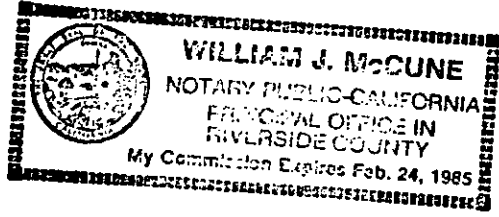

personally known to the said witness to be the same person described in and whose name is subscribed to the within and annexed Instrument as a Party thereto, execute and deliver the same, and SHE acknowledged to said affiant that SHE executed the same; and that said affiant subscribed HIS name thereto as a witness. WITNESS my hand and official seal.

William J. McCune
Notary Public in and for said State.

Witness: Ronald W. Braley

APPROVED AS TO FORM
Ronald M. Christian
SENIOR DEPUTY CITY ATTORNEY

CONSENT TO RECORDATION

THIS IS TO CERTIFY that the interest in real property conveyed by this instrument to the City of Riverside, a Municipal Corporation, is hereby accepted for and on behalf of said City pursuant to Resolution of the City Council thereof recorded on 12-29-66 as Inst. No. 123460, Riverside County Records, and the Grantee hereby consents to recordation of this instrument through the undersigned.

Dated _____
Property Services Manager

209920

THENCE East along said north line 2.00 feet to said true point of beginning.

Area - 140 square feet.

DESCRIPTION APPROVAL
By George Hutchinson 3/24/82
Surveyor

Said slope and support easement is to be used for all purposes proper and convenient in the construction, reconstruction and maintenance of roadway slopes and supports, including the rights of ingress and egress, the temporary deposit of tools, equipment, machinery, vehicles, materials and supplies used in the performance of said work, and for similar and related purposes by the City of Riverside, its officers, employees, agents or contractors.

Provided, however, that the Grantor(s) reserve(s) the right of use and enjoy the land over which said easement and right of way is granted, for any purpose and in any manner which does not interfere with or impair the right of the Grantee to use said easement and right of way.

Dated November 22, 1982

Emma Morrow
EMMA MORROW

Witness: Ronald M. Clouston

APPROVED AS JO FORM
Ronald M. Clouston
SENIOR DEPUTY CITY ATTORNEY

CONSENT TO RECORDATION

THIS IS TO CERTIFY that the interest in real property conveyed by this instrument dated 11-22-82 from Emma Morrow

for 2 1/4 Strip over Por of S 1/2 of SE 1/4 of NE 1/4 of SE 1/4 Sec 1 T3S R6W S87N to the City of Riverside, a Municipal Corporation, is hereby accepted for and on behalf of said City pursuant to Resolution of the City Council thereof, recorded on January 7, 1982, as Instrument No. 3490 of Official Records of Riverside County, and the grantee hereby consents to recordation of this instrument through the undersigned duly authorized officer.

Dated 12-3-82

[Signature]
Assistant City Manager

10459

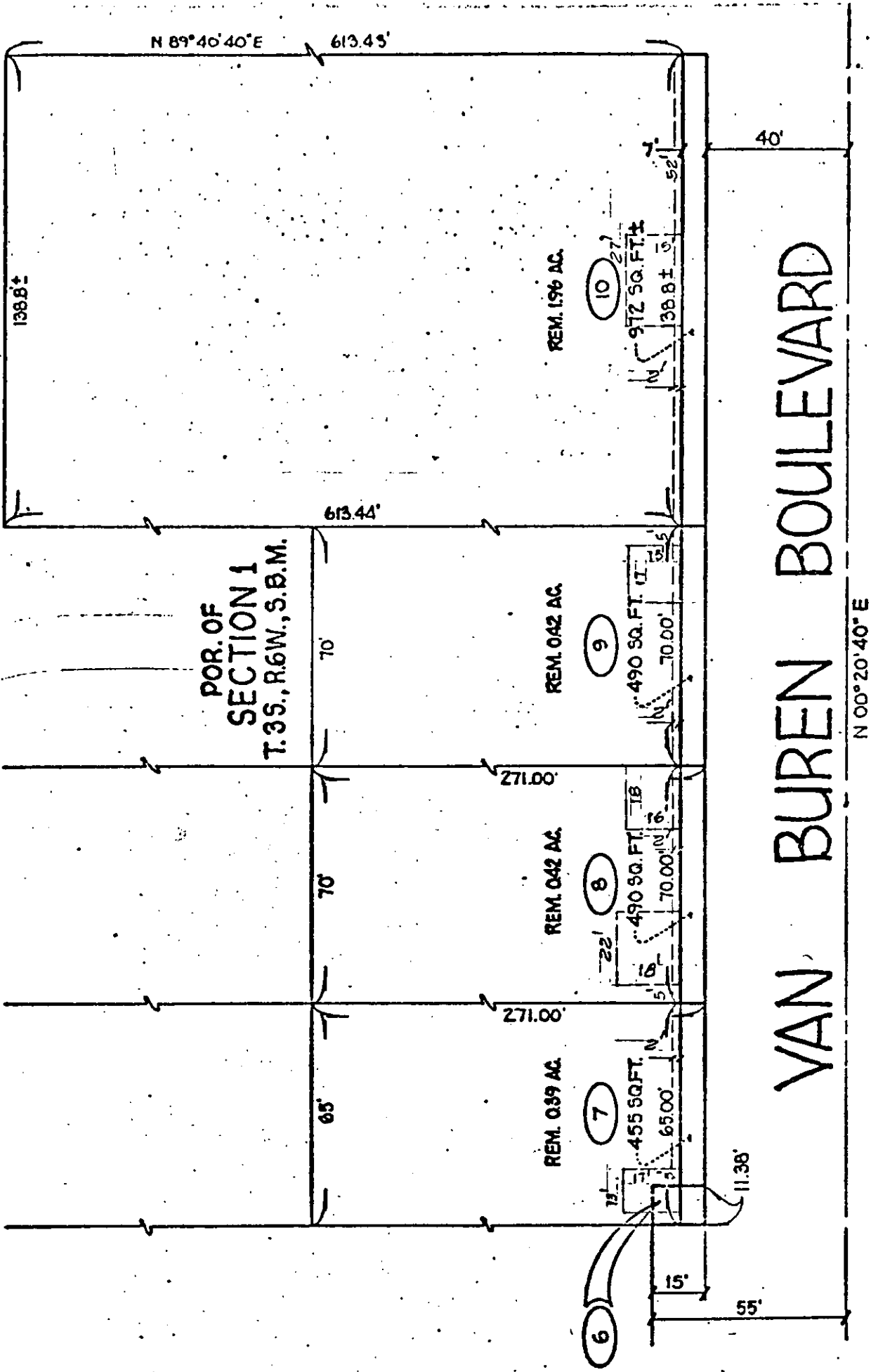

POR. OF
SECTION 1
T.35. R.6W., S.B.M.

VAN BUREN BOULEVARD

N 00° 20' 40" E

• CITY OF RIVERSIDE, CALIFORNIA •

THIS PLAT IS SOLELY AN AID IN LOCATING THE PARCEL(S) DESCRIBED IN THE ATTACHED DOCUMENT. IT IS NOT A PART OF THE WRITTEN DESCRIPTION THEREIN.

SHEET 5 OF 18

SCALE: 1" = 40'

DRAWN BY J.K. DATE 6/24/60

SUBJECT VAN BUREN BLYD. WIDENING

10459