

51623

When recorded mail to:
City Clerk's Office
City of Riverside
City Hall, 3900 Main Street
Riverside, California 92522

RECEIVED FOR RECORD
30 Min. Past 3 o'clock P.M.
At Request of
CITY CLERK
Book 1983, Page 51623

MAR 18 1983

Recorded in Official Records
of Riverside County, California

William S. Corby
Recorder
Fees \$

FREE RECORDING

This instrument is for the benefit of the City of Riverside and is entitled to be recorded without fee. (Government Code 6103)

FOR RECORDER'S OFFICE USE ONLY

Project: Van Buren Boulevard Widening
Parcel 8 10543

SLOPE EASEMENT

FOR VALUABLE CONSIDERATION, receipt of which is hereby acknowledged,
GUSTAV G. KUHN and ERNA M. KUHN, husband and wife as joint tenants, as to an undivided $\frac{2}{3}$ interest, and GEORGE A. PONTEFRACT, an unmarried man as to an undivided $\frac{1}{3}$ interest,

as Grantors, grant(s) to the CITY OF RIVERSIDE, a Municipal Corporation of the State of California, as Grantee, its successors and assigns, a perpetual easement and right of way for roadway slope and support purposes, in, on, under, through, over and along that certain real property situated in the City of Riverside, County of Riverside, State of California, described as follows:

A strip of land 2.00 feet in width over a portion of the S $\frac{1}{2}$ of the SE $\frac{1}{4}$ of the NE $\frac{1}{4}$ of the SE $\frac{1}{4}$ of Section 1, T. 3 S., R. 6 W. S.B.M., more particularly described as follows:

COMMENCING at the northeasterly corner of that certain parcel of land conveyed to the City of Riverside, by deed recorded November 18, 1966, as Instrument No. 112302 of Official Records of said Riverside County; said corner being in the line which is parallel with and distant 40.00 feet west, as measured at right angle, from the east line of said Section 1;

THENCE North along said parallel line 65 feet to a point in the north line of that certain parcel of land conveyed to Vincent O. Arellano, et ux., by deed recorded October 4, 1950, in Book 1209, Page 122 of Official Records of said Riverside County;

THENCE West along said north line a distance of 7.00 feet to a line which is parallel with and distant 47.00 feet west, as measured at right angle, from said east line of Section 1, and to the true point of beginning;

THENCE North along said parallel line 70.00 feet to the south line of that certain parcel of land conveyed to L. M. Morrow, et ux., by deed recorded September 8, 1950 in Book 1203, Page 115 of Official Records of said Riverside County;

THENCE West along said south line 2.00 feet to a line which is parallel with and distant 49.00 feet west, as measured at right angle, from said east line of Section 1;

THENCE South along said parallel line 70.00 feet to said north line of said parcel of land so conveyed to Vincent O. Arellano, et ux.;

51623

THENCE East along said north line 2.00 feet to said true point of beginning.

Area - 140 square feet.

DESCRIPTION APPROVAL
George A. Pontefract
Surveyor

Said slope and support easement is to be used for all purposes proper and convenient in the construction, reconstruction and maintenance of roadway slopes and supports, including the rights of ingress and egress, the temporary deposit of tools, equipment, machinery, vehicles, materials and supplies used in the performance of said work, and for similar and related purposes by the City of Riverside, its officers, employees, agents or contractors.

Provided, however, that the Grantor(s) reserve(s) the right of use and enjoy the land over which said easement and right of way is granted, for any purpose and in any manner which does not interfere with or impair the right of the Grantee to use said easement and right of way.

Dated JANUARY 3RD 1983

Witness: *Khalil Berkeley*

Gustav G. Kuhn
GUSTAV G. KUHN

Erna M. Kuhn
ERNA M. KUHN

George A. Pontefract
GEORGE PONTEFRACT

APPROVED AS TO FORM
Ronald M. Christian
SENIOR DEPUTY CITY ATTORNEY

CONSENT TO RECORDATION

THIS IS TO CERTIFY that the interest in real property conveyed by this instrument dated 1/3/83 from Gustav G. Kuhn & Erna M. Kuhn, and George A. Pontefract for 2 ft strip over Por of S 1/2 of SE 1/4 of NE 1/4 of SE 1/4 Sec 1 T 33 R 6 W 38 N to the City of Riverside, a Municipal Corporation, is hereby accepted for and on behalf of said City pursuant to Resolution of the City Council thereof, recorded on January 28, 1983, as Instrument No. 18154 of Official Records of Riverside County, and the grantee hereby consents to recordation of this instrument through the undersigned duly authorized officer.

Dated 3/18/83

William J. [Signature]
Real Property Services Manager

10543

51623

51623

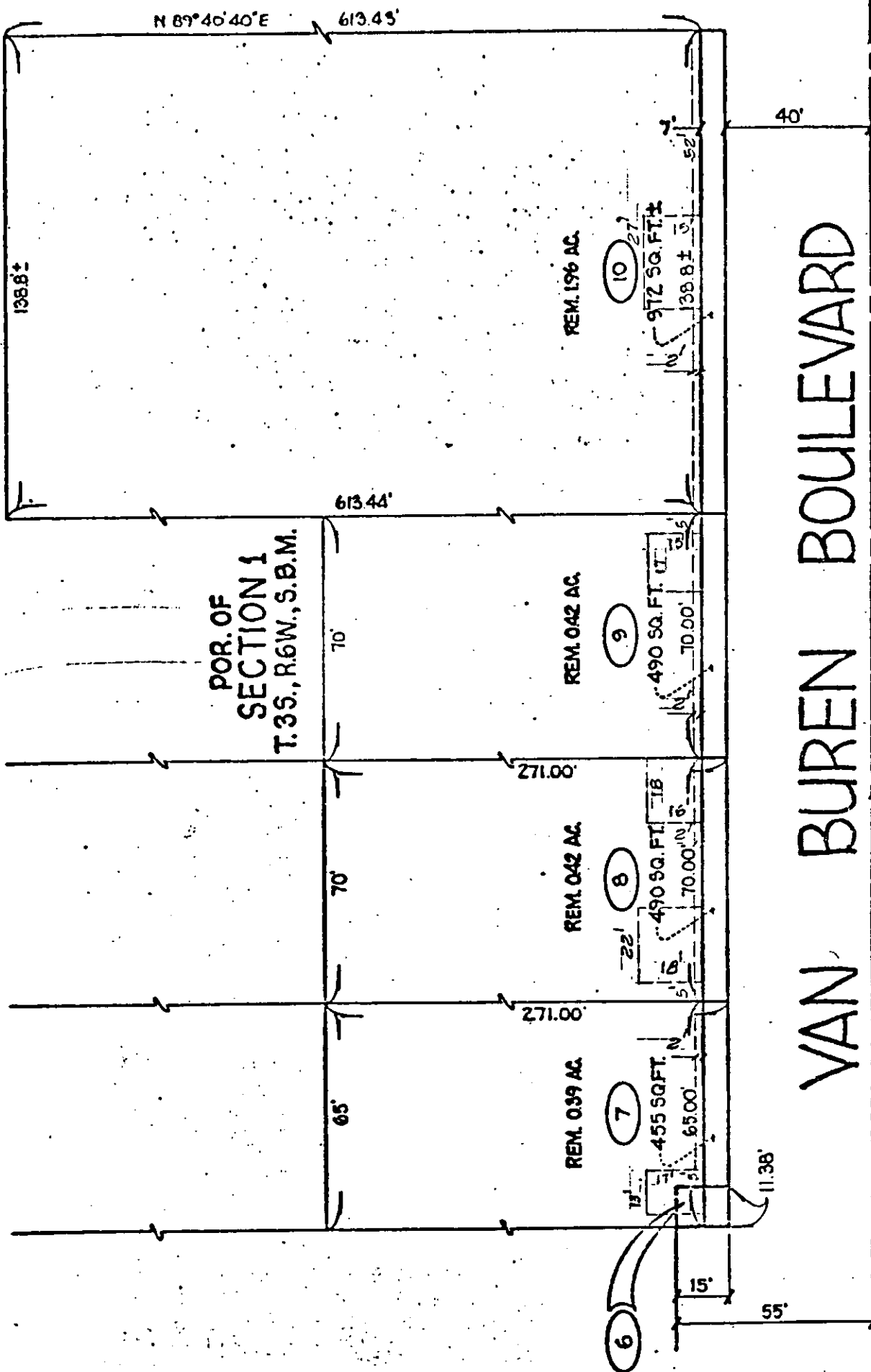

• CITY OF RIVERSIDE, CALIFORNIA •

THIS PLAT IS SOLELY AN AID IN LOCATING THE PARCEL(S) DESCRIBED IN THE ATTACHED DOCUMENT. IT IS NOT A PART OF THE WRITTEN DESCRIPTION THEREIN.

SHEET 5 OF 18

LP/16-1

SCALE: 1" = 40'

DRAWN BY J.K. DATE 6/23/80

SUBJECT VAN BUREN BLVD. WIDENING

10543