

When recorded mail to:

City Clerk's Office
City of Riverside
City Hall, 3900 Main Street
Riverside, California 92522

76696

FREE RECORDING
This instrument is for the benefit
of the City of Riverside and is
entitled to be recorded without
fee. (Government Code 6103)

RECEIVED FOR RECORD
At Request of
City Clerk
Book 1984, Page

76696
APR 13 1984

Recorded in Official Records
of Riverside County, California

Recorder
Fees \$

FOR RECORDER'S OFFICE USE ONLY

Project: Van Buren Boulevard Widening
Parcel 10

TEMPORARY CONSTRUCTION EASEMENT 10835

FOR VALUABLE CONSIDERATION, receipt of which is hereby acknowledged,
LE ROY BAIN and JEAN H. BAIN, husband and wife, as joint tenants,

as Grantors, grant to the CITY OF RIVERSIDE, a Municipal Corporation of
the State of California, as Grantee, its successors and assigns, a temporary
easement and right of way for the construction and installation of
a driveway approach

together with all necessary appurtenances, in, under, upon, over and along
that certain real property situated in the City of Riverside, County of
Riverside, State of California, described as follows:

That portion of the S 1/2 of the SE 1/4 of the NE 1/4 of the SE 1/4
of Section 1, T. 3 S., R. 6 W., San Bernardino Meridian, more
particularly described as follows:

COMMENCING at the northeast corner of that certain parcel of
land conveyed to the City of Riverside by deed recorded
November 18, 1966 as Instrument No. 112302 of Official Records
of said Riverside County; said corner being in a line which
is parallel with and distant 40 feet west, as measured at
right angle, from the east line of said Section 1;

THENCE North along said parallel line 264.80 feet;

THENCE West at right angle 7.00 feet to a line which is
parallel with and distant 47.00 feet west, as measured at
right angle, from said east line of Section 1, and to the
true point of beginning;

THENCE continuing west at right angle 15.00 feet;

THENCE North at right angle 27.00 feet;

THENCE East at right angle 15.00 feet to said parallel line
which is parallel with and distant 47.00 feet west, as
measured at right angle, from said east line of Section 1;

THENCE South along said parallel line 27.00 feet to said
true point of beginning.

Area - 405 square feet.

DESCRIPTION APPROVAL
Survivor

STATE OF CALIFORNIA

COUNTY OF San Diego

} ss.

On this 5th day of April, in the year 1984, before me, the undersigned, a Notary Public in and for said State, personally appeared Le Roy Bain and Jean H. Bain

_____, personally known to me (or proved to me on the basis of satisfactory evidence) to be the persons whose names are subscribed to the within instrument, and acknowledged to me that the y executed it.

WITNESS my hand and official seal.

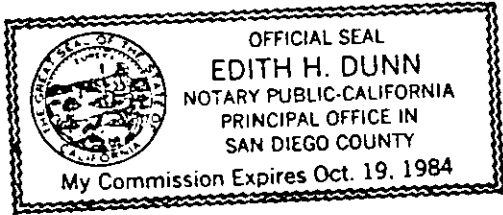

Edith H. Dunn

Notary Public in and for said State.

ACKNOWLEDGMENT—General—Wolcotts Form 233CA—Rev. 5-82 ©1982 WOLCOTTS, INC.

Said temporary construction easement is to be used for all purposes proper and convenient in the construction and installation of _____ a driveway approach _____, including the rights of ingress and egress, the temporary deposit of tools, equipment, machinery, vehicles, materials and supplies used in the performance of said work, and for similar and related purposes by the City of Riverside, its officers, employees, agents or contractors.

Upon completion of construction, the City of Riverside shall remove all debris, waste or excess material, brush or other matter of material deposited or placed upon the land, and with the exception of vegetation, return the surface as near as possible to its condition before construction.

This construction easement shall terminate upon completion of the work of constructing the _____ driveway approach _____ or within one year of the date of recording this document, whichever occurs first.

Dated 5 APR 84

Le Roy Bain
LE ROY BAIN

APPROVED AS TO FORM
Clarice Turney
ASST. CITY ATTORNEY

Jean H. Bain
JEAN H. BAIN

CONSENT TO RECORDATION

THIS IS TO CERTIFY that the interest in real property conveyed by the within instrument to the City of Riverside, California, a municipal corporation, is hereby accepted by the undersigned officer on behalf of the City Council of said City pursuant to authority conferred by Resolution No. 14933 of said City Council adopted on January 25, 1983, and the grantee consents to the recordation thereof by its duly authorized officer.

Dated 4/13/84

[Signature]
Property Services Manager
Title

76696

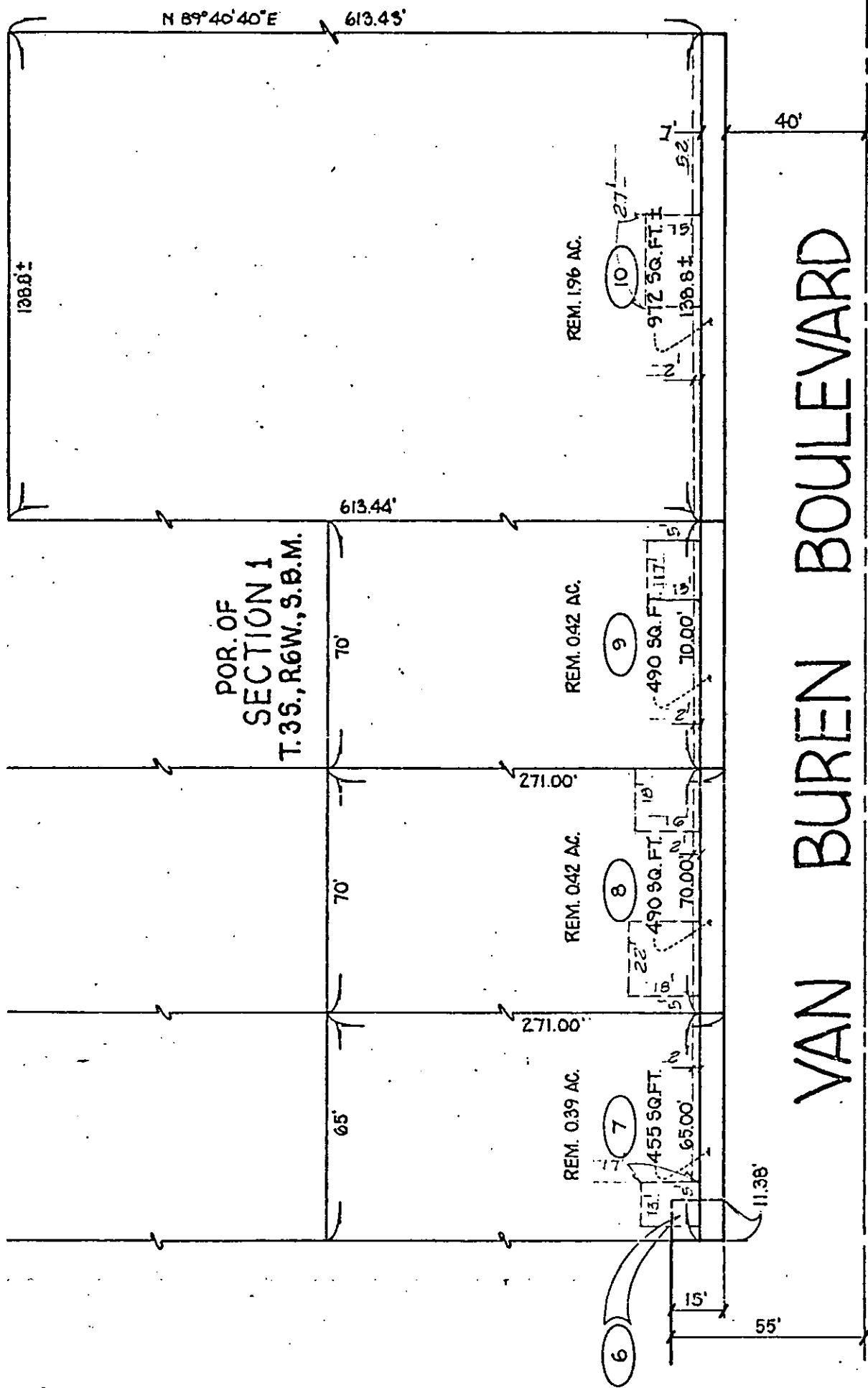

POR. OF
SECTION 1
T.35., R.6W., S.B.M.

VAN BUREN BOULEVARD

• CITY OF RIVERSIDE, CALIFORNIA •

THIS PLAT IS SOLELY AN AID IN LOCATING THE PARCEL(S) DESCRIBED IN THE ATTACHED DOCUMENT. IT IS NOT A PART OF THE WRITTEN DESCRIPTION THEREIN.

SHEET 5 OF 18

SCALE: 1" = 40'

DRAWN BY SK. DATE 6/24/80

SUBJECT VAN BUREN BOULEVARD WID.