

When recorded mail to:

City Clerk's Office
City of Riverside
City Hall, 3900 Main Street
Riverside, California 92522

142149

FREE RECORDING

This instrument is for the benefit of the City of Riverside and is entitled to be recorded without fee. (Government Code 6103)

RECEIVED FOR RECORD
5 Min. Past 2 o'clock P.M.
At Request of
City Clerk
Book 1984, Page 142149

JUN 29 1984

Recorded in Official Records
of Riverside County, California

William E. Egan
Recorder
Fees \$

Project: Parcel Map 20,000

FOR RECORDER'S OFFICE USE ONLY

E A S E M E N T

10895

FOR VALUABLE CONSIDERATION, receipt of which is hereby acknowledged, GEORGE R. SMITH and FLORENCE SMITH, Co-Trustees of the Smith Family Trust under Declaration of Trust dated February 18, 1982,

as Grantors, grant to the CITY OF RIVERSIDE, a Municipal Corporation of the State of California, as Grantee, its successors and assigns, a perpetual easement and right of way for the construction, reconstruction, maintenance, operation, inspection, repair, replacement, relocation, renewal and removal of waterline facilities

together with all necessary appurtenances, in, under, upon, over and along that certain real property situated in the City of Riverside, County of Riverside, State of California, described as follows:

A strip of land 10.00 feet wide lying within Parcels 1 and 2 of Parcel Map 15406 as shown by map on file in Book 80 of Parcel Maps, at Pages 6 and 7, records of Riverside County, California, lying 5.00 feet on each side of the following described centerline:

COMMENCING at the most northerly corner of Parcel 2 of said Parcel Map 15406;

THENCE South 55° 41' 45" West, 65.00 feet;

THENCE North 34° 18' 15" West, 13.00 feet;

THENCE South 55° 41' 45" West, 42.94 feet; the preceding three courses being along the northerly boundary of said Parcel 2;

THENCE North 34° 18' 15" West, 19.22 feet to a point in the southeasterly boundary of Parcel 1 of that certain waterline easement conveyed to the City of Riverside by documents recorded May 4, 1973 as Instrument Numbers 58113 and 58114 of Official Records of Riverside County, California;

THENCE South 55° 40' 25" West, along said southeasterly boundary, 5.00 feet to the true point of beginning of this centerline description;

THENCE South 34° 18' 15" East, 65.00 feet to the end of this centerline description.

The sidelines of said easement shall be lengthened or shortened so as to terminate northerly in said southeasterly boundary of said waterline easement conveyed to the City of Riverside, May 4, 1973.

DESCRIPTION APPROVAL
by [Signature]
6/19/84

TOGETHER WITH the right to clear and keep clear said easement and right of way from any structures or trees, to enter upon and to pass and repass over and along said real property, and to deposit tools, implements and other material thereon by Grantee, its officers, agents and employees and by persons under contract with said Grantee and their officers, agents and employees, whenever and wherever necessary for the purpose of constructing, reconstructing, maintaining, operating, inspecting, repairing, replacing, relocating, renewing and removing said waterline facilities

_____. Provided, however, that the Grantor reserves the right to use and enjoy the land over which said easement and right of way is granted, or any purpose and in any manner which does not interfere with or impair the right of the Grantee to use said easement and right of way.

Dated 6-22-84

GEORGE R. SMITH and FLORENCE SMITH, Co-Trustees of the Smith Family Trust under Declaration of Trust dated February 18, 1982,

George R. Smith
GEORGE R. SMITH
Florence Smith
FLORENCE SMITH

APPROVED AS TO FORM

Carolyn Confer 6-26-84
SENIOR DEPUTY CITY ATTORNEY

CONSENT TO RECORDATION

THIS IS TO CERTIFY that the interest in real property conveyed by the within instrument to the City of Riverside, California, a municipal corporation, is hereby accepted by the undersigned officer on behalf of the City Council of said City pursuant to authority conferred by Resolution No. 14883 of said City Council adopted on January 25, 1983, and the grantee consents to the recordation thereof by its duly authorized officer.

Dated 6/29/84

[Signature]
Property Services Manager
Title

142149

STATE OF CALIFORNIA }
COUNTY OF Los Angeles } ss.

On this 22nd day of June, 1984,

before me, the undersigned, a Notary Public in and for said State, personally appeared GEORGE R. SMITH and FLORENCE SMITH, personally known to me (or proved to me on the basis of satisfactory evidence) to be the persons who executed the within instrument, and known to me to be the Co-Trustees of THE SMITH FAMILY TRUST under declaration of Trust dated February 18, 1982, and acknowledged to me that they executed the within instrument in their capacity as Trustees of said trust.

WITNESS my hand and official seal.



Carole L. Maynard
Notary Public in and for said State

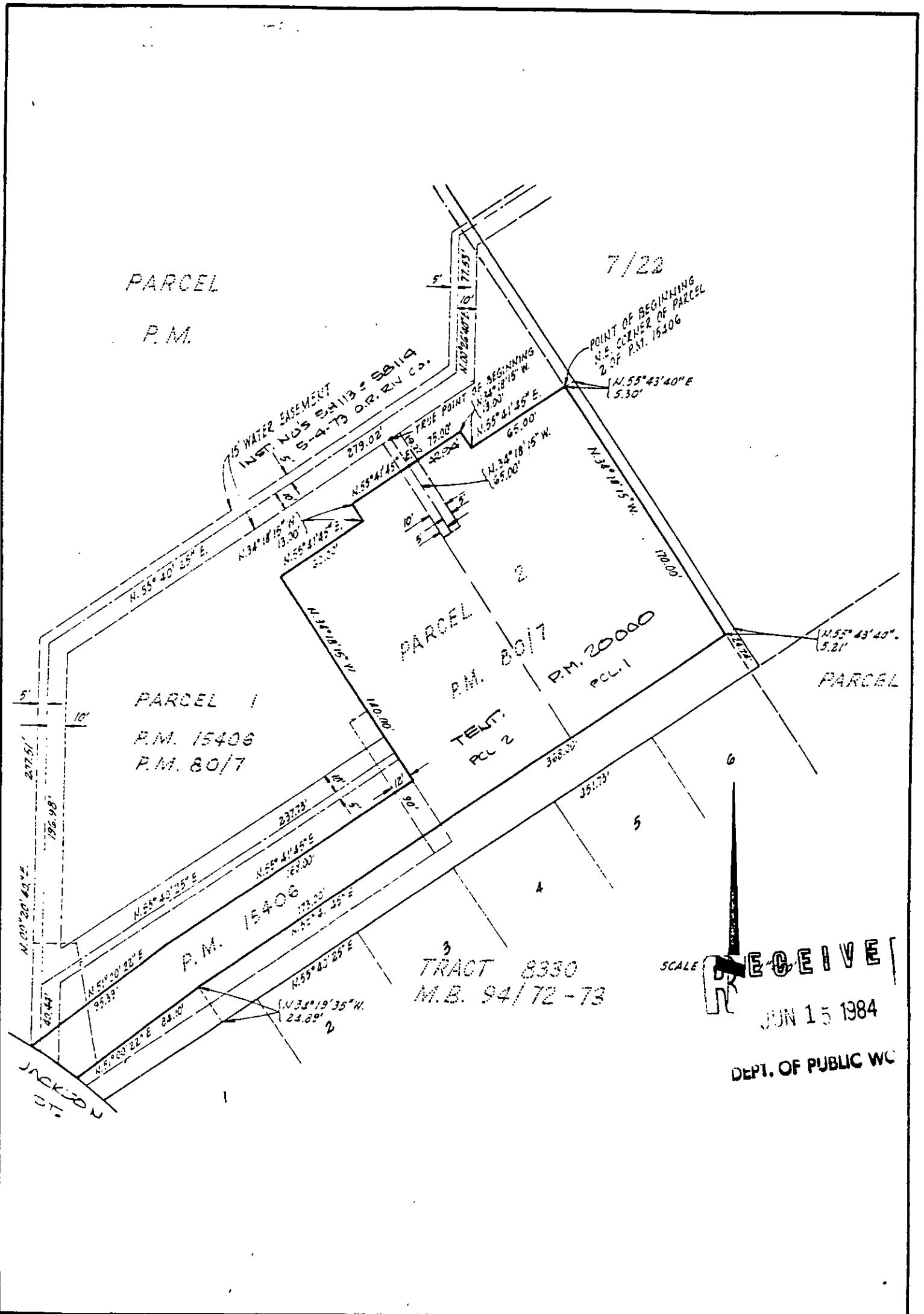

SCALE **RECEIVED**
 JUN 15 1984
 DEPT. OF PUBLIC WC

• CITY OF RIVERSIDE, CALIFORNIA •

THIS PLAT IS SOLELY AN AID IN LOCATING THE PARCEL(S) DESCRIBED IN THE ATTACHED DOCUMENT. IT IS NOT A PART OF THE WRITTEN DESCRIPTION THEREIN.		SHEET <u>1</u> OF <u>1</u>
SCALE: 1" = NONE	DRAWN BY <u>WF</u> DATE <u>6/18/84</u>	SUBJECT <u>P.M. 20000 WATERLINE ESMNT</u>