

When recorded mail to

City Clerk's Office  
City of Riverside  
City Hall, 3900 Main Street  
Riverside, California 92522

142151

FREE RECORDING

This instrument is for the benefit of the City of Riverside and is entitled to be recorded without fee. (Government Code 6103)

RECEIVED FOR RECORD

45 Min. Past 2 o'clock

At Request of

City Clerk

Book 1984, Page 142151

JUN 29 1984

Recorded in Official Records of Riverside County, California

William S. Conroy  
Recorder

Fees \$

FOR RECORDER'S OFFICE USE ONLY

Project: La Sierra Avenue Widening  
Parcel 134

10897

GRANT DEED

NICK J. FULGENZI and JEAN F. FULGENZI, husband and wife, as joint tenants,

Grantor<sub>s</sub>,

FOR A VALUABLE CONSIDERATION, receipt of which is hereby acknowledged, do \_\_\_ hereby grant to the CITY OF RIVERSIDE, a Municipal Corporation, the real property in the City of Riverside, County of Riverside, State of California, described as follows:

A portion of the vacated northeasterly 40.00 feet of LA SIERRA AVENUE, Lot "0" of Tract No. 2 of LA SIERRA HEIGHTS, on file in Book 7 of Maps, at Page 66 thereof, records of said Riverside County, more particularly described as follows:

BEGINNING at the intersection of the southwesterly line of said vacated northeasterly 40.00 feet with the southwesterly prolongation of the northwesterly line of Lot 6 in Block C of HOLDEN AVENUE TRACT, on file in Book 11 of Maps, at Page 67 thereof, records of said Riverside County;

THENCE South 23° 13' 30" East, along said southwesterly line of the vacated northeasterly 40.00 feet, a distance of 183.25 feet to the most westerly corner of that certain parcel of land conveyed to Thomas O. Reed, et ux., by deed recorded February 21, 1946, in Book 734 of Official Records, Page 81, et seq., records of said Riverside County;

THENCE North 63° 35' 19" East, along the northwesterly line of said parcel, 6.01 feet to a linewhich is parallel with and distant 26.00 feet northeasterly, as measured at right angle, from the centerline of La Sierra Avenue (formerly Holden Avenue);

THENCE North 23° 13' 30" West, along said parallel line, 183.05 feet to said southwesterly prolongation of the northwesterly line of Lot 6'

THENCE South 65° 32' 00" West, along said southwesterly prolongation, 6.00 feet to the point of beginning.

Area - 1,099.0 square feet.

DESCRIPTION APPROVAL  
General Hutchinson 4/30/79  
Surveyor

APPROVED AS TO FORM  
ASST. CITY ATTORNEY

142151

CAT. NO. NN00634  
TO 1950 CA (7-82)  
(Witness-Individual)



STATE OF CALIFORNIA }  
COUNTY OF RIVERSIDE } SS.

On APRIL 30, 1984 before me, the undersigned, a Notary Public in and for said State, personally appeared M. WILLIAM HOLTSINGER personally known to me to be the person whose name is subscribed to the within Instrument, or proved to be such by the oath of a credible witness who is personally known to me, as being the subscribing Witness thereto, said subscribing Witness being by me duly sworn, deposes and says: That this witness resides in RIVERSIDE COUNTY and that said witness was present and saw NICK J. FULGENZI and JEAN F. FULGENZI personally known to said witness to be the same person described in and whose name is subscribed to the within and annexed Instrument as a party thereto, execute and deliver the same, and that affiant subscribed his/her name to the within Instrument as a Witness.  
WITNESS my hand and official seal.

← STA. 142151

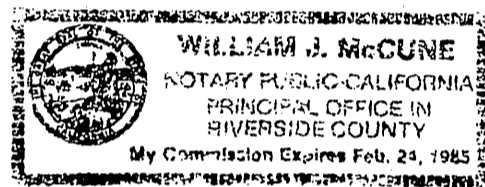

Signed

William J. McCune

(This area for official notarial seal)

Dated

April 23, 1984

Nick J. Fulgenzi  
NICK J. FULGENZI

JEAN F. FULGENZI

Jean F. Fulgenzi

William Holtsinger  
Subscribing Witness

CONSENT TO RECORDATION

THIS IS TO CERTIFY that the interest in real property conveyed by this annexed instrument dated 4/23/84 from Nick J. Fulgenzi and Jean F. Fulgenzi to the City of Riverside, a municipal corporation of the State of California, is hereby accepted by the undersigned officer on behalf of the City Council of said City pursuant to authority conferred by Resolution No. 14883 of said City Council adopted on January 25, 1983, and the grantee consents to the recordation thereof by its duly authorized officer.

Dated:

6/29/84

William Holtsinger  
Property Services Manager

142151

|     |   |            |            |
|-----|---|------------|------------|
| 028 | SEVIER, MARIE<br>Date<br>700<br>Sq. Ft.             | 2.34<br>A. | 2.36<br>A. |
| 029 | BECNHAM, BOB A., ET UX<br>Date<br>810<br>Sq. Ft.    | 0.55<br>A. | 0.57<br>A. |
| 030 | WAGNER, JACK R., ET UX<br>Date<br>725<br>Sq. Ft.    | 0.48<br>A. | 0.50<br>A. |
| 031 | MILBURN, JAMES R., ET UX<br>Date<br>1842<br>Sq. Ft. | 4.49<br>A. | 4.53<br>A. |

# La Sierra Heights Tract No. 2

M.B. 7/56 Riv. Co.

Hole Ave. to Arlington Ave.  
RIGHT-OF-WAY MAP

R-1512 RW  
SHEET 6 of 18

THE BASIS OF BEARINGS IS THE CENTERLINE OF LA SIERRA AVENUE (FORMERLY HOLDEN AVE) AS SHOWN BY MAP OF LA SIERRA HEIGHTS TRACT NO 2, RECORDED IN BOOK 7 OF MAPS AT PAGE 66 THEREOF, LYING BETWEEN NORWOOD AVENUE AND GRAMERCY PLACE TAKEN AS N23°13'30"W

10897  
6/19-2

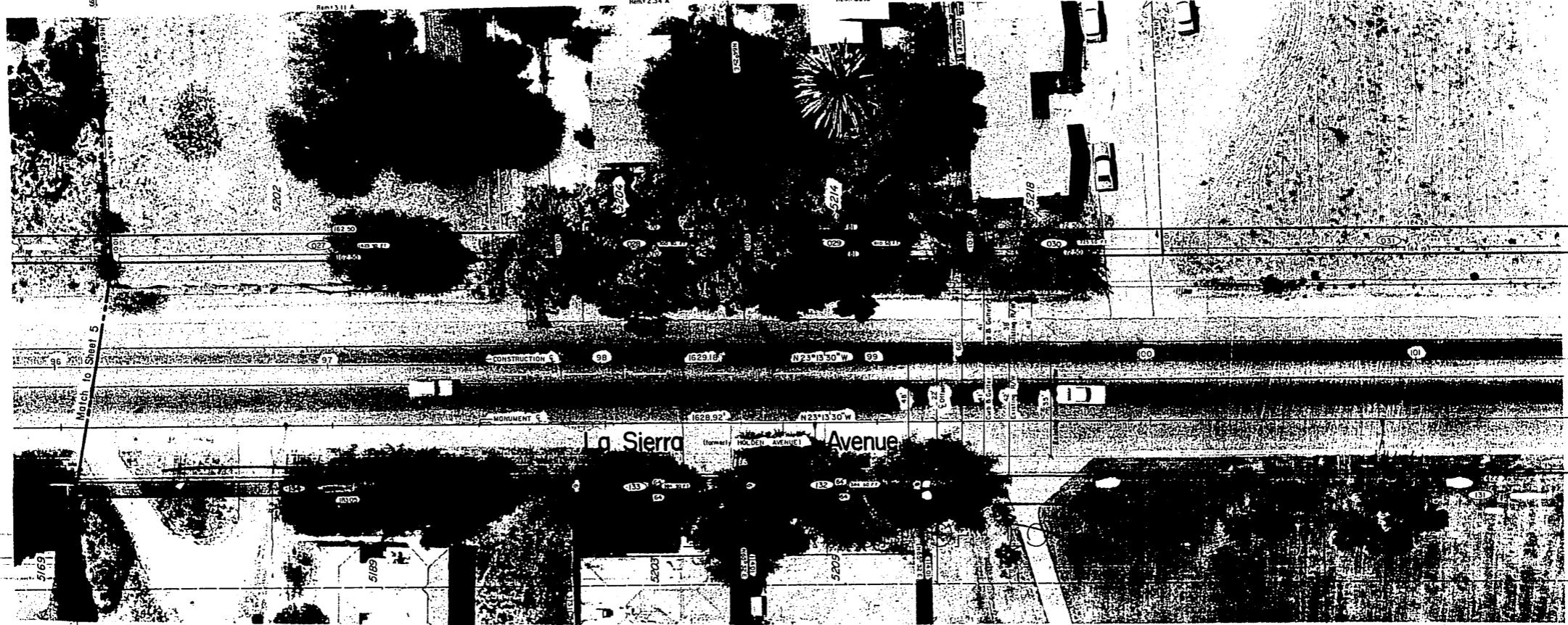

Por. LOT 6

LOT 5

Por. LOT 4

## Holden Avenue Tract

M.B. 11/57-59 Riv. Co.

| NO. | NAME  | DATE | ACRES | SQM. AREA | TOTAL AREA |
|-----|---|------|-------|-----------|------------|
| 132 | STETTLER, RONALD, ET UX                           | DATE | 3.84  | 0.17      | 0.18       |
| 133 | S.C. CALK ABBEY OF THE DAUGHTERS OF THE DAUGHTERS | DATE | 3.84  | 0.17      | 0.18       |
| 134 | FULGENZI, NICK J., ET UX                          | DATE | 10.99 | 1.81      | 1.84       |

REDUCED PLANS  
1" = 20'



PUBLIC WORKS DIRECTOR, CITY OF RIVERSIDE

DATE \_\_\_\_\_

PROPERTY SERVICES MANAGER, CITY OF RIVERSIDE

DATE \_\_\_\_\_

*J. R. Jansen*  
RIGHT OF WAY ENGINEER, CALTRANS  
REGISTERED CIVIL ENGINEER NO. 11653

APPROVAL \_\_\_\_\_

570

18 1/2' 10 1/2' 13 1/2'

Match to Sheet 7