

2663

When recorded mail to:

City Clerk's Office
City of Riverside
City Hall, 3900 Main Street
Riverside, California 92522

FREE RECORDING
This instrument is for the benefit
of the City of Riverside and is
entitled to be recorded without
fee. (Government Code 6103)

RECEIVED FOR RECORD
5:00 Min. Post Office

JAN 4 1985
Recorded in Official Records
of Riverside County, California
Wally E. Smith
RECORDER
Fees \$

0

FOR RECORDER'S OFFICE USE ONLY

Project: 6017 Chester Street
Building Permit

11078

GRANT DEED

Allen-DeLife Corp., a California Corporation, Grantor, FOR A VALUABLE
CONSIDERATION, receipt of which is hereby acknowledged, does hereby grant to the
CITY OF RIVERSIDE, a Municipal Corporation, the real property in the City of
Riverside, County of Riverside, State of California, described as follows:

The easterly 8.00 feet of lot 24, in block 27, of Tract No. 1, of the
Riverview Addition to the City of Riverside, as shown by map on file in
Book 6 of Maps, at page 38 thereof, Records of Riverside County,
California.

DEFINITION APPROVAL
George P. Hutchinson, Jr.
Surveyor

Area - 400 square feet

Dated Dec. 27, 1984

STATE OF CALIFORNIA
ALLEN DELIFE, INC.
Incorporated June 10, 1981

ALLEN DELIFE CORP.

By: Gary Allen - Pres

By: _____

Approved as to Description

George P. Hutchinson 10/8/84 by -

Surveyor, City of Riverside

APPROVED AS TO FORM

Clarence Toney
ASST. CITY ATTORNEY

CONSENT TO RECORDATION

THIS IS TO CERTIFY that the interest in real property conveyed by the
within instrument to the City of Riverside, California, a Municipal Corporation,
is hereby accepted by the undersigned officer on behalf of the City Council of
said City pursuant to authority conferred by Resolution No. 14883 of said City
Council adopted January 25, 1983, and the grantee consents to recordation
thereof by its duly authorized officer.

Dated 1/4/85

Property Services Manager
title

3M/Cp - 1/M14/Ib

2663

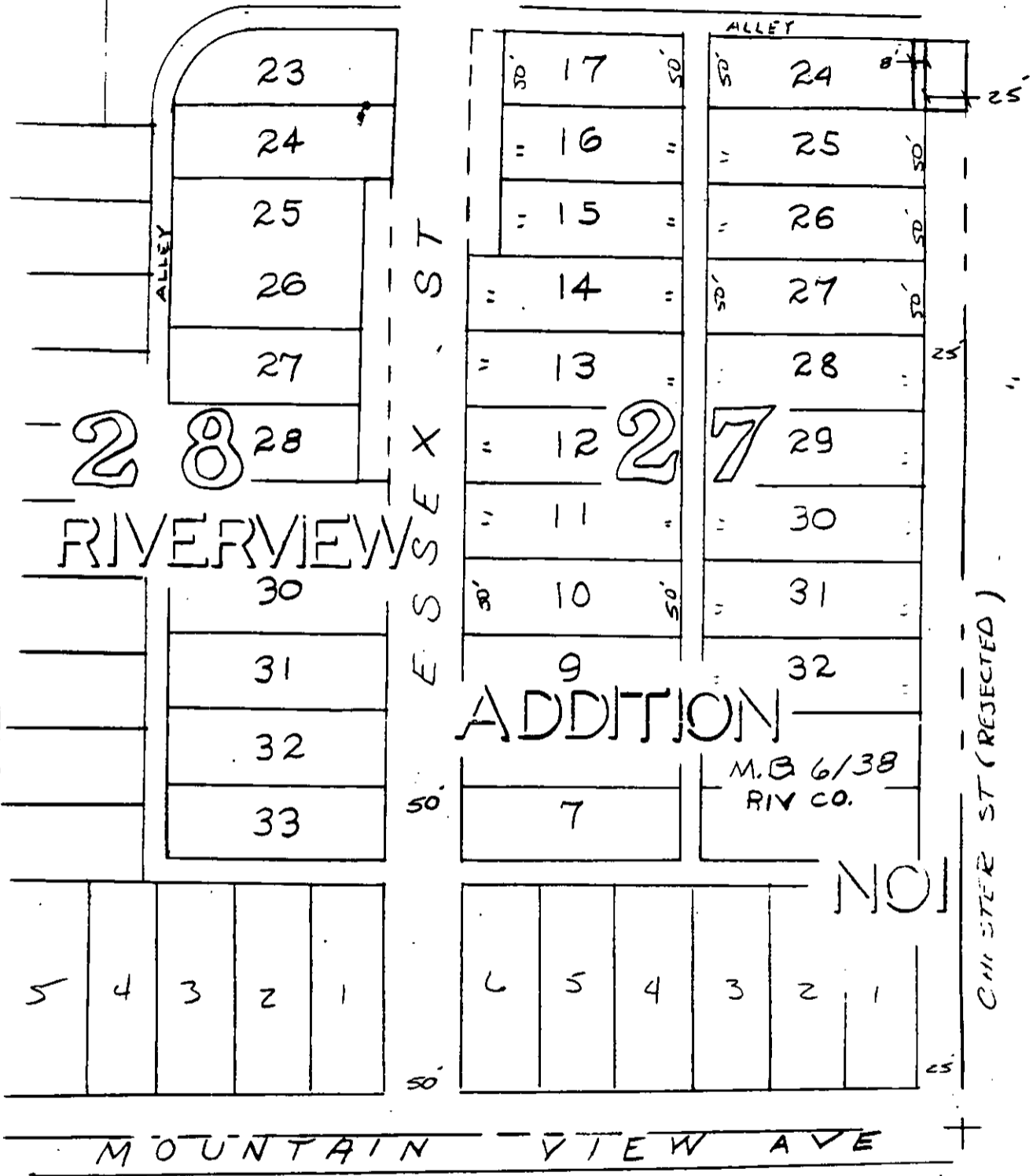

• CITY OF RIVERSIDE, CALIFORNIA •

THIS PLAT IS SOLELY AN AID IN LOCATING THE PARCEL(S) DESCRIBED IN THE ATTACHED DOCUMENT. IT IS NOT A PART OF THE WRITTEN DESCRIPTION THEREIN.

SHEET 1 OF 1

4/2

SCALE: 1" = 100'

DRAWN BY D DATE 10/2/84

SUBJECT 6017 CHESTER - BLOG PERMIT