

REQUEST FOR RECORDATION

Request of City Clerk for recordation of this instrument, and return to,
City Clerk, City Hall, 3900 Main Street
Riverside, CA 92522

74824

RESOLUTION NO. 15689

A RESOLUTION OF THE CITY COUNCIL OF THE CITY OF RIVERSIDE, CALIFORNIA, ACCEPTING A ONE-FOOT BARRIER STRIP WITHIN TRACT NO. 6756-3 (WHICH BARRIER STRIP ADJOINS TRACT NO. 19568) FOR STREET PURPOSES TO BE KNOWN AS A PORTION OF GWINNETT DRIVE.

11157

BE IT RESOLVED by the City Council of the City of Riverside, California, that the following one-foot barrier strip is hereby accepted to public use for street purposes to be known as a portion of Gwinnett Drive:

Lot "H" (1-foot barrier strip) of Tract 6756-3 as shown by map on file in Book 90 of Maps at pages 75 and 76 thereof, records of Riverside County, California.

ADOPTED by the City Council and signed by the Mayor and attested by the City Clerk this 9th day of April, 1985.



Mayor/ of the City of Riverside
Pro Tempore

Attest:



City Clerk of the City of Riverside

I, Alice A. Hare, City Clerk of the City of Riverside, California, hereby certify that the foregoing resolution was duly and regularly introduced and adopted by the City Council of said City at its meeting held on the 9th day of April, 1985, by the following vote, to wit:

Ayes: Councilmembers Loveridge, Shepard, Mansfield,
Bowers, Renck, Digati and Peterson.

Noes: None.

Absent: None.

IN WITNESS WHEREOF I have hereunto set my hand and affixed the official seal of the City of Riverside, California, this 9th day of April, 1985.



City Clerk of the City of Riverside

RECEIVED FOR RECORD
OF
Min. Past 2 o'clock PM

APR 10 1985

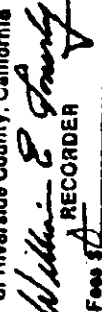
Recorded in Official Records
of Riverside County, California

RECORDER
Fees \$1

C456027 BL

4-5-85
JW/h

CITY ATTORNEY
RIVERSIDE
CALIFORNIA

11157

74824

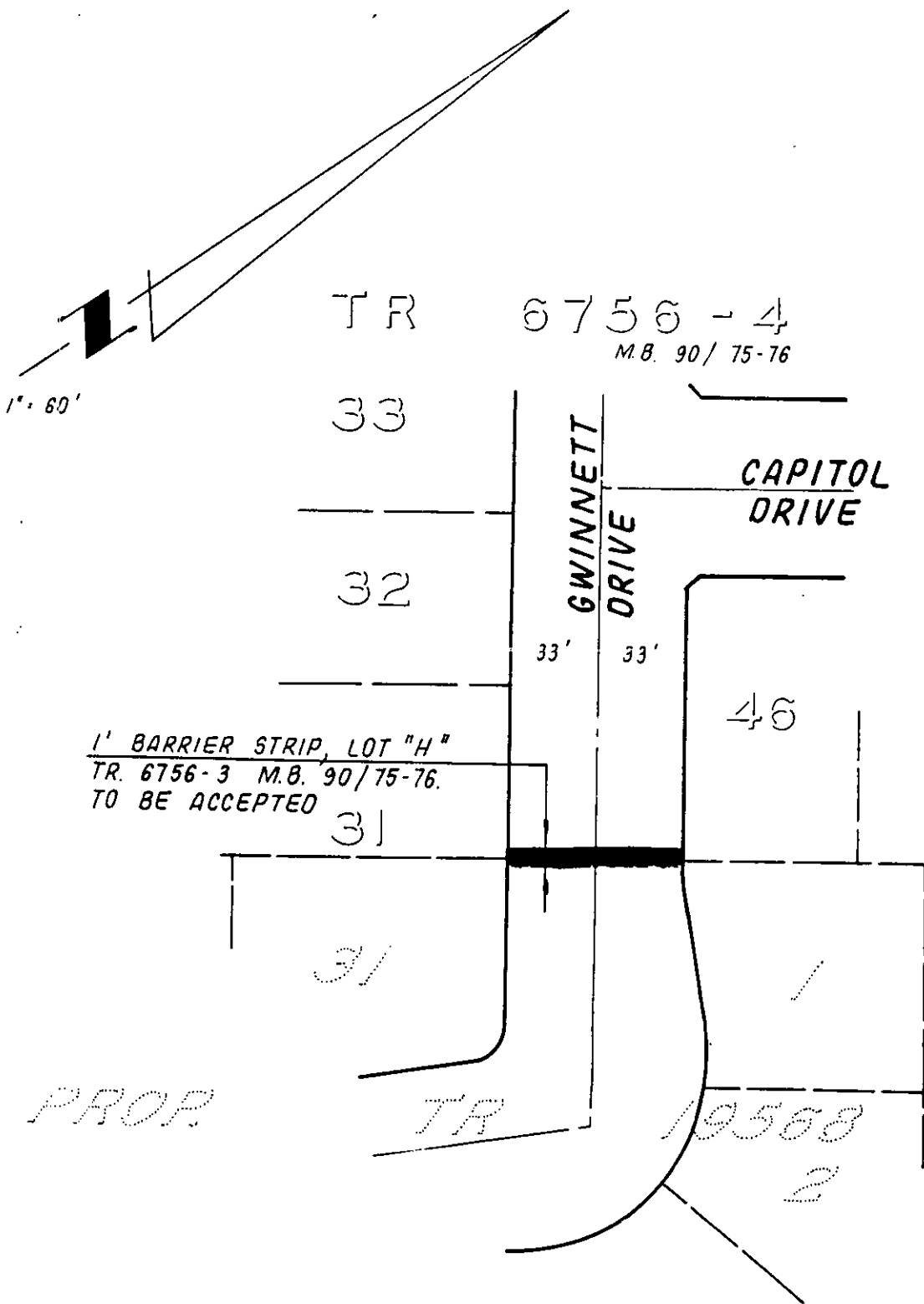

• CITY OF RIVERSIDE, CALIFORNIA •

THIS PLAT IS SOLELY AN AID IN LOCATING THE PARCEL(S) DESCRIBED IN THE ATTACHED DOCUMENT. IT IS NOT A PART OF THE WRITTEN DESCRIPTION THEREIN.

SHEET 1 OF 1

6503
83-8007

SCALE: 1" = 60'

DRAWN BY J.T. DATE 10/16/84

SUBJECT LOT "H" TR. 6756-3 M.B. 90/75-76
1' BARRIER STRIP ACCEPTANCE FOR TR. 19568