

112109

When recorded mail to:

City Clerk's Office  
City of Riverside  
City Hall, 3900 Main Street  
Riverside, California 92522

FREE RECORDING

This instrument is for the benefit of the City of Riverside and is entitled to be recorded without fee (Government Code 6103)

RECEIVED FOR RECORD  
Min. Past 3 o'clock P.M.

MAY 24 1985

Recorded in Official Records  
of Riverside County, California

William E. Stoney  
RECORDER  
Fees \$

FOR RECORDER'S OFFICE USE ONLY

Project: Megginson Trunk Sewer Extension  
Parcel 5

11211

E A S E M E N T

FOR VALUABLE CONSIDERATION, receipt of which is hereby acknowledged, PHILBIN ASSOCIATES, a California limited partnership, as Grantor, grants to the CITY OF RIVERSIDE, a municipal corporation, as Grantee, its successors and assigns, an easement and right-of-way for the construction, reconstruction, maintenance, operation, inspection, repair, replacement, relocation, renewal and removal of the sanitary sewer facilities together with all necessary appurtenances, in, under, upon, over and along that certain real property situated in the City of Riverside, County of Riverside, State of California, described as follows:

The west 12.00 feet of Parcel 1 of Parcel Map 20022, as shown by map on file in Book 124, Page 27 of Parcel Maps, records of said Riverside County; said west 12.00 feet being measured at right angle 12.00 feet east from the west line of said Parcel 1.

Area - 2,323.06 square feet.

TOGETHER WITH the right to clear and keep clear said easement and right-of-way from any structures or trees, to enter upon and to pass and repass over and along said property, and to deposit tools, implements and other material thereon by Grantee, its officers, agents and employees and by persons under contract with said Grantee and their officers, agents and employees, whenever and wherever necessary for the purpose of constructing, reconstructing, maintaining, operating, inspecting, repairing, replacing, relocating, renewing and removing said sanitary sewer facilities.

Dated 5/12/85

PHILBIN ASSOCIATES,  
a California limited partnership

By [Signature]  
Donald L. Laten  
Title: General Partner

By [Signature]  
Jerome P. Greubel  
Title: General Partner

APPROVED AS TO FORM

[Signature]  
Kathleen M. Amzel  
SENIOR DEPUTY CITY ATTORNEY

DESCRIPTION APPROVAL  
by [Signature] 5/8/85



112109

CAMPANZA SUB. No. 1  
M.B. 22181-82  
276

P.M.B. 4/19  
PAR. 3

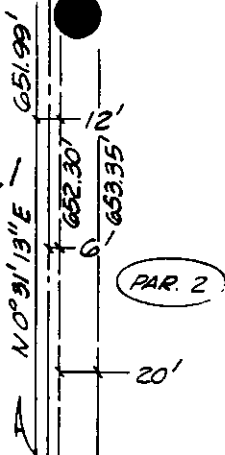

PAR. 2

BOULEVARD



PHILBIN

AVENUE

S 89° 28' 46" E

40'  
33'

568

569

570

571

572

573

574

575

M.B. 39/15-17

No. 1

SIERRA FOOTHILLS

190.22'

190.73'

452.18'

PAR. 5

PAR. 1

P.M. 20022  
P.M.B. 124/26-27

PAR. 2

613.33'

PAR. 6

FOR SEC. 1  
T.35. R.G.W. S.B.M.

PAR. 7

VAN BUREN

• CITY OF RIVERSIDE, CALIFORNIA •

THIS PLAT IS SOLELY AN AID IN LOCATING THE PARCEL(S) DESCRIBED IN THE ATTACHED DOCUMENT. IT IS NOT A PART OF THE WRITTEN DESCRIPTION THEREIN.

SHEET 3 OF 8

9/9-2, 16-1

SCALE: 1" = 100'

DRAWN BY KGE DATE 4/12/85

SUBJECT MEGGINSON TRUNK SEWER EXTENSION