

126826

When recorded mail to:

City Clerk's Office
City of Riverside
City Hall, 3900 Main Street
Riverside, California 92522

FREE RECORDING

This instrument is for the benefit of the City of Riverside and is entitled to be recorded without fee. (Government Code 6103)

RECEIVED FOR RECORD
Min. Paid 20'clock P.M.

JUN 12 1985

Recorded in Official Records
of Riverside County, California

William E. Smith
RECORDER
Fees \$

Project: 5795 Brockton Avenue
Building Permit

FOR RECORDER'S OFFICE USE ONLY

11223

OFFER OF DEDICATION

On this 5 day of June, 1985, DONNA J. SEBASTIAN, an unmarried woman, irrevocably offer for dedication to the CITY OF RIVERSIDE, a municipal corporation, pursuant to the provisions of California Government Code Section 7050, for public street and highway purposes, together with all rights to construct and maintain improvements consistent with the use as a public street and highway, that real property located in the City of Riverside, County of Riverside, State of California, described as follows:

The northwesterly 5.00 feet of Lot 46 of Edgewood Place, as shown by map on file in Book 8, Page 7 of Maps, records of said Riverside County.

Dated 6/5/85

Donna J. Sebastian
DONNA J. SEBASTIAN

DESCRIPTION APPROVAL

George P. Hutchinson 5/31/85 AS

CONSENT TO RECORDATION

APPROVED AS TO FORM
Cathy L. ...
SENIOR CLERK CITY ATTORNEY

The City of Riverside, a municipal corporation, hereby consents through the undersigned officer to the hereinabove irrevocable offer of dedication, provided, however, this consent does not constitute acceptance of said offer of dedication at this time, but said City, through its City Council, reserves all rights to accept said dedication at any time hereafter. This is to certify that the undersigned officer hereby consents on behalf of the City of Riverside to the recordation of this instrument pursuant to the authority conferred by Resolution No. 18433 of the City Council of said City, adopted on January 25, 1983.

Dated 6/12/85

William E. Smith
Title Property Services Manager

0047X/m - 4225M/a

126826

EDGEWOOD PLACE

30'

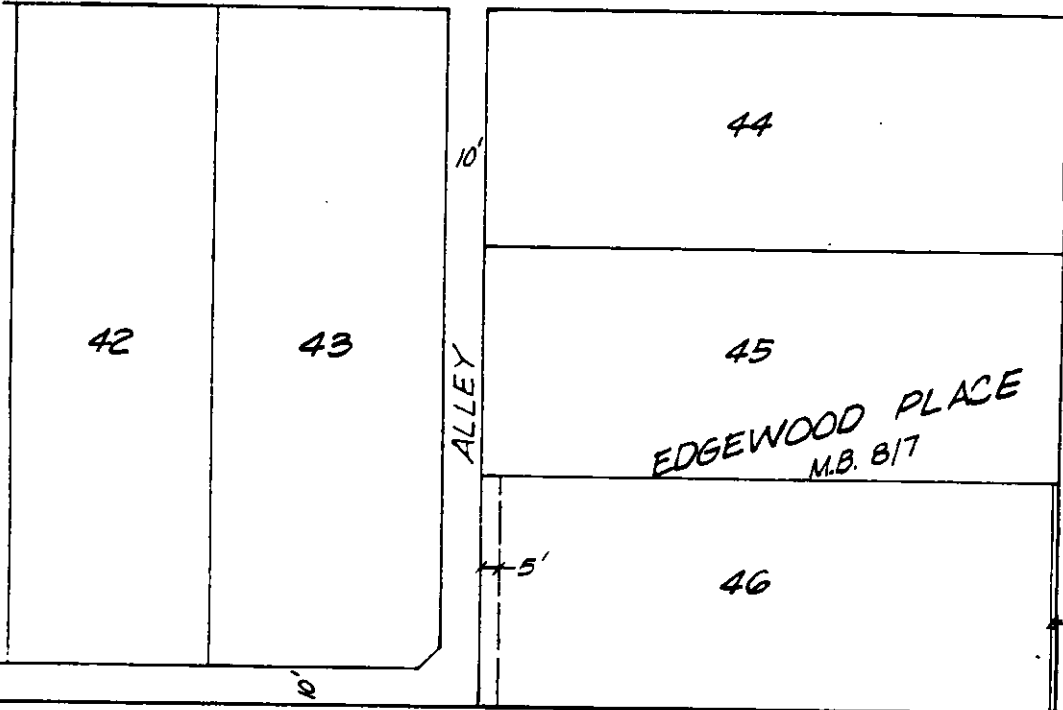

AVENUE

43'

EDGEWOOD PLACE
M.B. 817

ALLEY

5'

1'

BROCKTON

43'

ADLER TRACT UNIT No. 2
M.B. 24/90

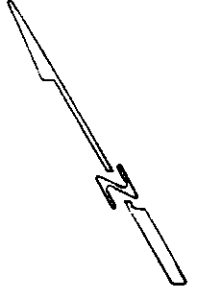

• CITY OF RIVERSIDE, CALIFORNIA •

THIS PLAT IS SOLELY AN AID IN LOCATING THE PARCEL(S) DESCRIBED IN THE ATTACHED DOCUMENT. IT IS NOT A PART OF THE WRITTEN DESCRIPTION THEREIN.

SHEET 1 OF 1

2/26

SCALE: 1" = 50'

DRAWN BY KGB DATE 5/31/85

SUBJECT 5795 BROCKTON AVE. BLDG. PMT.