

138280

When recorded mail to:

City Clerk's Office
City of Riverside
City Hall, 3900 Main Street
Riverside, California 92522

FREE RECORDING

This instrument is for the benefit of the City of Riverside and is entitled to be recorded without fee. (Government Code 6103)

RECEIVED FOR RECORD
11:20 AM Past 2:30 clock PM

JUN 13 1986

Recorded in Official Records of Riverside County, California

William E. Smith
RECORDER

Fee \$

Project: 5833 and 5841 Griffith Street
Building Permit

FOR RECORDER'S OFFICE USE ONLY

11494

GRANT DEED

HASSAN ROOSTAI, a single man, Grantor, FOR VALUABLE CONSIDERATION, receipt of which is hereby acknowledged, does hereby grant to the CITY OF RIVERSIDE, a municipal corporation, the real property in the City of Riverside, County of Riverside, State of California, described as follows:

The east 8.00 feet of Lots 24 and 25 in Block 13 of Tract No. 3 of the Riverview Addition to the City of Riverside, as shown by map on file in Book 7, Page 5 of maps, records of said Riverside County.

Area - 800 square feet.

Dated 6/9/86

Hassan Roostai
HASSAN ROOSTAI

DESCRIPTION APPROVAL

George P. Hutchinson, 4/14/86
Survivor

CONSENT TO RECORDATION

THIS IS TO CERTIFY that the interest in real property conveyed by the within instrument to the City of Riverside, California, a Municipal Corporation, is hereby accepted by the undersigned officer on behalf of the City Council of said City pursuant to authority conferred by Resolution No. 14883 of said City Council adopted January 25, 1983, and the grantee consents to recordation thereof by its duly authorized officer.

Dated 6/13/86

Maria E. Sawyer
Title Property Services Manager

0043X/m - 2471m/a

APPROVED AS TO FORM

Kathleen M. Gonzales
SENIOR DEPUTY CITY ATTORNEY

138280

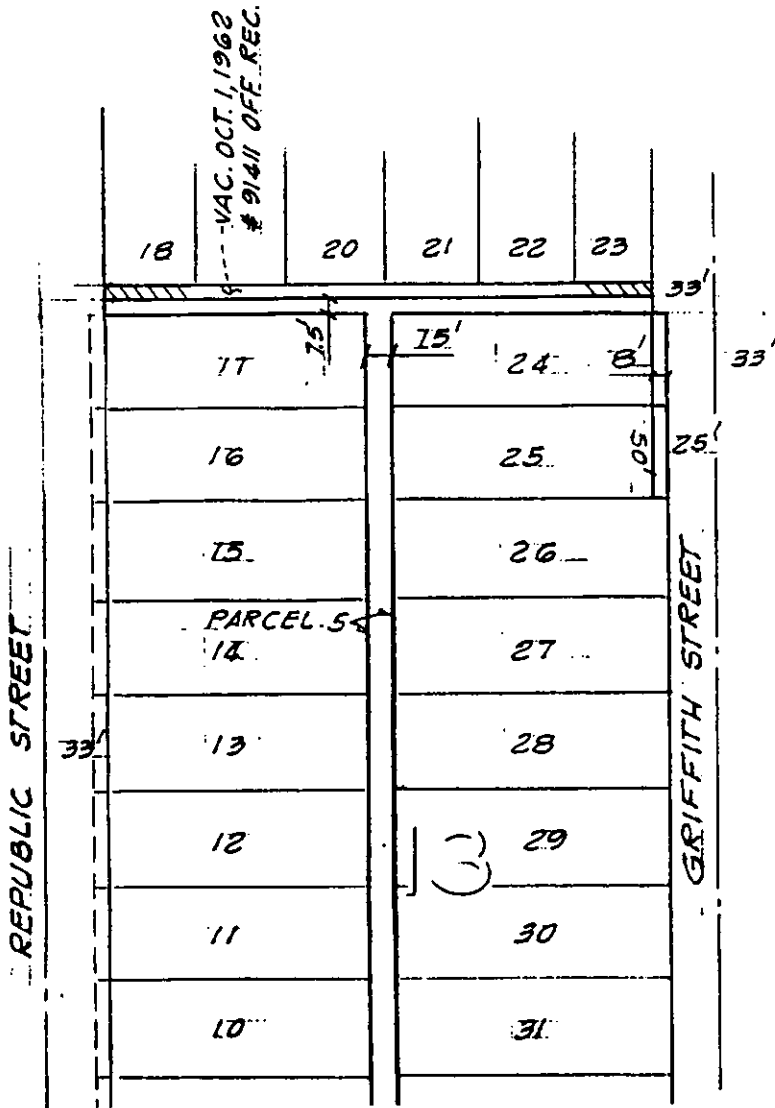

TRACT NO 3
OF THE
RIVERVIEW ADDITION
TO THE
CITY OF RIVERSIDE
M.B. 7/5 RIV. CO.

• CITY OF RIVERSIDE, CALIFORNIA •

THIS PLAT IS SOLELY AN AID IN LOCATING THE PARCEL(S) DESCRIBED IN THE ATTACHED DOCUMENT. IT IS NOT A PART OF THE WRITTEN DESCRIPTION THEREIN.

SHEET 1 OF 1

4/4

SCALE: 1" = 100'

DRAWN BY G.S. DATE 4/11/86

SUBJECT 58538-41 GRIFFITH ST, BLDG. PERMIT