

330880

When recorded mail to:

City Clerk's Office
City of Riverside
City Hall, 3900 Main Street
Riverside, California 92522

FREE RECORDING

This instrument is for the benefit of the City of Riverside and is entitled to be recorded without fee (Government Code 6103)

RECEIVED FOR RECORDING
Min. Past 12/1/86

DEC 24 1986
Recorded in Official Records
of Riverside County, California
William E. Stoney
RECORDER

FOR RECORDER'S OFFICE USE ONLY

Project: Guadalupe Place Storm Drain

11705

E A S E M E N T

FOR VALUABLE CONSIDERATION, receipt of which is hereby acknowledged, CHARLES R. LEWIS and MARY K. LEWIS, as Grantors, grant to the CITY OF RIVERSIDE, a municipal corporation, as Grantee, its successors and assigns, an easement and right-of-way for the construction, reconstruction, maintenance, operation, inspection, repair, replacement, relocation, renewal and removal of storm drain facilities together with all necessary appurtenances, in, under, upon, over and along that certain real property situated in the City of Riverside, County of Riverside, State of California, described as follows:

The southwesterly 10.00 feet of Lot 10 of Clawson Tract, as shown by map on file in Book 36 of Maps, at Page 100 thereof, records of said Riverside County.

Area - 0.028 of an acre.

TOGETHER WITH the right to clear and keep clear said easement and right-of-way from any structures or trees, to enter upon and to pass and repass over and along said property, and to deposit tools, implements and other material thereon by Grantee, its officers, agents and employees and by persons under contract with said Grantee and their officers, agents and employees, whenever and wherever necessary for the purpose of constructing, reconstructing, maintaining, operating, inspecting, repairing, replacing, relocating, renewing and removing said storm drain facilities.

DESCRIPTION APPROVAL
George P. Hutchings
11/25/86

330880

Dated December 19, 1986

Charles R. Lewis
CHARLES R. LEWIS

Witnessed By Donald E. Curran

Mary K. Lewis
MARY K. LEWIS

CONSENT TO RECORDATION

THIS IS TO CERTIFY that the interest in real property conveyed by the within instrument to the City of Riverside, California, a municipal corporation, is hereby accepted by the undersigned officer on behalf of the City Council of said City pursuant to authority conferred by Resolution No. 14883 of said City Council adopted January 25, 1983, and the grantee consents to recordation thereof by its duly authorized officer.

Dated 12/24/86

Melody S. Mead
Property Services Manager
title

0038X/m - 4947M/a

Donald E. Curran
CITY ATTORNEY

TC44
(Witness - Individual)

STATE OF CALIFORNIA }
COUNTY OF Riverside } ss.

On December 19, 1986, before me, the undersigned, a Notary Public, in and for said State, personally appeared Donald E. Curran, known to me (or proved to me on the basis of satisfactory evidence) to be the person whose name is subscribed to the within Instrument, as a Witness thereto, who being by me duly sworn, deposes and says:

That he resides in Riverside,
California, and that he was present and saw Charles R. Lewis personally known to him to be the same person described in and whose name subscribed to the within and annexed instrument execute the same; and he acknowledged to said affiant that he executed the same; and that affiant subscribed his name thereto as a Witness to said execution.

WITNESS my hand and official seal.
Signature Melody S. Mead

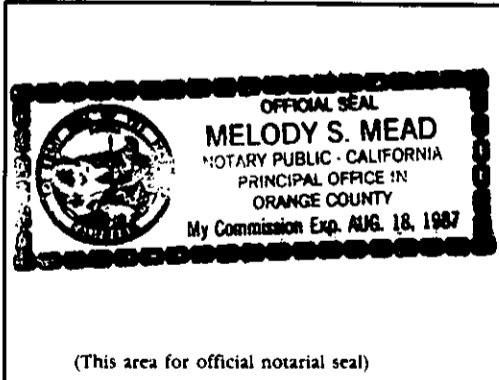

(This area for official notarial seal)

CALIFORNIA }
COUNTY OF Riverside } ss.

On Dec. 19th, 1986 before me, the undersigned a Notary Public in and for said State, personally appeared Mary K. Lewis

_____, (known to me) or proved to me on the basis of satisfactory evidence) to be the person whose name is subscribed to the within instrument and acknowledged that she executed the same.

WITNESS my hand and official seal.
Signature Melody S. Mead

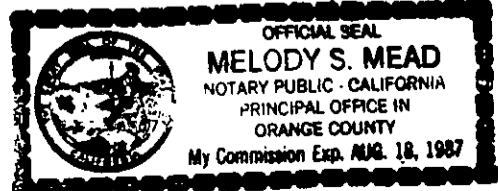

(This area for official notarial seal)

330880
STAPLE HERE

330880

330880

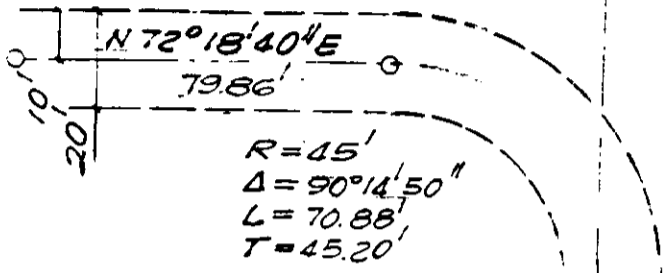

MAR. 31. 1905
#36378 OFF. REC.

TWIN BUTTES BLOCK
MB 10/39 RIV. CO.



CLAWSON TRACT
MB 36/100 RIV. CO.

LOT 11

LOT 10

ALPINE WAY
 $N 72^\circ 34' 20'' E$

• CITY OF RIVERSIDE, CALIFORNIA •

THIS PLAT IS SOLELY AN AID IN LOCATING THE PARCEL(S) DESCRIBED IN THE ATTACHED DOCUMENT. IT IS NOT A PART OF THE WRITTEN DESCRIPTION THEREIN.

SHEET 1 OF 1

6/11-3

SCALE: 1" = 40'

DRAWN BY GS DATE 6/16/85

SUBJECT GUADALUPE PL. STORM DRAIN