

12371

When recorded mail to:

City Clerk's Office
City of Riverside
City Hall, 3900 Main Street
Riverside, California 92522

FREE RECORDING

This instrument is for the benefit of the City of Riverside and is entitled to be recorded without fee (Government Code 6103)

RECEIVED FOR RECORD
AT 2:00 O'CLOCK P.M.

JAN 15 1988
Recorded in Official Records
of Riverside County, California
William E. Corby
Recorder
Fees \$

FOR RECORDER'S OFFICE USE ONLY

Project: T-21767-3

12053

E A S E M E N T

FOR VALUABLE CONSIDERATION, receipt of which is hereby acknowledged, CALIFORNIA COMMUNITIES INC., a California corporation, as Grantor, grants to the CITY OF RIVERSIDE, a municipal corporation, as Grantee, its successors and assigns, an easement and right-of-way for the construction, reconstruction, maintenance, operation, inspection, repair, replacement, relocation, renewal and removal of sanitary sewer facilities, together with all necessary appurtenances, in, under, upon, over and along that certain real property situated in the City of Riverside, County of Riverside, State of California, described as follows:

An easement for sewer purposes, being a strip of land twelve (12) feet wide, over, under, across and through a portion of Section 8, T. 3 S., R. 4 W., S.B.M., the centerline of said strip being more accurately described as follows:

COMMENCING at an intersection with the centerline of Laurelbrook Drive and the northerly tract boundary of Tract 21767-1, as shown by map on file in Book 177 of Maps, Pages 65 through 69, inclusive, records of Riverside County, California;

THENCE North 00° 18' 16" East, along the northerly prolongation of the centerline of said Laurelbrook Drive, a distance of 540.50 feet;

THENCE South 89° 41' 44" East, a distance of 45.00 feet, to the True Point of Beginning;

12371

THENCE continuing South 89° 41' 44" East, a distance of 195.18 feet, to the beginning of a tangent curve, concave northerly and having a radius of 894.00 feet;

THENCE easterly, along the arc of said curve, through a central angle of 21° 45' 23", a distance of 339.47 feet;

THENCE North 68° 32' 53" East, a distance of 499.23 feet, to the easterly terminus of said centerline of said easement.

TOGETHER WITH the right to clear and keep clear said easement and right-of-way from any structures or trees, to enter upon and to pass and repass over and along said property, and to deposit tools, implements and other material thereon by Grantee, its officers, agents and employees and by persons under contract with said Grantee and their officers, agents and employees, whenever and wherever necessary for the purpose of constructing, reconstructing, maintaining, operating, inspecting, repairing, replacing, relocating, renewing and removing said sanitary sewer facilities.

DESCRIPTION APPROVAL 1/11/88
Dolly Inyc by —
SURVEYOR, CITY OF RIVERSIDE

Dated January 12, 1988

CALIFORNIA COMMUNITIES, INC.,
a California corporation

By [Signature]

Title Vice President

By [Signature]

Title Vice President

APPROVED AS TO FORM
Kathleen M. Giral
ASST. CITY ATTORNEY

CONSENT TO RECORDATION

THIS IS TO CERTIFY that the interest in real property conveyed by the within instrument to the City of Riverside, California, a municipal corporation, is hereby accepted by the undersigned officer on behalf of the City Council of said City pursuant to authority conferred by Resolution No. 14883 of said City Council adopted January 25, 1983, and the grantee consents to recordation thereof by its duly authorized officer.

12371

Dated 1/15/88

[Handwritten Signature]

Title Property Services Manager

311.1/m - SURVEY.343/a

STATE OF CALIFORNIA

COUNTY OF ORANGE } ss.

On this 12TH day of JANUARY, in the year 1988, before me, the undersigned, a Notary Public in and for said State, personally appeared KIM J. WALKER and RUTH E. OCHOA

_____, personally known to me (or proved to me on the basis of satisfactory evidence) to be the persons who executed the within instrument as VICE President and _____ Secretary, respectively, of the Corporation therein named, and acknowledged to me that the Corporation executed it pursuant to its by-laws or a resolution of its board of directors.

WITNESS my hand and official seal

[Handwritten Signature: Patricia A. Harvey]
Notary Public in and for said State.



ACKNOWLEDGMENT - Corp - Pres & Sec - Wolcotts Form 222CA - Rev 11-83
© 1983 WOLCOTTS, INC (price class 8-2)

12371

12371

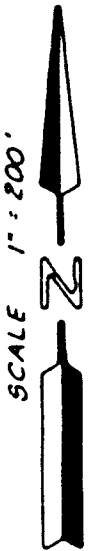

E OF 12' WIDE SEWER EASEMENT

S. 89° 41' 44" E.
45.00'

Δ: 21° 45' 23"
R: 894.00'
L: 339.47'

N. 68° 32' 53" E.
499.23'

S. 89° 41' 44" E.
195.18'

PORTION OF SECTION 8

T. 3 S., R. 4 W.

N. 00° 18' 16" E. 500.50'

T.P.O.B. 2

EXISTING TRACT 21767-1 BOUNDARY
PER M.B. 177 / 65-69

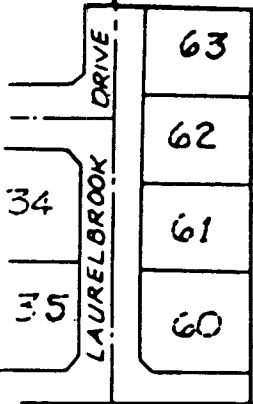

• CITY OF RIVERSIDE, CALIFORNIA •

THIS PLAT IS SOLELY AN AID IN LOCATING THE PARCEL(S) DESCRIBED IN THE ATTACHED DOCUMENT. IT IS NOT A PART OF THE WRITTEN DESCRIPTION THEREIN.

SHEET 1 OF 1

SCALE 1" = 200'

DRAWN BY DLM DATE 1/11/08

SUBJECT 12' WIDE SEWER EASEMENT