

32759

When recorded mail to:

City Clerk's Office  
City of Riverside  
City Hall, 3900 Main Street  
Riverside, California 92522

FREE RECORDING

This instrument is for the benefit of the City of Riverside and is entitled to be recorded without fee. (Government Code 6103)

RECEIVED FOR RECORD  
Min. Post 2 o'clock P.M.

FEB 5 1988

Recorded in Official Records  
of Riverside County, California

*William E. Smith*  
Recorder

Project: 2314 Twelfth Street  
Building Permit

FOR RECORDER'S OFFICE USE ONLY

12:26

GRANT DEED

TIMOTHY D. EDMOND, a married man as his sole and separate property, Grantor, FOR VALUABLE CONSIDERATION, receipt of which is hereby acknowledged, does hereby grant to the CITY OF RIVERSIDE, a municipal corporation, the real property in the City of Riverside, County of Riverside, State of California, described as follows:

The south 2.5 feet of Lot 4 in Block 1 and the south 2.5 feet of the west one-half of Lot 3 in Block 1 of Jarvis Subdivision, as shown by map recorded in Book 5, Page 44 of Maps, records of San Bernardino County, California.

Area - 112.5 square feet, more or less.

Dated 2-1-88

*Timothy D. Edmond*  
TIMOTHY D. EDMOND

APPROVED AS TO FORM

*William M. Donzel*  
ASS. CITY ATTORNEY

CONSENT TO RECORDATION

THIS IS TO CERTIFY that the interest in real property conveyed by the within instrument to the City of Riverside, California, a Municipal Corporation, is hereby accepted by the undersigned officer on behalf of the City Council of said City pursuant to authority conferred by Resolution No. 14883 of said City Council adopted January 25, 1983, and the grantee consents to recordation thereof by its duly authorized officer.

Dated 2/5/88

*William E. Smith*  
Title Industry Services Manager

311.5/m - SURVEY.337/a

DESCRIPTION APPROVAL  
*William E. Smith*  
SURVEYOR, CITY OF RIVERSIDE

D12076

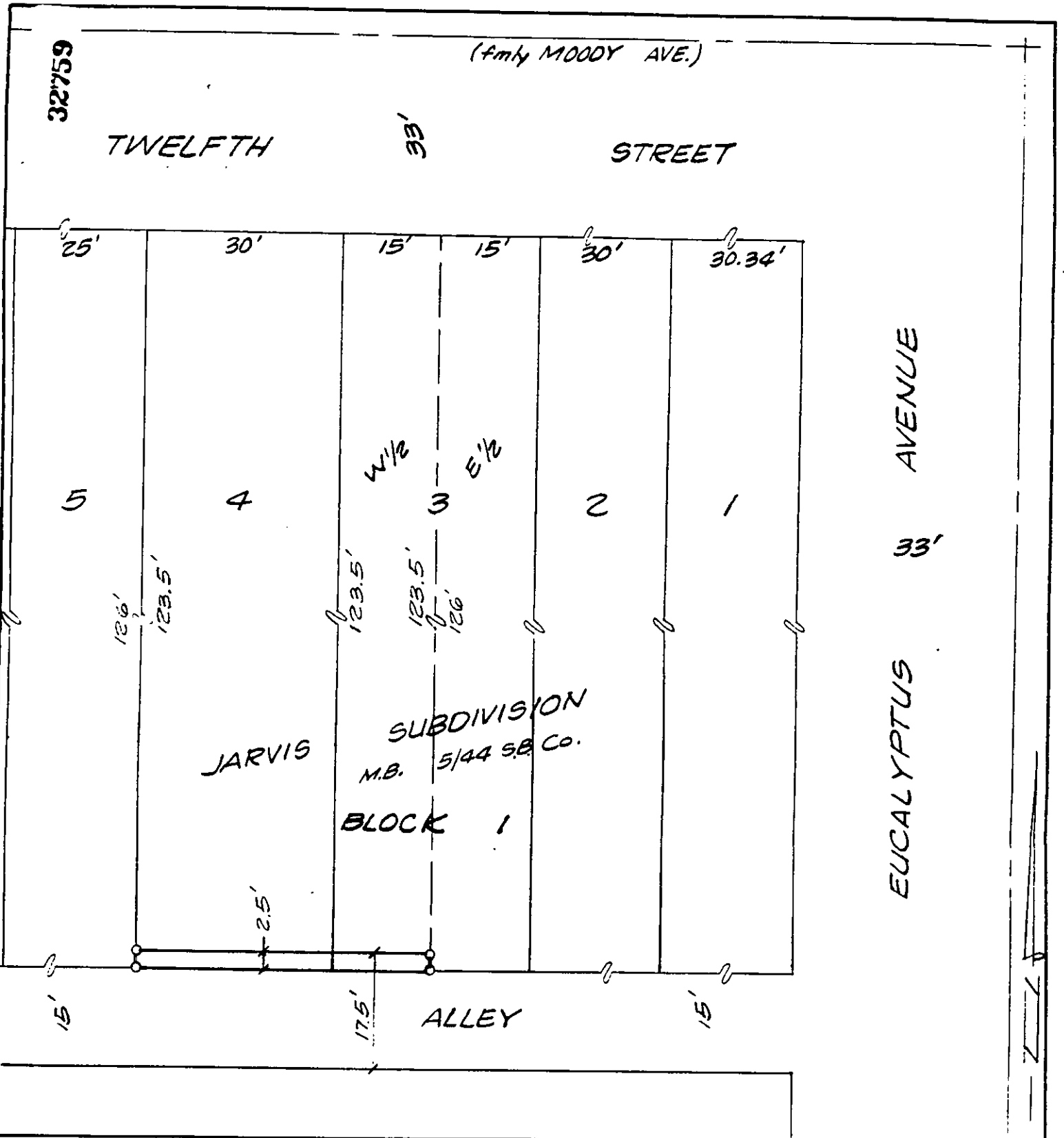

• CITY OF RIVERSIDE, CALIFORNIA •

THIS PLAT IS SOLELY AN AID IN LOCATING THE PARCEL(S) DESCRIBED IN THE ATTACHED DOCUMENT IT IS NOT A PART OF THE WRITTEN DESCRIPTION THEREIN.

SHEET 1 OF 1

3/15

SCALE 1" = 20'

DRAWN BY KGS DATE 1/8/88

SUBJECT 2314 TWELFTH ST. BLDG. PMT.

212076