

338602

When recorded mail to:

City Clerk's Office  
City of Riverside  
City Hall, 3900 Main Street  
Riverside, California 92522

FREE RECORDING

This instrument is for the benefit of the City of Riverside and is entitled to be recorded without fee (Government Code 6103)

RECEIVED FOR RECORD  
11:11 AM  
Past 2 o'clock P.M.

NCV 181988  
Recorded in Official Records  
of Riverside County, California  
1/11/88  
RECORDER  
Fees \$

FOR RECORDER'S OFFICE USE ONLY

Project: Tract 22653

11301

E A S E M E N T

FOR VALUABLE CONSIDERATION, receipt of which is hereby acknowledged, A.S.D., a California limited partnership as Grantor, grants to the CITY OF RIVERSIDE, a municipal corporation, as Grantee, its successors and assigns, an easement and right-of-way for the construction, reconstruction, maintenance, operation, inspection, repair, replacement, relocation, renewal and removal of sanitary sewer facilities, together with all necessary appurtenances, in, under, upon, over and along that certain real property situated in the City of Riverside, County of Riverside, State of California, described as follows:

"SEE EXHIBIT "A" ATTACHED HERETO"

TOGETHER WITH the right to clear and keep clear said easement and right-of-way from any structures or trees, to enter upon and to pass and repass over and along said property, and to deposit tools, implements and other material thereon by Grantee, its officers, agents and employees and by persons under contract with said Grantee and their officers, agents and employees, whenever and wherever necessary for the purpose of constructing, reconstructing, maintaining, operating, inspecting, repairing, replacing, relocating, renewing and removing said sanitary sewer facilities.

338602

Dated Nov 4, 1988

A.S.D., a California limited partnership

By [Signature]

Title GENERAL PARTNER

APPROVED AS TO FORM  
[Signature]  
CAROLYN CONFER  
ASSISTANT CITY ATTORNEY

By \_\_\_\_\_

Title \_\_\_\_\_

CONSENT TO RECORDATION

THIS IS TO CERTIFY that the interest in real property conveyed by the within instrument to the City of Riverside, California, a municipal corporation, is hereby accepted by the undersigned officer on behalf of the City Council of said City pursuant to authority conferred by Resolution No. 14883 of said City Council adopted January 25, 1983, and the grantee consents to recordation thereof by its duly authorized officer.

Dated 11/18/88

[Signature]

Title Property Services Manager

311.1/m - SURVEY.658/n

338602

STATE OF CALIFORNIA }  
COUNTY OF Los Angeles } ss.

On this 4 day of NOVEMBER, in the year 1988, before me, the undersigned, a Notary Public in and for said State, personally appeared AL SIEGAL

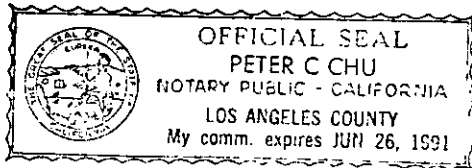

\_\_\_\_\_, personally known to me (or proved to me on the basis of satisfactory evidence) to be the person who executed the within instrument on behalf of the A.S.D. Partnership named therein, and acknowledged to me that the A.S.D. Partnership executed it.

WITNESS my hand and official seal.

[Signature]

Notary Public in and for said State.

ACKNOWLEDGMENT—General or Limited Partnership—Wolcotts Form 236CA—Rev 5-82 ©1982 WOLCOTT'S, INC. (price class 8-2)

1230!

338602

EXHIBIT "A"

That portion of Lot 1 in Block 19, Lots 1 and 2 in Block 29, Lots 1 and 4 in Block 38, Lots 1 and 2 in Block 39, the unnamed streets known as John F. Kennedy Drive, formerly Eschscholtzia Avenue (vacated), Gentian Avenue (vacated) and Brown Street (vacated), all being of the Alessandro Tract, as shown by map on file in Book 6 of Maps, at page 13 thereof, Records of San Bernardino County, California, lying within a strip of land 20.00 feet wide, being 14.00 feet Northerly and Westerly, and 6.00 feet Southerly and Easterly of the following described line:

Commencing at the Southerly terminus of a course in the Easterly line of Orange Terrace Parkway (Lot "A") of Tract 22551, as shown by map on file in Book 187 of Maps, at pages 62 through 66 thereof, Records of Riverside County, California, as being N.37°50'26"E., a distance of 586.60 feet;

Thence N.37°50'26"E. along said Easterly line, a distance of 87.60 feet to the point of beginning of said line description;

Thence S.52°09'34"E., a distance of 539.83 feet;

Thence Southeasterly on a curve concave Northeasterly, having a radius of 395.00 feet through an angle of 38°15'43", an arc length of 263.78 feet;

Thence N.89°34'43"E., a distance of 1549.91 feet;

Thence Northeasterly on a curve concave Northwesterly, having a radius of 400.00 feet through an angle of 36°08'24", an arc length of 252.31 feet;

Thence Northeasterly on a non-tangent curve concave Northwesterly, having a radius of 305.00 feet through an angle of 45°16'59", an arc length of 241.05 feet (the initial radial line bears S.44°47'24"E.);

Thence N.00°04'23"W., a distance of 1261.43 feet;

Thence Northwesterly on a curve concave Southwesterly, having a radius of 400.00 feet through an angle of 20°55'01", an arc length of 146.03 feet;

Thence N.00°04'23"W., a distance of 306.00 feet;

Thence Northeasterly on a non-tangent curve concave Northwesterly, having a radius of 400.00 feet through an angle of 22°50'21", an arc length

of 159.45 feet (the initial radial line bears S.67°14'02"E.);

Thence N.00°04'23"W., a distance of 1524.56 feet;

Thence Northwesterly on a curve concave Southwesterly, having a radius of 400.00 feet through an angle of 24°14'20", an arc length of 169.22 feet;

Thence N.00°04'23"W., a distance of 148.00 feet to a point hereinafter referred to as Point "A";

Thence continuing N.00°04'23"W., a distance of 20.00 feet to the termination of said line description.

TOGETHER WITH a strip of land 20.00 feet wide and 30.00 feet wide, the Southerly, Easterly, and Northerly line being described as follows:

Beginning at the hereinbefore mentioned Point "A" said point being the point of beginning of said 20.00 foot strip of land;

Thence N.89°55'37"E., a distance of 209.46 feet to a line parallel with and 1369.50 feet Westerly, measured at right angles from the North-South Center Section line of Section 22, Township 3 South, Range 4 West, S.B.M.;

Thence N.00°01'08"W. along said parallel line, also being the Easterly line of Parcel 9 of that Certain Parcel of land conveyed to A.S.D. by deed recorded January 9, 1985, as Instrument No. 4583, Official Records of Riverside County, California, a distance of 1157.37 feet to the Northerly line of said Section 22, also being the Southerly line of Section 15, Township 3 South, Range 4 West, S.B.M., and the centerline of said John F. Kennedy Drive;

Thence N.89°18'50"E. along said line, a distance of 0.03 feet to a line parallel with and 1369.50 feet Westerly measured at right angles from the North-South Center Section line of said Section 15;

Thence N.00°09'24"W. along said parallel line, also being the Easterly line of Parcel 8 of said parcel of land conveyed to A.S.D., a distance of 425.03 feet to the termination of said 20.00 foot strip of land, also being the point of beginning of said 30.00 foot strip of land;

Thence continuing N.00°09'24"W. along said line, a distance of 235.00 feet to the Northeast corner thereof;

338602

Thence S.89°18'50"W. along the Northerly line of said Parcel 8, a distance of 649.02 feet to the termination of said line description and said 30.00 foot strip of land.

MWC/HAF/lb

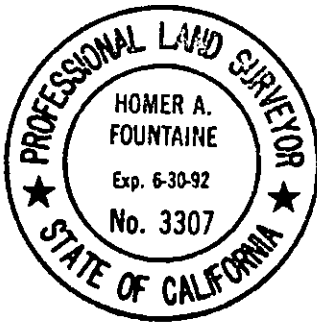

DESCRIPTION PREPARED UNDER THE SUPERVISION OF:

Homer A. Fontaine      7/7/88  
Homer A. Fontaine      Date  
J. F. DAVIDSON ASSOCIATES, INC.

DESCRIPTION APPROVAL 7/12/88  
George P. Hutchinson by JEF  
SURVEYOR, CITY OF RIVERSIDE

338602

SEE SHEET 2

SECTION 21, T.35S., R.4W., S.B.M.

ALESSANDRO TRACT  
M.B. 6/13 S.B.CO.

SLOPE EASEMENT

SEWER EASEMENT

STREET

(Vacated)

E 1815

TRACT 22653

PROPOSED

BLK 38

ORANGE

TERRACE PARKWAY

TRACT 22551  
M.B.

4

6

$R=395.00'$   
 $D=3915.43''$   
 $L=263.78'$

$1549.9'$   
 $1189^{\circ}34'43''E$   
 $629.39'$

$558^{\circ}09'34''E$   
 $539.83'$   
 $87.60'$

$586.50'$   
P.O.B.

$N32^{\circ}50'26''E$

• CITY OF RIVERSIDE, CALIFORNIA •

THIS PLAT IS SOLELY AN AID IN LOCATING THE PARCEL(S) DESCRIBED IN THE ATTACHED DOCUMENT IT IS NOT A PART OF THE WRITTEN DESCRIPTION THEREIN.

SHEET 1 OF 5

87-9755(P)

SCALE 1" = 200'

DRAWN BY TC DATE 6/15/88

SUBJECT SEWER AND SLOPE EASEMENT - TR. 22653

12301

SEE SHEET 3

**SEWER EASEMENT**

STREET

(Vacated)

E IRIS

BLK 39

ALESSANDRO TRACT

M.B. 6/13 S.B.CO.

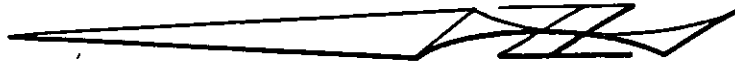

SECTION 21 & 22, T.35., R.4W., S.B.M.

**SLOPE EASEMENT**

E BROWN (Vacated) STREET

STREET

BLK 38

SEE SHEET 1

**CITY OF RIVERSIDE, CALIFORNIA**

THIS PLAT IS SOLELY AN AID IN LOCATING THE PARCEL(S) DESCRIBED IN THE ATTACHED DOCUMENT. IT IS NOT A PART OF THE WRITTEN DESCRIPTION THEREIN.

SHEET 2 OF 5

87  
9755(P)

SCALE: 1" = 200'

DRAWN BY JE DATE 6/15/88

SUBJECT SEWER AND SLOPE EASEMENT, TR. 22653

ALESSANDRO TRACT  
N.B. 61/3 S.B.CO.

338602

BLK 29



SECTION 22, T.33S, R.4W, S.B.M.

BLK 39

E GENTIAN (Vacated)

SEE SHEET 4

AVENUE

2

SLOPE  
EASEMENT

$R = 400.00'$   
 $\Delta = 22^{\circ}50'21''$   
 $L = 159.45'$   
 $S56^{\circ}14'02''E (R)$

$R = 400.00'$   
 $\Delta = 20^{\circ}55'01''$   
 $L = 146.03'$   
 $N69^{\circ}00'36''E (R)$

22653

TRACT

PROPOSED

SEWER  
EASEMENT

SEE SHEET 2

• CITY OF RIVERSIDE, CALIFORNIA •

THIS PLAT IS SOLELY AN AID IN LOCATING THE PARCEL(S) DESCRIBED IN THE ATTACHED DOCUMENT. IT IS NOT A PART OF THE WRITTEN DESCRIPTION THEREIN.

SHEET 3 OF 5

87  
9755(P)

SCALE: 1" = 200'

DRAWN BY AE DATE 6/15/88

SUBJECT SEWER AND SLOPE EASEMENT - TR. 22653

12361



338602

2

SEE SHEET 5

Ely. line of parcel conveyed to A.S.D. by Deed recorded January 9, 1985 as Inst. No. 4583, O.R. Riv. Co., Calif.

BLK 29

ALESSANDRO TRACT  
M.B. 6/13 S.B. Co.



SECTION 23, T. 35S., R. 11W., S.B.M.

POINT "A"  
N100°04'23"W  
20.00'

N100°04'23"W  
148.00'

N89°55'37"E  
209.46'

N55°41'17"E (R)  
R=400.00'  
Δ=24°14'20"  
L=169.22'

SLOPE EASEMENT

SEWER EASEMENT

22653

TRACT

PROPOSED

SEE SHEET 3

• CITY OF RIVERSIDE, CALIFORNIA •

THIS PLAT IS SOLELY AN AID IN LOCATING THE PARCEL(S) DESCRIBED IN THE ATTACHED DOCUMENT. IT IS NOT A PART OF THE WRITTEN DESCRIPTION THEREIN.

SHEET 4 OF 5

87-9755(P)

SCALE: 1" = 200'

DRAWN BY AE DATE 6/15/88

SUBJECT SEWER AND SLOPE EASEMENT - TR. 22653

1230!

338602

ALESSANDRO TRACT  
M.B. 6/13 S.B.CO.

BLK 19

BLK 29

SECTION 15 & 22, T.3S, R.4W, S.B.M.

S'y line Section 15

E JOHN F. KENNEDY (Vacated)

N'y line Section 22

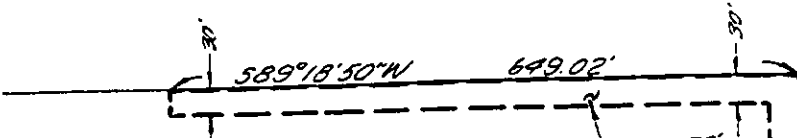

1'00°09'24" W  
235.00'

EASEMENT

DRIVE

SEWER

1157.37'

100°21'08" W

S'y line of parcel conveyed to A.S.D.  
by Deed rec. January 9, 1985 as Inst.  
No. 4583, O.R. Riv. Co., Calif.

SEE SHEET 4

CITY OF RIVERSIDE, CALIFORNIA

THIS PLAT IS SOLELY AN AID IN LOCATING THE PARCEL(S) DESCRIBED IN THE ATTACHED DOCUMENT. IT IS NOT A PART OF THE WRITTEN DESCRIPTION THEREIN.

SHEET 5 OF 5

87-9755(P)

SCALE: 1" = 200'

DRAWN BY DE DATE 6/15/88

SUBJECT SEWER EASEMENT - TR. 22653