

67286

When recorded mail to:

City Clerk's Office
City of Riverside
City Hall, 3900 Main Street
Riverside, California 92522

FREE RECORDING

This instrument is for the benefit of the City of Riverside and is entitled to be recorded without fee. (Government Code 6103)

RECEIVED FOR RECORD

Min. Post Street S.M.

MAR 3 1989

Recorded in Official Records of Riverside County, California

William E. Conroy
Recorder

Fees \$

FOR RECORDER'S OFFICE USE ONLY

Project: 7414 Freda Avenue
Building Permit

12383

GRANT DEED

JUAN G. NAVARRO and ERNESTINA NAVARRO, husband and wife, Grantors, FOR VALUABLE CONSIDERATION, receipt of which is hereby acknowledged, do hereby grant to the CITY OF RIVERSIDE, a municipal corporation, the real property in the City of Riverside, County of Riverside, State of California, described as follows:

The northwesterly 8.00 feet of Lot 14 of St. Frances Heights, on file in Book 11, Page 41 of Maps, records of said Riverside County.

Area - 400 square feet.

Dated

Ricardo E. Castillo

Juan G. Navarro
JUAN G. NAVARRO

Ernestina Navarro
ERNESTINA NAVARRO

FEBRUARY 24, 1989

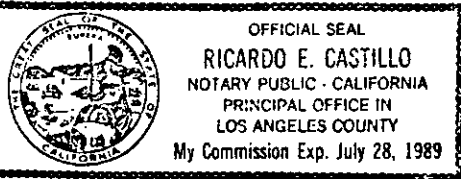

CONSENT TO RECORDATION

THIS IS TO CERTIFY that the interest in real property conveyed by the within instrument to the City of Riverside, California, a Municipal Corporation, is hereby accepted by the undersigned officer on behalf of the City Council of said City pursuant to authority conferred by Resolution No. 14883 of said City Council adopted January 25, 1983, and the grantee consents to recordation thereof by its duly authorized officer.

Dated

3/3/89

[Signature]
Title

0005u/m - 0431u/c

APPROVED AS TO FORM

Kathleen M. Gonzell
ASST. CITY ATTORNEY

12383

ON APPROVAL 2/23/89
George P. Mitchell
SURVEYOR, CITY OF RIVERSIDE

67286

ST. FRANCES
HEIGHTS
MB 11/01

FREDA AVENUE

N55°58'E

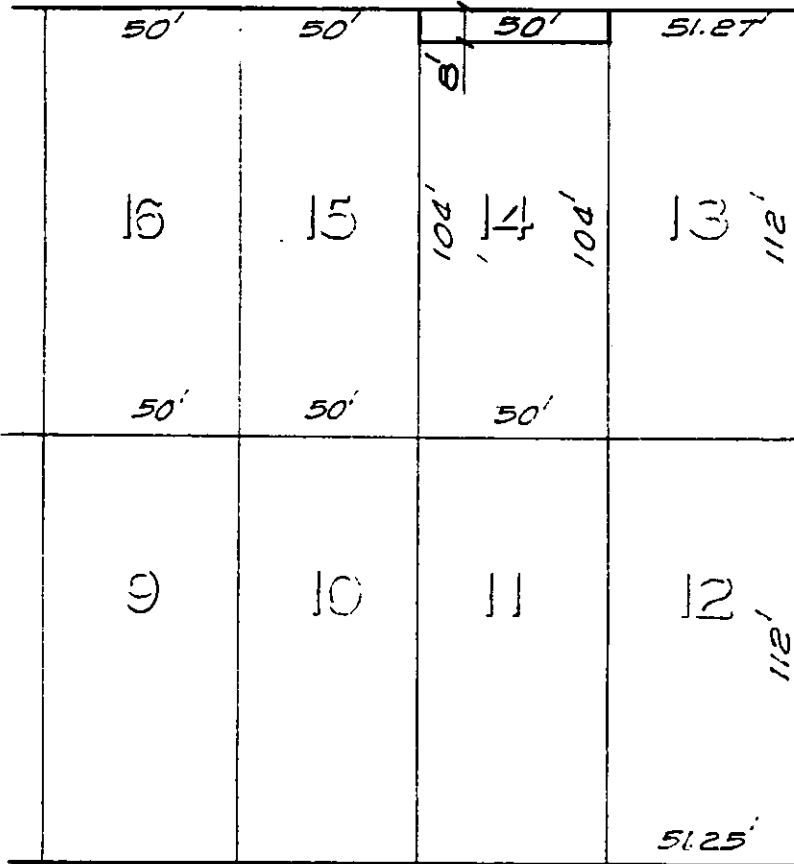

• CITY OF RIVERSIDE, CALIFORNIA •

THIS PLAT IS SOLELY AN AID IN LOCATING THE PARCEL(S) DESCRIBED IN THE ATTACHED DOCUMENT. IT IS NOT A PART OF THE WRITTEN DESCRIPTION THEREIN.

SHEET 1 OF 1

5/36

SCALE: 1" = 50'

DRAWN BY GS DATE 2/22/89

SUBJECT 7414 FREDA AVE., BLDG. PERMIT

12383