

318805

ded mail to:

City Hall, 3900 Main Street
Riverside, California 92522

FREE RECORDING

This instrument is for the benefit of the City of Riverside and is entitled to be recorded without fee. (Government Code 6103)

Project: R-41-812
7454 Indiana Avenue

RECEIVED FOR RECORD

30 Min. Past 1 o'clock

SEP 15 1989

Recorded in Official Records of Riverside County, California

William S. Starnely
Recorder

Fees \$

FOR RECORDER'S OFFICE USE ONLY

12526

GRANT DEED

CHARLES L. SMITH and JOANN SMITH, Trustee of The Smith Family Trust, dated May 7, 1982, Grantors, FOR VALUABLE CONSIDERATION, receipt of which is hereby acknowledged, do hereby grant to the CITY OF RIVERSIDE, a municipal corporation, the real property in the City of Riverside, County of Riverside, State of California, described as follows:

See attached property description as described in Exhibit "A" attached hereto and incorporated within this document.

Dated August 21, 1989

APPROVED AS TO FORM
Carolyn Confer 9/11/89
CAROLYN CONFER
ASSISTANT CITY ATTORNEY

CHARLES L. SMITH and JOANN SMITH,
Trustee of The Smith Family Trust,
dated May 7, 1982

Charles L. Smith

CHARLES L. SMITH - Trustee

Joann Smith

JOANN SMITH - Trustee

CONSENT TO RECORDATION

THIS IS TO CERTIFY that the interest in real property conveyed by the within instrument to the City of Riverside, California, a Municipal Corporation, is hereby accepted by the undersigned officer on behalf of the City Council of said City pursuant to authority conferred by Resolution No. 14883 of said City Council adopted January 25, 1983, and the grantee consents to recordation thereof by its duly authorized officer.

Dated 9/15/89

Title Property Services Manager

0736u/b

Assessor's Parcel 230-291-005

EXHIBIT "A"

The northwesterly 4.00 feet, as measured at right angles, of the northeasterly 85.00 feet, of Lot 63 of Madison Park as shown by map on file in Book 14 of Maps, at pages 82 and 83, Official Records of Riverside County, California.

Area - 340.0 square feet.

DESCRIPTION APPROVAL 8/16/89
George P. Hutchinson by KQP
SURVEYOR, CITY OF RIVERSIDE

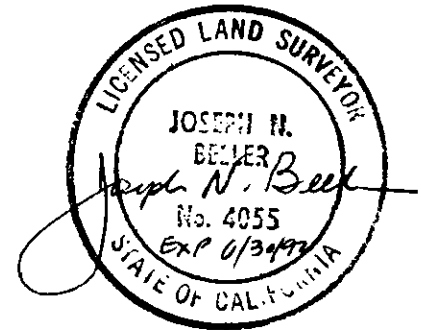

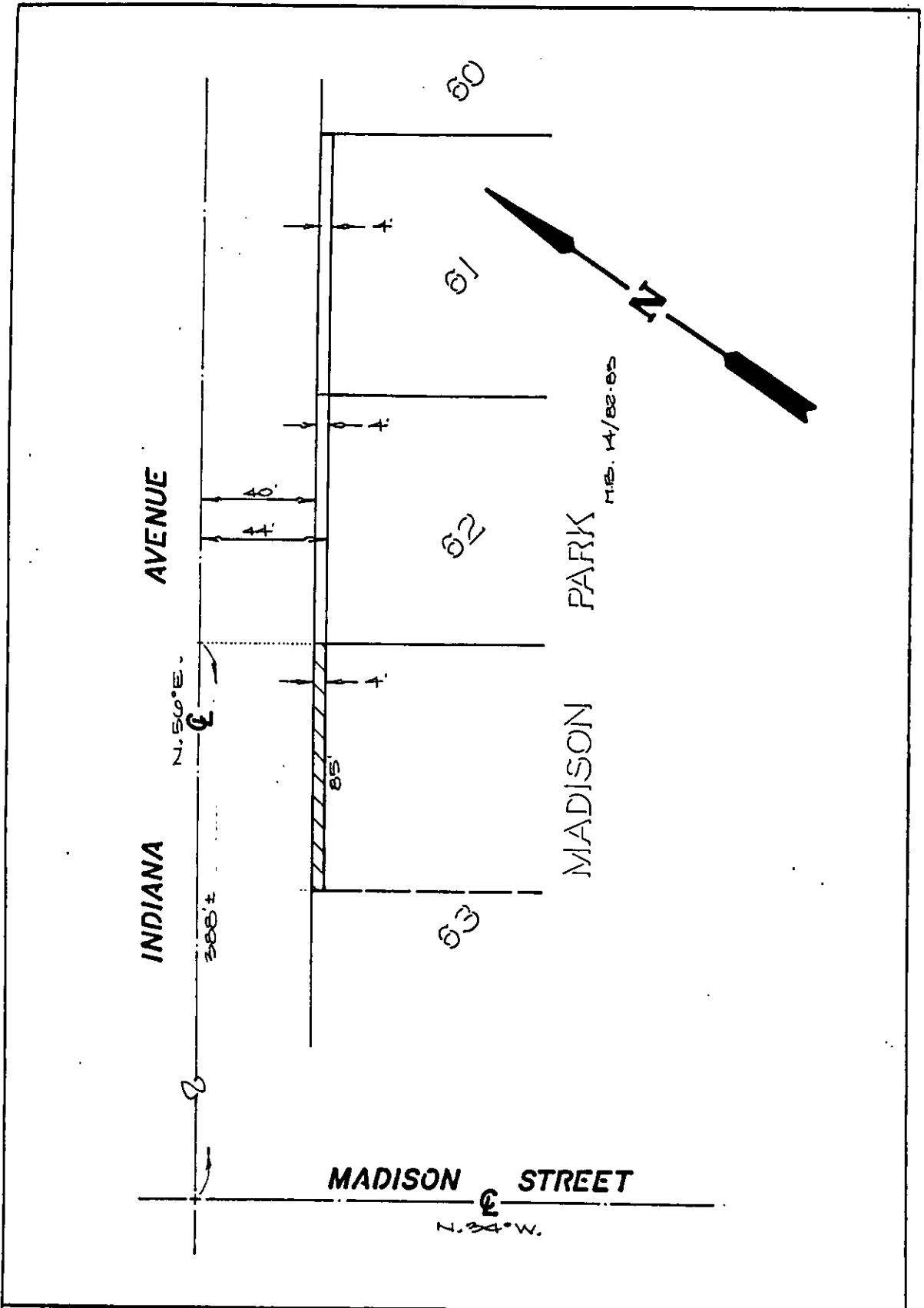

• CITY OF RIVERSIDE, CALIFORNIA •

THIS PLAT IS SOLELY AN AID IN LOCATING THE PARCEL(S) DESCRIBED IN THE ATTACHED DOCUMENT. IT IS NOT A PART OF THE WRITTEN DESCRIPTION THEREIN.		SHEET <u>1</u> OF <u>1</u>
SCALE: 1" = 40'	DRAWN BY ME DATE 9/12/88	SUBJECT ZONING CASE P-41-812