

404230

When recorded mail to:

City Clerk's Office
City of Riverside
City Hall, 3900 Main Street
Riverside, California 92522

FREE RECORDING

This instrument is for the benefit of the City of Riverside and is entitled to be recorded without fee. (Government Code 6103)

RECEIVED FOR RECORD

Min. Post. 2/1/89

NCV 17'1989

Recorded in Official Records of Riverside County, California

William S. Comely
Recorder

Fees \$

FOR RECORDER'S OFFICE USE ONLY

Project: 2833 University Avenue
Building Permit

12573

GRANT DEED

DEVONNE W. ARMSTRONG and ANNETTE B. ARMSTRONG, husband and wife as joint tenants, Grantors, FOR VALUABLE CONSIDERATION, receipt of which is hereby acknowledged, do hereby grant to the CITY OF RIVERSIDE, a municipal corporation, the real property in the City of Riverside, County of Riverside, State of California, described as follows:

The southwesterly 10.50 feet of Lot 29 in Block 11 of White's Addition to Riverside, as shown by map on file in Book 6, Page 48 of Maps, records of San Bernardino County, California.

Area - 630.0 square feet.

Dated 11-9-89

APPROVED AS TO FORM

[Signature]
CITY ATTORNEY
[Signature]
DEVONNE W. ARMSTRONG
[Signature]
ANNETTE B. ARMSTRONG

DESCRIPTION APPROVAL 11/2/89
George P. Hutchison
SURVEYOR, CITY OF RIVERSIDE

CONSENT TO RECORDATION

THIS IS TO CERTIFY that the interest in real property conveyed by the within instrument to the City of Riverside, California, a Municipal Corporation, is hereby accepted by the undersigned officer on behalf of the City Council of said City pursuant to authority conferred by Resolution No. 14883 of said City Council adopted January 25, 1983, and the grantee consents to recordation thereof by its duly authorized officer.

Dated 11/17/89

Title Property Services Manager

K/0884u/w
10/19/89

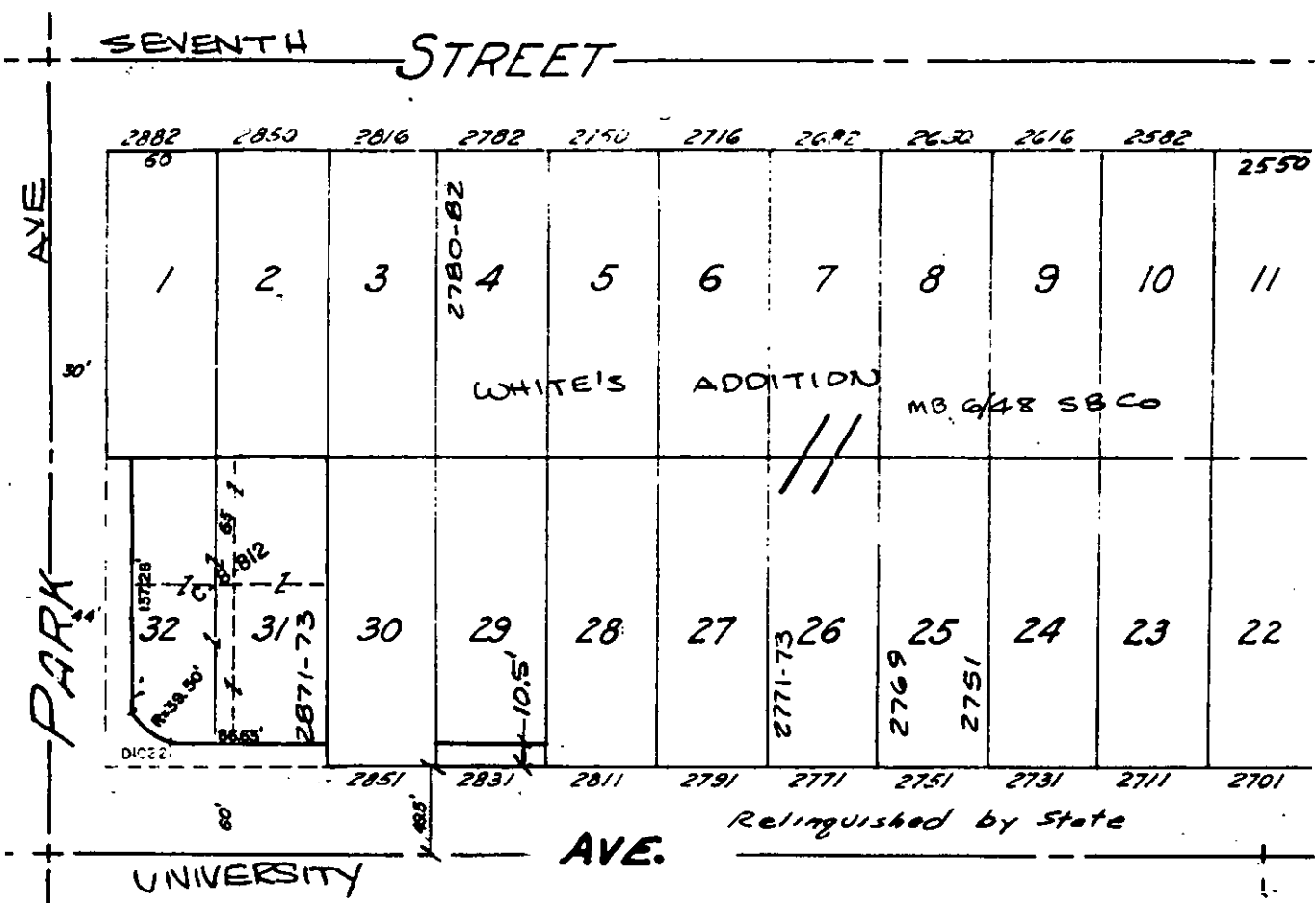
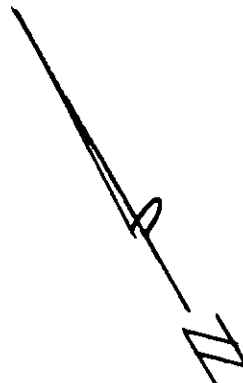

• CITY OF RIVERSIDE, CALIFORNIA •

THIS PLAT IS SOLELY AN AID IN LOCATING THE PARCEL(S) DESCRIBED IN THE ATTACHED DOCUMENT. IT IS NOT A PART OF THE WRITTEN DESCRIPTION THEREIN.

SHEET 1 OF 1

3/10

SCALE: 1" = 100'

DRAWN BY KP DATE 11/2/89

SUBJECT 2833 UNIVERSITY AVE