

404234

When recorded mail to:

City Clerk's Office
City of Riverside
City Hall, 3900 Main Street
Riverside, California 92522

FREE RECORDING

This instrument is for the benefit of the City of Riverside and is entitled to be recorded without fee. (Government Code 6103)

Project: 7659 Freda Avenue
Building Permit

RECEIVED FOR RECORD

Min. Post. 2 o'clock P.M.

NCV 17'1989

Recorded in Official Records
of Riverside County, California

William S. Egan
Recorder
Fees \$

FOR RECORDER'S OFFICE USE ONLY

12577

GRANT DEED

DENNIS RAY BROOKER, Grantor, FOR VALUABLE CONSIDERATION, receipt of which is hereby acknowledged, does hereby grant to the CITY OF RIVERSIDE, a municipal corporation, the real property in the City of Riverside, County of Riverside, State of California, described as follows:

The southeasterly 8.00 feet of Lot 34 of Monterey Subdivision, as shown by map on file in Book 12, Page 24 of Maps, records of Riverside County, California.

Area - 373.7 square feet.

Dated 10 4 89

D. R. Brooker
DENNIS RAY BROOKER

DESCRIPTION APPROVAL 9/28/89

George P. Hutchinson
SURVEYOR, CITY OF RIVERSIDE



APPROVED AS TO FORM

Kathleen M. Arroyo
ASST. CITY ATTORNEY

CONSENT TO RECORDATION

THIS IS TO CERTIFY that the interest in real property conveyed by the within instrument to the City of Riverside, California, a Municipal Corporation, is hereby accepted by the undersigned officer on behalf of the City Council of said City pursuant to authority conferred by Resolution No. 14883 of said City Council adopted January 25, 1983, and the grantee consents to recordation thereof by its duly authorized officer.

Dated 11/17/89

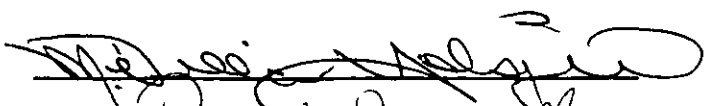
Title Property Services Manager

0805u/n

MONTEREY
SUBDIVISION
M. B. 12/24 RIV. CO.

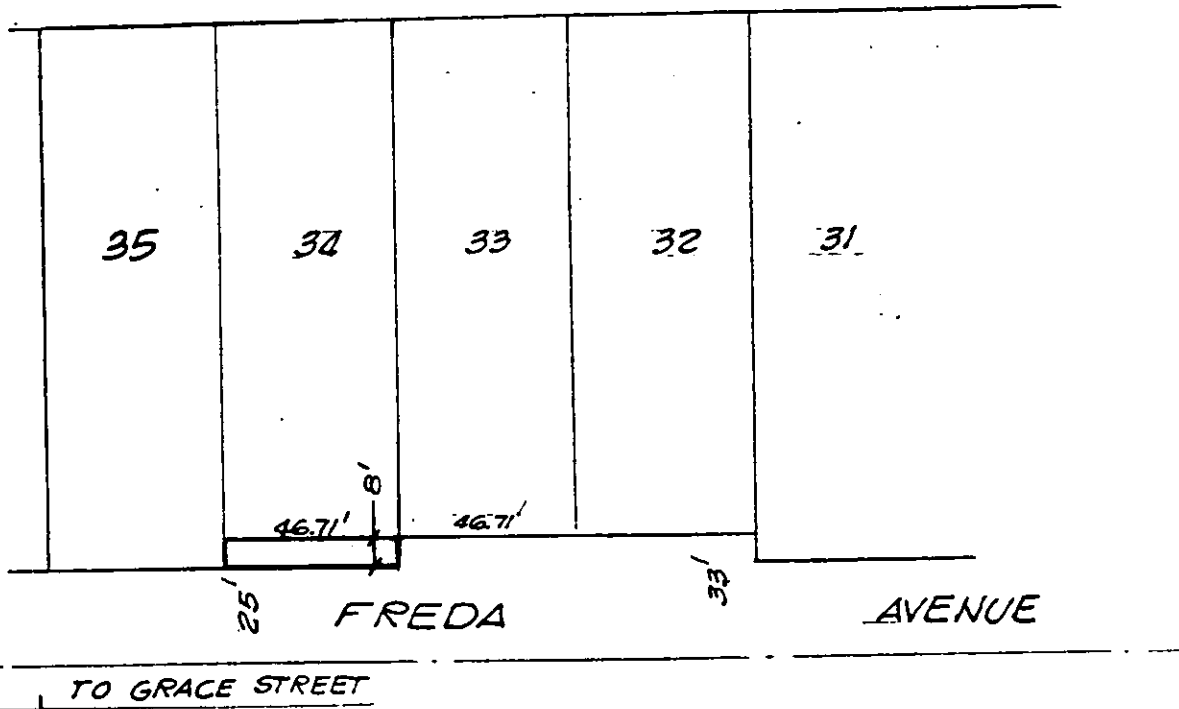
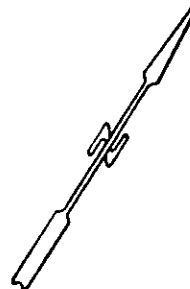

• CITY OF RIVERSIDE, CALIFORNIA •

THIS PLAT IS SOLELY AN AID IN LOCATING THE PARCEL(S) DESCRIBED IN THE ATTACHED DOCUMENT. IT IS NOT A PART OF THE WRITTEN DESCRIPTION THEREIN.

SHEET 1 OF 1

5/38

SCALE: 1" = 50'

DRAWN BY GS DATE 10/8/80

SUBJECT 7659 FREDA AVE., BLDG. PERMIT