

067878

When recorded mail to:

City Clerk's Office
City of Riverside
City Hall, 3900 Main Street
Riverside, California 92522

FREE RECORDING
This instrument is for the benefit
of the City of Riverside and is
entitled to be recorded without
fee. (Government Code 6103)

RECEIVED FOR RECORD

Min. Past *Loock* M.

FEB 23 1990

Recorded in Official Records
of Riverside County, California

William E. Egan
Recorder

Fees \$ *0*

X

FOR RECORDER'S OFFICE USE ONLY

Project: 2201 Ninth Street
Building Permit

12630

GRANT DEED

MARVIN L. CHENEY and DENISE T. CHENEY, husband and wife as joint tenants, Grantors, FOR VALUABLE CONSIDERATION, receipt of which is hereby acknowledged, do hereby grant to the CITY OF RIVERSIDE, a municipal corporation, the real property in the City of Riverside, County of Riverside, State of California, described as follows:

The northerly 2.50 feet of Lot 40 of Garfield Place, as shown by map recorded in Book 6, Page 27 of Maps, records of San Bernardino County, California.

Area - 125.0 square feet.

Dated 2/16/90

Marvin L. Cheney
MARVIN L. CHENEY

Denise T. Cheney
DENISE T. CHENEY

DESCRIPTION APPROVAL 2/15/90
George P. Hutchinson by *GP*
SURVEYOR, CITY OF RIVERSIDE



Witnessed By:
Jessica Padilla
Jessica Padilla

APPROVED AS TO FORM

Clarice Sweeney
ASST. CITY ATTORNEY

CONSENT TO RECORDATION

THIS IS TO CERTIFY that the interest in real property conveyed by the within instrument to the City of Riverside, California, a Municipal Corporation, is hereby accepted by the undersigned officer on behalf of the City Council of said City pursuant to authority conferred by Resolution No. 14883 of said City Council adopted January 25, 1983, and the grantee consents to recordation thereof by its duly authorized officer.

Dated

2/23/90

Title

Property Services Manager

0958u/a

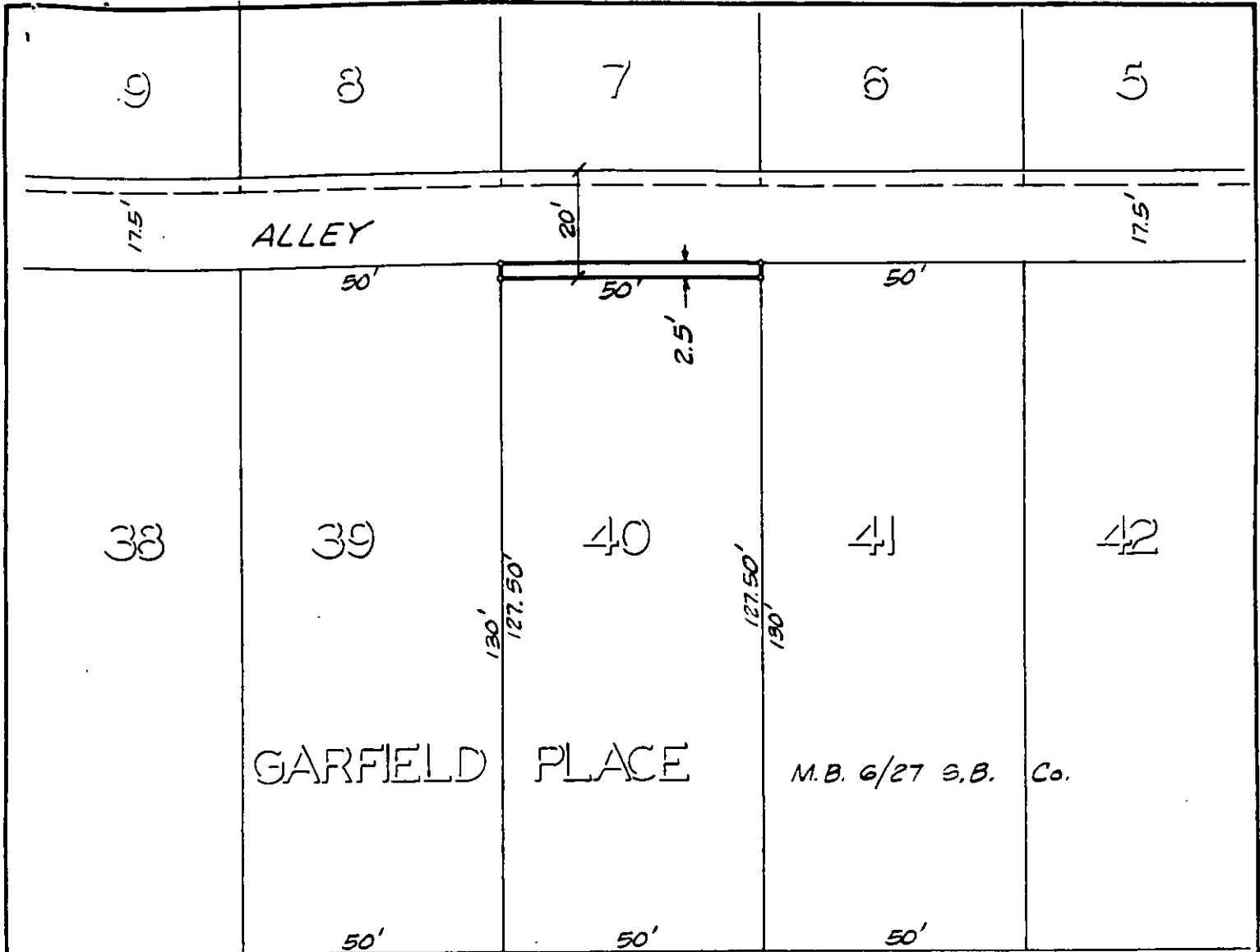

NINTH

STREET

TO EUCALYPTUS ST.

TO KANSAS AVE.



• CITY OF RIVERSIDE, CALIFORNIA •

THIS PLAT IS SOLELY AN AID IN LOCATING THE PARCEL(S) DESCRIBED IN THE ATTACHED DOCUMENT. IT IS NOT A PART OF THE WRITTEN DESCRIPTION THEREIN.

SHEET 1 OF 1

3/13

SCALE: 1" = 30'

DRAWN BY K9S DATE 2/14/90

SUBJECT 2201 9TH ST. BLDG. PMT.