

018933

When recorded mail to:

City Clerk's Office
City of Riverside
City Hall; 3900 Main Street
Riverside, California 92522

FREE RECORDING

This instrument is for the benefit of the City of Riverside and is entitled to be recorded without fee. (Government Code §6103)

Project: 4368 Central Avenue

RECEIVED FOR RECORD
Min. Past 10:00 AM

JAN 17 1992

Recorded in Official Records
of Riverside County, California

Willie E. [Signature]
Recorder
Fees \$

FOR RECORDER'S OFFICE USE ONLY

13161

ACCESS EASEMENT

FOR VALUABLE CONSIDERATION, receipt of which is hereby acknowledged, GREGORY L. ZUCCOLOTTO and JULIETTE L. ZUCCOLOTTO, husband and wife as joint tenants, as to an undivided 1/2 interest, and WILLIAM F. JACKMAN and VICKIE L. JACKMAN, husband and wife as joint tenants, as to an undivided 1/2 interest, all as tenants in common, as Grantors, grant to the CITY OF RIVERSIDE, a municipal corporation, as Grantee, its successors and assigns, an easement and right-of-way for the purpose of providing ingress and egress from Central Avenue to the public facilities constructed and maintained by the grantee within adjoining easements, in, under, upon, over and along that certain real property located in the City of Riverside, County of Riverside, State of California, described as follows:

The westerly 10 feet of the easterly 15 feet of the southerly 96 feet of Lot 2 of Parent Navel Orange Tract, as shown by map on file in Book 20, Page 8 of Maps, records of Riverside County, California;

EXCEPTING THEREFROM the southerly 5 feet of said Lot 2.

DESCRIPTION APPROVAL 11/4/91
George P. Hutchinson by [Signature]
SURVEYOR, CITY OF RIVERSIDE



TOGETHER WITH the right to clear and keep clear said easement and right-of-way from any structures or trees and to enter upon and to pass and repass over and along said real property by Grantee, its officers, agents and employees and by persons under contract with said Grantee and their officers, agents and employees, whenever and wherever necessary for the purpose of constructing, reconstructing, maintaining, operating, inspecting, repairing, replacing, relocating, renewing and removing said public facilities within the adjoining easements.

Dated 12/19/91

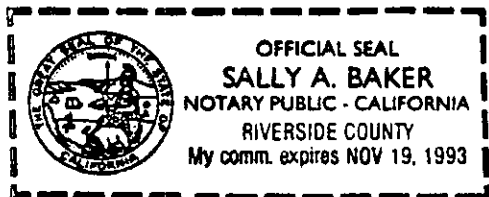

Gregory L. Zuccolotto
GREGORY L. ZUCCOLOTTO

Juliette L. Zuccolotto
JULIETTE L. ZUCCOLOTTO

William F. Jackman
WILLIAM F. JACKMAN

Vickie L. Jackman
VICKIE L. JACKMAN

Sally A. Baker

APPROVED AS TO FORM
JOHN WOODHEAD, CITY ATTORNEY
BY Robert A. Laws
Legal Department

CONSENT TO RECORDATION

THIS IS TO CERTIFY that the interest in real property conveyed by the within instrument to the City of Riverside, California, a Municipal Corporation, is hereby accepted by the undersigned officer on behalf of the City Council of said City pursuant to authority conferred by Resolution No. 14883 of said City Council adopted January 25, 1983, and the grantee consents to recordation thereof by its duly authorized officer.

Dated January 17, 1992

[Signature]
Real Property Services Manager
of the City of Riverside

1842u/a

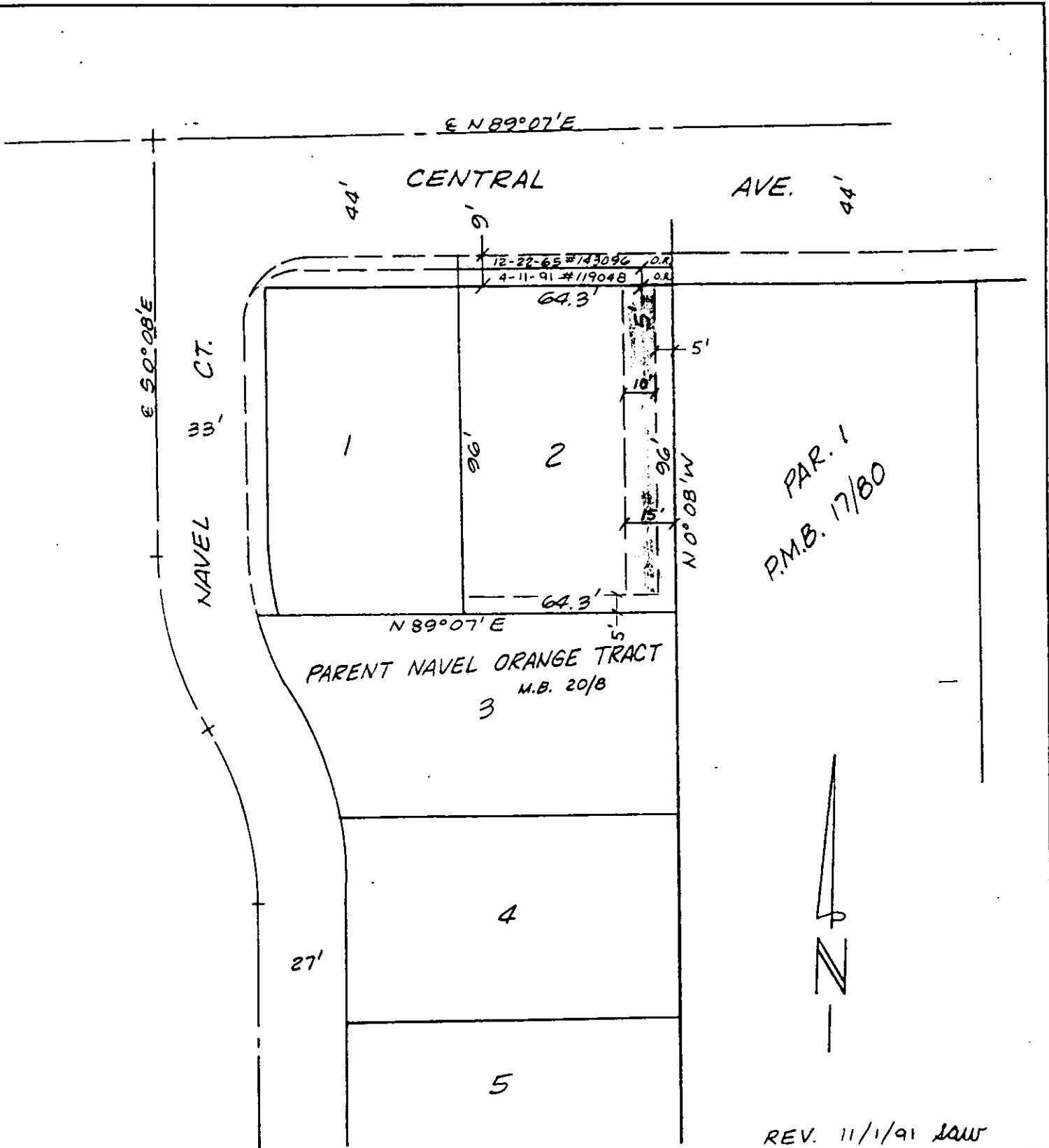

PAR. 1
P.M.B. 17/80

PARENT NAVEL ORANGE TRACT
M.B. 20/8

REV. 11/1/91 LAW

• CITY OF RIVERSIDE, CALIFORNIA •

THIS PLAT IS SOLELY AN AID IN LOCATING THE PARCEL(S) DESCRIBED IN THE ATTACHED DOCUMENT. IT IS NOT A PART OF THE WRITTEN DESCRIPTION THEREIN.	SHEET <u>1</u> OF <u>1</u>	4/22
SCALE: 1" = 40'	DRAWN BY <u>K92</u> DATE <u>10/25/90</u>	SUBJECT <u>R-92-889-4368 CENTRAL AVE.</u>

13/6/