

When recorded mail to:

City Clerk's Office
City of Riverside
City Hall, 3900 Main Street
Riverside, California 92522

RECEIVED FOR RECORD
AT 8:00 O'CLOCK

FEB 24 1995

FREE RECORDING

This instrument is for the benefit of the City of Riverside and is entitled to be recorded without fee. (Government Code §6103)

Recorded in Official Records of Riverside County, California

Recorder [Signature] Fees \$ [Signature]

FOR RECORDER'S OFFICE USE ONLY

Project: Canyon Crest Widening
Pearblossom Dr. to Martin Luther King Blvd.

GRANT DEED

THE REGENTS OF THE UNIVERSITY OF CALIFORNIA, a public corporation, as Grantor, FOR VALUABLE CONSIDERATION, receipt of which is hereby acknowledged, does hereby grant to the CITY OF RIVERSIDE, a municipal corporation of the State of California, as Grantee, its successors and assigns, the real property located in the City of Riverside, County of Riverside, State of California. described as follows:

THAT portion of Lot "B" of map of the subdivision of Section 30, Township 2 South, Range 4 West, San Bernardino Meridian, on file in Book 2, page 37 of Maps, records of Riverside County, California, described as follows:

BEGINNING at the intersection of the southerly line of said Lot "B" with the southwest corner of Parcel 11 of those certain parcels of land conveyed to the County of Riverside by deed recorded June 15, 1959 as Instrument No. 51940 of Official Records of Riverside County, California;

THENCE northerly, along the westerly line of Parcel 11, a distance of 300.00 feet;

THENCE southerly, in a direct line, to a point in the southerly line of said Lot

"B" distant thereon 8.00 feet westerly from said southwest corner of said Parcel 11;

THENCE easterly, along said southerly line of said Lot "B", 8.00 feet to said POINT OF BEGINNING.

Area: 1,200 square feet.

Dated 11/23/94

THE REGENTS OF THE UNIVERSITY OF CALIFORNIA, a public corporation

by Patricia L. Mivette

title _____

by _____

title _____

DESCRIPTION APPROVAL 6/9/94
Mark S. Brown by LF
SURVEYOR, CITY OF RIVERSIDE

APPROVED AS TO FORM
[Signature]
UNIVERSITY OF CALIFORNIA
OF THE UNIVERSITY OF CALIFORNIA



GENERAL ACKNOWLEDGEMENT

State of California }
County of Alameda } ss

On November 23, 1994, before me Estelle Leighton Bryan
(date) (name)

a Notary Public in and for said State, personally appeared

Rosemary L. Trivette, Secretary
Name(s) of Signer(s)

personally known to me - OR - proved to me on the basis of satisfactory evidence to be the person(s) whose name(s) is/are subscribed to the within instrument and acknowledged to me that he/she/they executed the same in his/her/their authorized capacity(ies), and that by his/her/their signature(s) on the instrument the person(s), or the entity upon behalf of which the person(s) acted, executed the instrument.

WITNESS my hand and official seal.

[Signature]
Signature



OPTIONAL SECTION

CAPACITY CLAIMED BY SIGNER

- () Attorney-in-fact
- () Corporate Officer(s)

Title _____

Title _____

- () Guardian/Conservator
- () Individual(s)
- () Trustee(s)
- () Other

- () Partner(s)
- () General
- () Limited

The party(ies) executing this document is/are representing:

CONSENT TO RECORDATION

THIS IS TO CERTIFY that the interest in real property conveyed by the within instrument to the City of Riverside, California, a municipal corporation, is hereby accepted by the undersigned officer on behalf of the City Council of said City pursuant to authority conferred by Resolution No. 18233 of said City Council adopted May 11, 1993, and the grantee consents to recordation thereof by its duly authorized officer.

Dated 2/15/95 _____

[Signature]
Real Property Services Manager
of the City of Riverside

ccwiden.ded

APPROVED AS TO FORM
[Signature]
Stan T. Yamamoto, City Attorney



SUB. OF SEC. 30
T. 2 S., R. 4 W., S.B.M.
M.B. 2/37
R.V. CO.
LOT "B"

253-090-007

R.S. 33/8

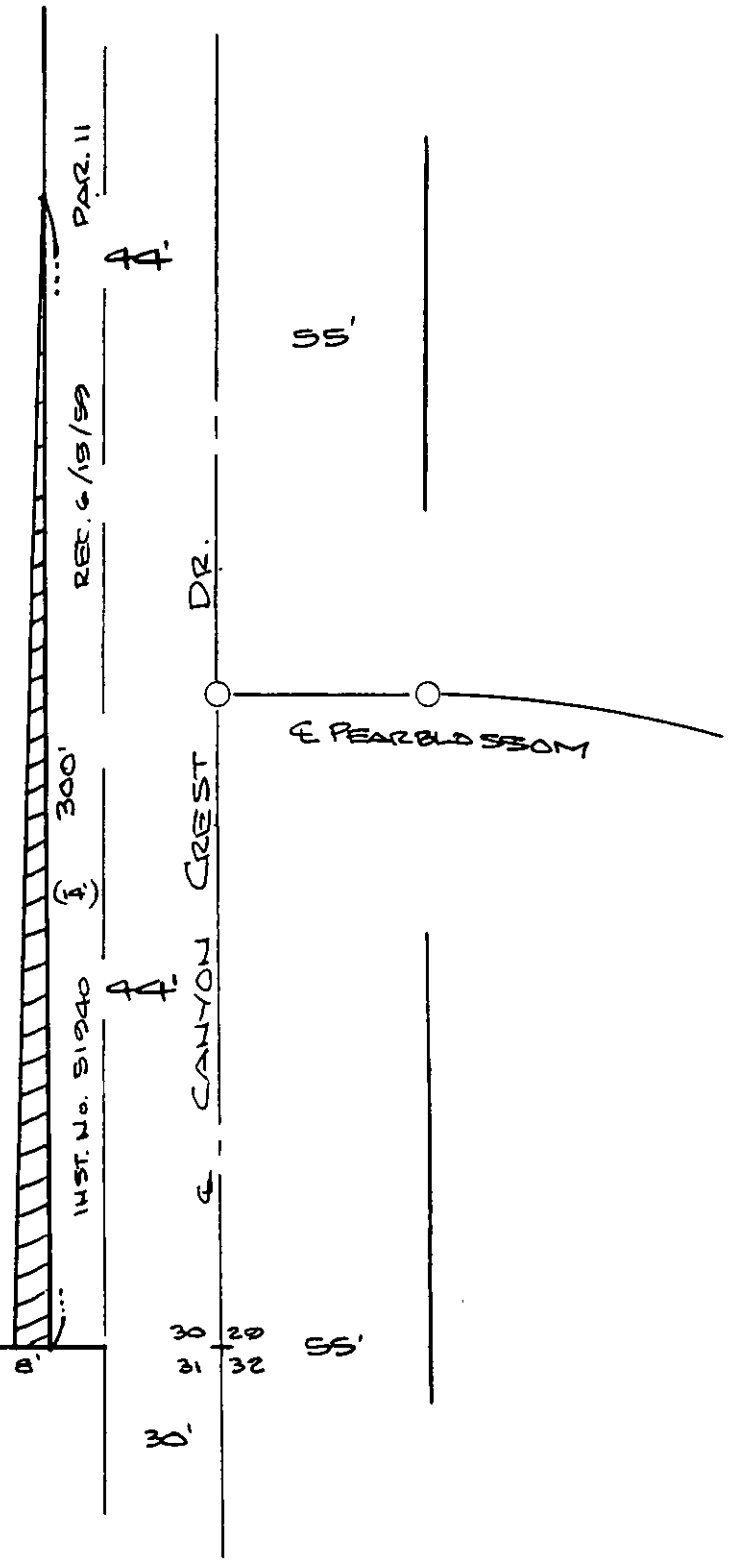

• CITY OF RIVERSIDE, CALIFORNIA •

THIS PLAT IS SOLELY AN AID IN LOCATING THE PARCEL(S) DESCRIBED IN THE ATTACHED DOCUMENT. IT IS NOT A PART OF THE WRITTEN DESCRIPTION THEREIN.

SHEET 1 OF 1

12/21

SCALE: 1" = 50'

DRAWN BY WF DATE 6/8/99

SUBJECT CANYON CREST WIDENING