

13944

**REQUEST FOR RECORDATION**

Request of City Clerk for recordation of this instrument, and return to, City Clerk, City Hall, 3900 Main Street Riverside, CA 92522

NC-1-912

RESOLUTION NO. 18494

(5-24-74)  
211164

1  
2  
3  
6  
7  
8  
9  
10  
11  
12  
13  
14  
15  
16  
17  
18  
19  
20  
21  
22  
23  
24  
25  
26  
27

**FREE RECORDING-**  
Exempt Pursuant to  
Government Code §5103

A RESOLUTION OF THE CITY COUNCIL OF THE CITY OF RIVERSIDE, CALIFORNIA, CHANGING THE NAME OF ALL THAT PORTION OF BOX SPRINGS BOULEVARD WITHIN THE CITY OF RIVERSIDE LOCATED BETWEEN MARTIN LUTHER KING BOULEVARD (FORMERLY KNOWN AS PENNSYLVANIA AVENUE) AND QUAIL VALLEY COURT TO SYCAMORE CANYON BOULEVARD.

13944

WHEREAS the future development of Sycamore Canyon Business Park, an approximately 1,403 acre industrially planned area generally located on the west side of I-215 between Alessandro Boulevard and Fair Isle Drive, includes the construction of Sycamore Canyon Boulevard as a 110-foot-wide major arterial extending from Fair Isle Drive on the north to Alessandro Boulevard to the south; and

WHEREAS the adopted alignment of Sycamore Canyon Boulevard will require the vacation of a portion of Box Springs Boulevard and possible street name change for existing sections of Box Springs Boulevard and other sections of right-of-way south of the vacation; and

WHEREAS in Street Name Change No. NC-1-912, the City Council considered the request to change the name of all or a portion of Box Springs Boulevard with the City of Riverside between Pennsylvania Avenue (now known as Martin Luther King Boulevard) and its terminus southerly of Eastridge Avenue and also possible street name changes for River Crest Drive, Crest Ridge Drive (an unimproved "paper" street) and Fisher Road, generally located between Box Springs Boulevard and I-215 northerly of Eastridge Avenue in the Sycamore Canyon Business Park area; and

WHEREAS on August 11, 1992, the City Council approved the name changes as recommended by the Planning Commission of the City of Riverside which would not require changing any of the existing street names for those streets within the affected area located east of the future alignment of Sycamore Canyon Boulevard; however, a portion of proposed Crest Ridge Drive east of the future alignment of Sycamore Canyon Boulevard would be renamed Box Springs Boulevard and become an extension of that street, and that portion of Box Springs Boulevard generally situated between Quail Valley Court and Pennsylvania Avenue (now known as Martin Luther King Boulevard) approximately two and one-half miles in length would be renamed Sycamore Canyon Boulevard; and

WHEREAS the County of Riverside has now approved the name change for that portion of Box Springs Boulevard approximately 0.8 miles in length located within the unincorporated area of the County; and

WHEREAS it would now be appropriate to finalize the street name change as authorized by the City Council of the City of Riverside;

NOW, THEREFORE, BE IT RESOLVED by the City Council of the City of Riverside, California, that the name of that portion of BOX SPRINGS BOULEVARD between MARTIN LUTHER KING BOULEVARD (formerly known as PENNSYLVANIA AVENUE) and QUAIL VALLEY COURT described as follows:

That portion of Box Springs Boulevard lying southeasterly of that certain parcel of land shown as Segment "A" of Map of Relinquishment on file in Book 4,

1  
2  
3  
4  
5  
6  
7  
8  
9  
10  
11  
12  
13  
14  
15  
16  
17  
18  
19  
20  
21  
22  
23  
24  
25  
26  
27

Page 64 of State Highway Maps, recorded December 21, 1965 as Instrument No. 142694 of Official Records of Riverside County, California, and lying northerly of the north line of the south half of the Northeast Quarter of Section 4, Township 3 South, Range 4 West, San Bernardino Meridian, as said north line is shown by Parcel Map No. 24535, on file in Book 162 of Parcel Maps, pages 84 through 90 thereof, records of Riverside County, California.

**EXCEPTING** therefrom that portion of said Box Springs Boulevard not lying within the City Limits of the City of Riverside.

BE IT FURTHER RESOLVED that the City Clerk of the City of Riverside is authorized and directed to cause a certified copy of this resolution to be recorded in the office of the County Recorder of Riverside County, California.

ADOPTED by the City Council and signed by the Mayor and attested by the City Clerk this 10th day of May, 1994.

*Ronald L. Hoover*  
Mayor of the City of Riverside

Attest:

*Karen E. Lindquist*  
City Clerk of the City of Riverside

DESCRIPTION APPROVAL 5, 4, 94  
*M. S. Brown* by *WF*  
SURVEYOR, CITY OF RIVERSIDE

1 I, Karen E. Lindquist, City Clerk of the City of  
2 Riverside, California, hereby certify that the foregoing  
3 resolution was duly and regularly introduced and adopted at a  
4 meeting of the City Council of said City at its meeting held on  
5 the 10th day of May, 1994 , by the following vote,  
6 to wit:

7 Ayes: Councilmembers Moore, Kane, Clifford, Thompson and  
8 Pearson.

9 Noes: None.

10 Absent: Councilmember Defenbaugh.

11 IN WITNESS WHEREOF I have hereunto set my hand and  
12 affixed the official seal of the City of Riverside, California,  
13 this 10th day of May, 1994.

14 Karen E. Lindquist  
15 City Clerk of the City of Riverside  
16  
17  
18  
19  
20  
21  
22  
23  
24  
25  
26  
27

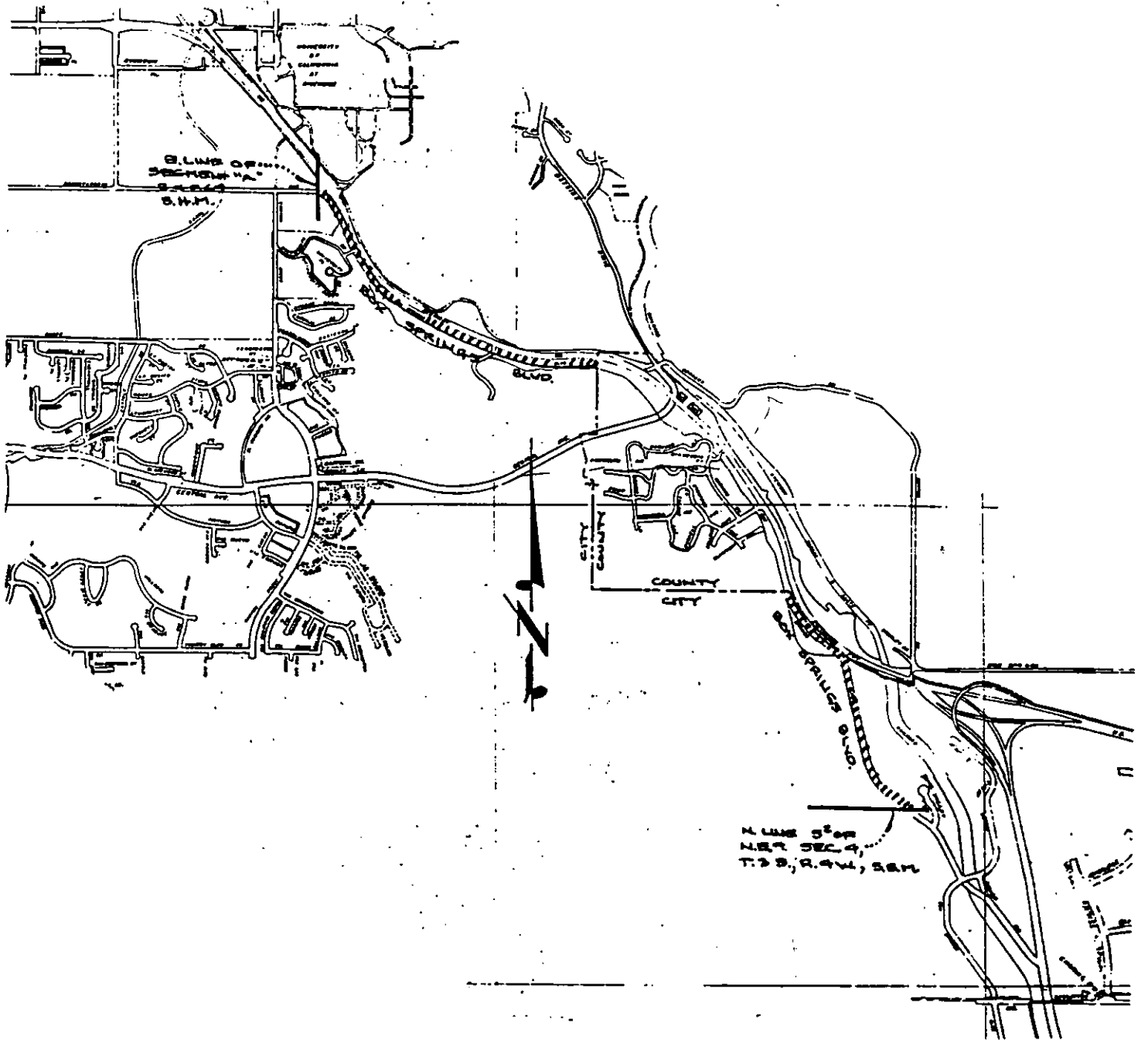

• CITY OF RIVERSIDE, CALIFORNIA •

42-5, 42-7  
42-8, 58-3  
58-5, 58-6

THIS PLAT IS SOLELY AN AID IN LOCATING THE PARCEL(S) DESCRIBED IN THE ATTACHED DOCUMENT. IT IS NOT A PART OF THE WRITTEN DESCRIPTION THEREIN.

SHEET 1 OF 1

11/

SCALE: 1" = N/A

DRAWN BY WF DATE 12/17/93

SUBJECT NC-001-912