

413954

RECEIVED FOR RECORD
AT 8:00 O'CLOCK

When recorded mail to:

City Clerk's Office
City of Riverside
City Hall, 3900 Main Street
Riverside, California 92522

NOV 12 1997

Recorded in Official Records
of Riverside County, California

Recorder

Fees \$

0
d

FREE RECORDING

This instrument is for the benefit
of the City of Riverside and is
entitled to be recorded without
fee. (Government Code §6103)

FOR RECORDER'S OFFICE USE ONLY

Project: Monroe Street Improvements
Parcel 8
A.P.N. 233-110-013

D - 14145

TREE PLANTING EASEMENT

FOR VALUABLE CONSIDERATION, receipt of which is hereby acknowledged, **WAYNE L. COVEY and PATRICIA L. COVEY, husband and wife as joint tenants**, as Grantors, grant to the **CITY OF RIVERSIDE**, a municipal corporation of the State of California, as Grantee, its successors and assigns, an easement and right-of-way for the planting, replanting, and maintaining of trees of such types as shall be designated by the City of Riverside in, under, upon, over and along the real property located in the City of Riverside, County of Riverside, State of California, described as follows:

That portion of Lot 1 in Block 24 of the Lands of the Riverside Land and Irrigating Company, as shown by map on file in Book 1, Page 70 of Maps, records of San Bernardino, California, described as follows:

COMMENCING at the most easterly corner of said Lot 1;

THENCE North 34°00'00" West, along the northeasterly line of said Lot 1, a distance of 142.01 feet to the **POINT OF BEGINNING** of the parcel of land being described;

THENCE South 56°00'00" West, at right angle to said northeasterly line, a distance of 6.00 feet;

THENCE North 34°00'00" West, parallel to said northeasterly line, a distance of 6.00 feet;

THENCE North 56°00'00" East, at right angle to the previous course, a distance of 6.00 feet to said northeasterly line;

THENCE South 34°00'00" East, along said northeasterly line, a distance of 6.00 feet to the POINT OF BEGINNING.

Area 36 square feet.

Said easement is to be used for all purposes proper and convenient in the planting, replanting and maintenance of trees, including the rights of ingress and egress, the temporary deposit of tools, equipment, machinery, vehicles, materials and supplies used in the performance of said work, and for similar and related purposes by the City of Riverside, its officers, employees, agents or contractors.

Dated 10-3-97

Wayne L. Covey

WAYNE L. COVEY
Patricia L. Covey

PATRICIA L. COVEY

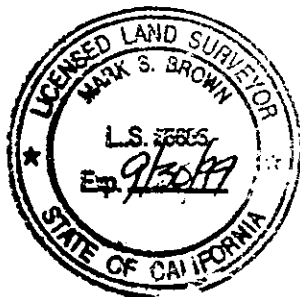

DESCRIPTION APPROVAL: 9/10/97
Mark S. Brown

SURVEYOR, CITY OF RIVERSIDE

GENERAL ACKNOWLEDGMENT

State of California }
County of Riverside } ss

On 10-3-97, before me Michael N. Green
(date) (name)

a Notary Public in and for said State, personally appeared
Wayne L. Corey and Patricia L. Corey
Name(s) of Signer(s)

personally known to me - OR - proved to me on the basis of satisfactory evidence to be the person(s) whose name(s) is/are subscribed to the within instrument and acknowledged to me that he/she/they executed the same in his/her/their authorized capacity(ies), and that by his/her/their signature(s) on the instrument the person(s), or the entity upon behalf of which the person(s) acted, executed the instrument.

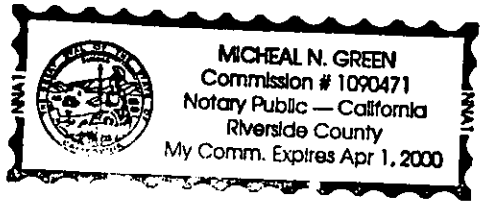

WITNESS my hand and official seal.

Michael N. Green
Signature

OPTIONAL SECTION
CAPACITY CLAIMED BY SIGNER

- () Attorney-in-fact
- () Corporate Officer(s)
- Title _____
- Title _____
- () Guardian/Conservator
- (X) Individual(s)
- () Trustee(s)
- () Other

- () Partner(s)
- () General
- () Limited

The party(ies) executing this document is/are representing:

CERTIFICATE OF ACCEPTANCE
(Government Code Section 27281)

THIS IS TO CERTIFY that the interest in real property conveyed by the within instrument to the City of Riverside, California, a municipal corporation, is hereby accepted by the undersigned officer on behalf of the City Council of said City pursuant to authority conferred by Resolution No. 18233 of said City Council adopted May 11, 1993, and the grantee consents to recordation thereof by its duly authorized officer.

Dated 11/10/97

CITY OF RIVERSIDE
[Signature]
Real Property Services Manager
of the City of Riverside

MONROEB.TPE

APPROVED AS TO FORM
[Signature]
NOTARY PUBLIC

MAGNOLIA

AVENUE

BROADMORE STREET

MONROE STREET

R.L. & I. CO.
M.B. 1/70 S.B. CO.

660'

44'

33'

50'

N 56° E

169.71'

SEE DETAIL

PAR. 8

N 34° W

40'

BROADMORE

55'

1420'

BLOCK 24

MONROE

LOT 1

N 56° E

280.50'

ELY COR.

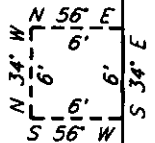

DETAIL
NOT TO SCALE

TRACT No. 18880
M.B. 166/1-2

• CITY OF RIVERSIDE, CALIFORNIA •

THIS PLAT IS SOLELY AN AID IN LOCATING THE PARCEL(S) DESCRIBED IN THE ATTACHED DOCUMENT. IT IS NOT A PART OF THE WRITTEN DESCRIPTION THEREIN.

SHEET 1 OF 1

606-4

SCALE: N.T.S.

DRAWN BY: Kgs

9/8/97

SUBJECT: MONROE STREET IMPROVEMENTS