

561251

When recorded mail to:

City Clerk's Office
City of Riverside
City Hall, 3900 Main Street
Riverside, California 92522

RECEIVED FOR RECORD
AT 8:00 AM
DEC 28 1998

Recorded in Official Records
of Riverside County, California
Recorder
Fees \$

FREE RECORDING
This instrument is for the benefit
of the City of Riverside and is
entitled to be recorded without
fee (Government Code §6103)

FOR RECORDER'S OFFICE USE ONLY

Project: LL-012-989

D- 14303

LW
C
LW

EASEMENT

FOR VALUABLE CONSIDERATION, receipt of which is hereby acknowledged, **JERRY AND TONI WICHITA, husband and wife as joint tenants**, as Grantors, grant to the CITY OF RIVERSIDE, a municipal corporation of the State of California, as Grantee, its successors and assigns, an easement and right-of-way for the construction, reconstruction, maintenance, operation, inspection, repair, replacement, relocation, renewal and removal of **ELECTRICAL ENERGY DISTRIBUTION FACILITIES**, together with all necessary appurtenances, in, under, upon, over and along that certain real property as described in Exhibit "A" attached hereto and incorporated herein by this reference, located in the City of Riverside, County of Riverside, State of California.

TOGETHER WITH the right to clear and keep clear said easement and right-of-way from any structures or trees, to enter upon and to pass and repass over and along said real property, and to deposit tools, implements and other material thereon by Grantee, its officers, agents and employees and by persons under contract with said Grantee and their officers, agents and employees, whenever and wherever necessary for the purpose of constructing,

reconstructing, maintaining, operating, inspecting, repairing, replacing, relocating, renewing
and removing said ELECTRICAL ENERGY DISTRIBUTION FACILITIES.

Dated 12/7/98

Jerry Wichita #
JERRY WICHITA
Toni Wichita
TONI WICHITA

GENERAL ACKNOWLEDGEMENT

State of California }
County of RIVERSIDE } ss

On December 9, 1998 before me Janis Lowry
(date) (name)

a Notary Public in and for said State, personally appeared

Jerry and Todi Wichita
Name(s) of Signer(s)

personally known to me OR proved to me on the basis of satisfactory evidence to be the person(s) whose name(s) is/are subscribed to the within instrument and acknowledged to me that he/she/they executed the same in his/her/their authorized capacity(ies), and that by his/her/their signature(s) on the instrument the person(s), or the entity upon behalf of which the person(s) acted, executed the instrument.

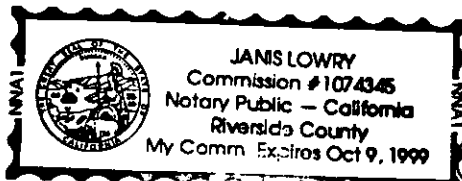

WITNESS my hand and official seal.

Janis Lowry

OPTIONAL SECTION

CAPACITY CLAIMED BY SIGNER

- () Attorney-in-fact
- () Corporate Officer(s)
Title _____
Title _____
- () Guardian/Conservator
- () Individual(s)
- () Trustee(s)
- () Other
- () Partner(s)
() General
() Limited

The party(ies) executing this document is/are representing:

CERTIFICATE OF ACCEPTANCE
(Government Code Section 27281)

THIS IS TO CERTIFY that the interest in real property conveyed by the within instrument to the City of Riverside, California, a municipal corporation, is hereby accepted by the undersigned officer on behalf of the City Council of said City pursuant to authority conferred by Resolution No. 18233 of said City Council adopted May 11, 1993, and the grantee consents to recordation thereof by its duly authorized officer.

Dated 12/8/98

CITY OF RIVERSIDE

[Signature]
Real Property Services Manager
of the City of Riverside

APPROVED AS TO FORM
[Signature]
ASST. CITY ATTORNEY

LL012989.ELE

EXHIBIT A

THAT PORTION OF SECTION 15, TOWNSHIP 3 SOUTH, RANGE 5 WEST, IN THE RANCHO LA SIERRA, CITY OF RIVERSIDE, COUNTY OF RIVERSIDE, STATE OF CALIFORNIA, AS PER MAP OF SECTIONALIZED SURVEY OF SAID RANCHO, RECORDED IN BOOK 6, PAGE 70 OF MAPS, IN THE OFFICE OF THE COUNTY RECORDER OF SAID COUNTY, DESCRIBED AS FOLLOWS:

THAT PORTION OF THAT CERTAIN PARCEL OF LAND AS DESCRIBED IN A QUITCLAIM DEED TO JERRY AND TONI WICHITA DATED AUGUST 28, 1998 AS INSTRUMENT 366260, OFFICIAL RECORDS OF RIVERSIDE COUNTY CALIFORNIA LYING WITHIN A STRIP OF LAND 5 FEET WIDE; THE NORTHERLY LINE OF SAID 5 FOOT STRIP BEING DESCRIBED IN SAID DOCUMENT AS HAVING A BEARING OF NORTH 79° 29' 45" EAST, 161.03 FEET; THE SIDELINES OF SAID 5 FOOT WIDE STRIP BEING EXTENDED OR SHORTENED SO AS TO TERMINATE ON THE EASTERLY AND WESTERLY BOUNDARIES OF SAID PARCEL.

This description was prepared by me or under my direction in conformance with the requirements of the Land Surveyors Act.

Mark S. Brown 12/5/98 Prep. MSB
Mark S. Brown, L.S. 5655 Date
License Expires 9/30/99



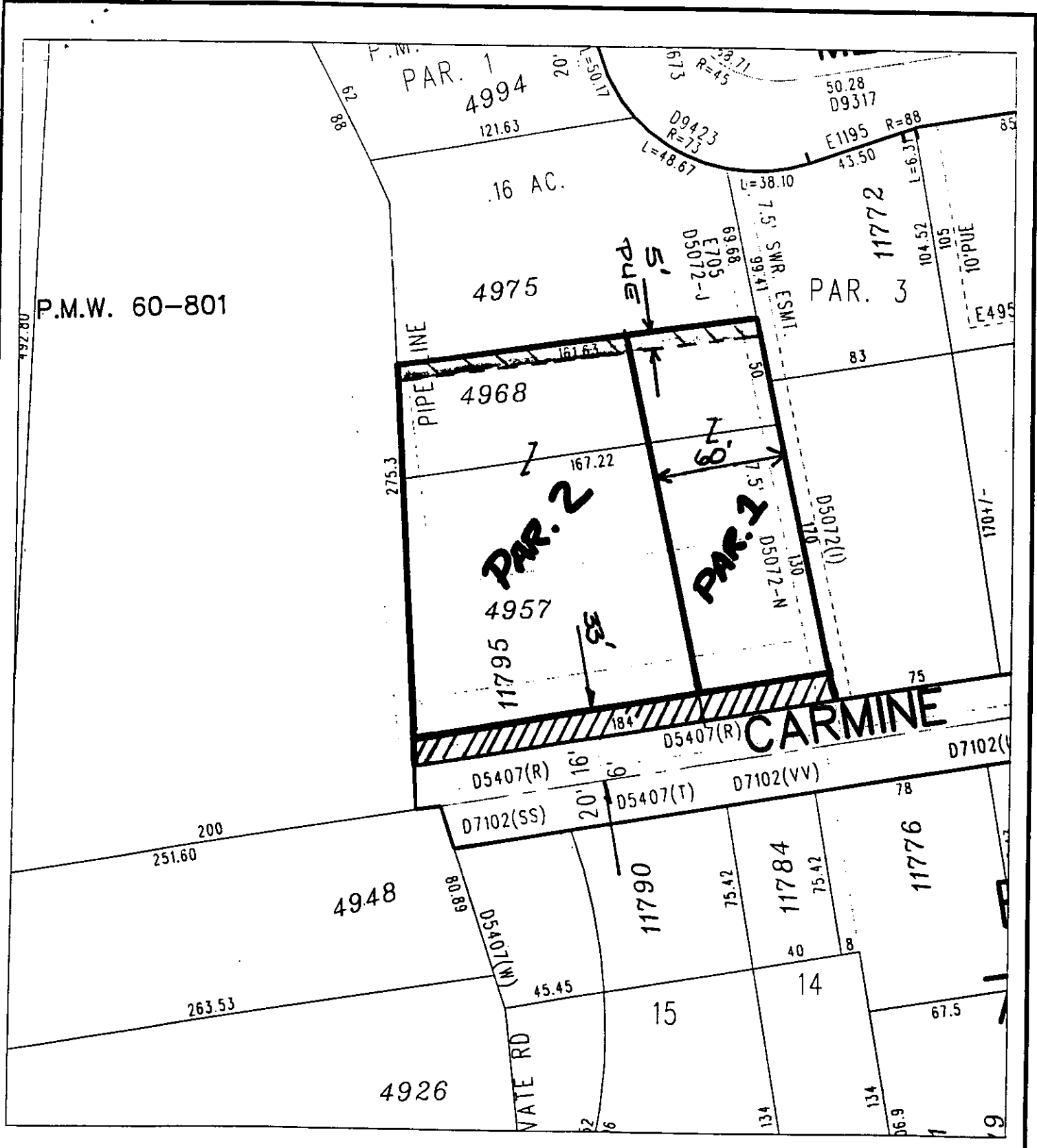

◆ CITY OF RIVERSIDE, CALIFORNIA ◆

63-7

THIS PLAT IS SOLELY AN AID IN LOCATING THE PARCEL(S) DESCRIBED IN THE ATTACHED DOCUMENT. IT IS NOT A PART OF THE WRITTEN DESCRIPTION THEREIN.

Sheet 1 of 1



Scale: 1" = 60'

Drawn by: bmark

Date: 12/04/98

Subject: LL-012-989