

When recorded mail to:

City Clerk's Office
City of Riverside
City Hall, 3900 Main Street
Riverside, California 92522

DOC # 2000-121787
04/03/2000 08:00A Fee:NC
Page 1 of 4
Recorded in Official Records
County of Riverside
Gary L. Orso
Assessor, County Clerk & Recorder

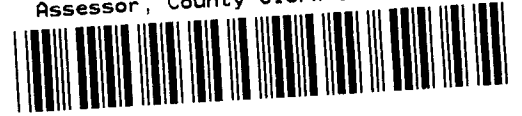

FREE RECORDING

This instrument is for the benefit of the City of Riverside and is entitled to be recorded without fee (Government Code §6103)

Project: 14TH & Sedgwick
A.P.N. 221-110-012

M	S	U	PAGE	SIZE	DA	PCOR	NOCOR	SMF	MISC.
	1		41						
								✓	16
A	R	L			COPY	LONG	REFUND	NCHG	EXAM

GRANT DEED

*TLA 009
DTT &*



The **REDEVELOPMENT AGENCY OF THE CITY OF RIVERSIDE, CALIFORNIA**, a public body, corporate and politic, as Grantor, FOR VALUABLE CONSIDERATION, receipt of which is hereby acknowledged, does hereby grant to the CITY OF RIVERSIDE, a municipal corporation of the State of California, as Grantee, its successors and assigns, the real property located in the City of Riverside, County of Riverside, State of California, described as follows:

Lots 24 and 25 in Block 2 of Jarvis Subdivision, as shown by map on file in Book 5, Page 44 of Maps, records of San Bernardino County, California.

Area - 6,377 square feet, more or less.

This description was prepared by me or under my direction in conformance with the requirements of the Land Surveyors Act.

Mark S. Brown 2/8/03 Prep. Yes
Date

Mark S. Brown, L.S. 5655
License Expires 9/30/03

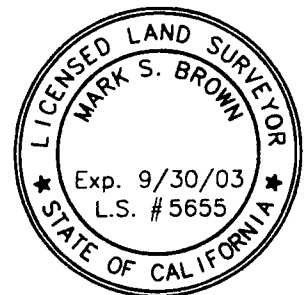

Dated 3/15/00

THE REDEVELOPMENT AGENCY OF THE CITY OF RIVERSIDE, CALIFORNIA, a public body, corporate and politic

By [Signature]
ROBERT C. WALES, Executive Director

GENERAL ACKNOWLEDGEMENT

State of California
County of RIVERSIDE } ss

On MARCH 15, 2000, before me JANIS LOWRY
(date) (name)

a Notary Public in and for said State, personally appeared
ROBERT C. WALES
Name(s) of Signer(s)

personally known to me - OR proved to me on the basis of satisfactory evidence to be the person(s) whose name(s) is/are subscribed to the within instrument and acknowledged to me that he/she/they executed the same in his/her/their authorized capacity(ies), and that by his/her/their signature(s) on the instrument the person(s), or the entity upon behalf of which the person(s) acted, executed the instrument.



WITNESS my hand and official seal.
[Signature]
Signature

OPTIONAL SECTION

CAPACITY CLAIMED BY SIGNER

- () Attorney-in-fact
- () Corporate Officer(s)
Title _____
Title _____
- () Guardian/Conservator
- () Individual(s)
- () Trustee(s)
- () Other
- () Partner(s)
() General
() Limited

The party(ies) executing this document is/are representing:

APPROVED AS TO FORM
[Signature]
ASST. CITY ATTORNEY



2000-121787
04/03/2000 08:00A
2 of 4

**CERTIFICATE OF ACCEPTANCE
(Government Code Section 27281)**

THIS IS TO CERTIFY that the interest in real property conveyed by the within instrument to the City of Riverside, California, a municipal corporation, is hereby accepted by the undersigned officer on behalf of the City Council of said City pursuant to authority conferred by Resolution No. 18233 of said City Council adopted May 11, 1993, and the grantee consents to recordation thereof by its duly authorized officer.

Dated March 21, 2000

CITY OF RIVERSIDE

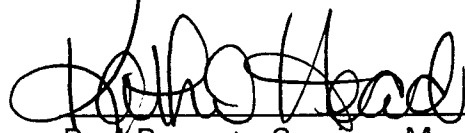

Real Property Services Manager
of the City of Riverside

DEVELOPMENT.DOC



2000-121787
04/03/2000 09:00A
3 of 4

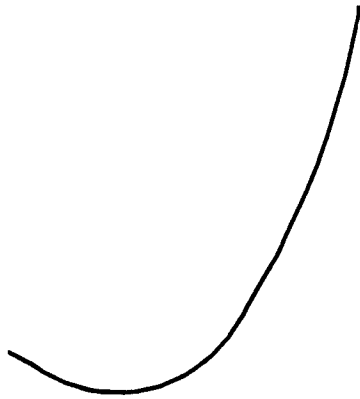

D8167

SEDGWICK AVE

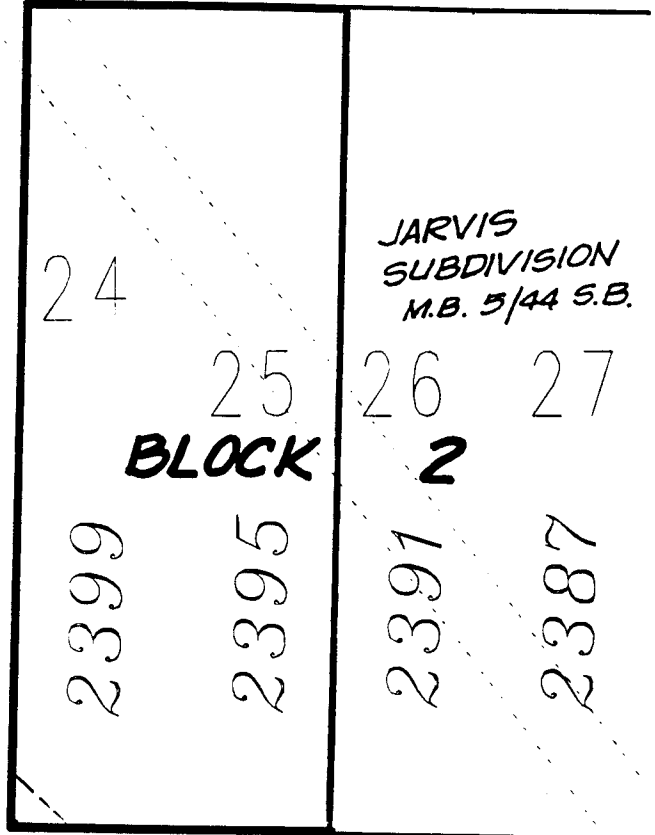

10-1-41
517/2580.R.

GEORGIA ST.

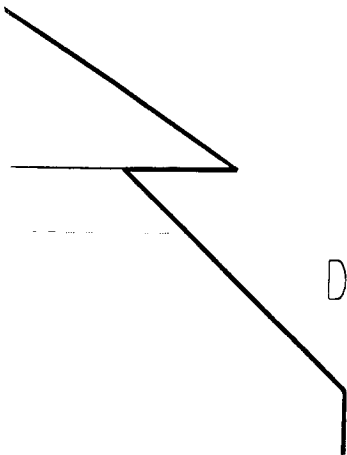

D5387

14TH ST.



2000-121787
04/03/2000 08:08A
4 of 4

◆ CITY OF RIVERSIDE, CALIFORNIA ◆

THIS PLAT IS SOLELY AN AID IN LOCATING THE PARCEL(S) DESCRIBED IN THE ATTACHED DOCUMENT. IT IS NOT A PART OF THE WRITTEN DESCRIPTION THEREIN.

Sheet 1 of 1



Scale: 1" = 30'

Drawn by: sken

Date: 11/08/99

Subject: 14th & SEDGWICK

10-2
14550-4